



Grasmere
Chepstow Road | Langstone | Newport | NP18 2LU

 FINE & COUNTRY

STEP INSIDE

Stepping inside, the property immediately impresses with its sense of space, light and contemporary design. The layout has been thoughtfully arranged to offer both open plan living and defined reception areas, providing flexibility for modern family life. At the heart of the home is a beautifully appointed kitchen and living space, finished to a high specification and ideal for both everyday living and entertaining. Large openings and carefully considered design details create a seamless flow between the principal living areas. The accommodation is well balanced, with multiple reception rooms offering versatility for formal and informal use. Upstairs, the principal bedroom suite provides a private retreat, complete with its own balcony and a refined, modern finish. The remaining bedrooms are generously sized and well presented, supported by stylish and contemporary bathrooms. Throughout the home, there is a clear emphasis on quality, comfort and functionality. Every element has been designed to create a welcoming yet sophisticated living environment.









STEP OUTSIDE

Externally, the property continues to impress, occupying a generous and private gated plot that immediately sets it apart. The landscaped gardens provide a great contemporary setting, with a mix of lawned areas and outdoor seating spaces designed for both relaxation and entertaining. The grounds offer a level of privacy, rarely found in such a well-connected location. A key highlight is the elevated roof terrace, offering a unique vantage point and an ideal space for outdoor dining or evening drinks. The property benefits from ample parking and a strong sense of exclusivity on approach. The outdoor space has been carefully considered to complement the internal accommodation, allowing for a seamless indoor-outdoor lifestyle. Whether hosting guests or enjoying quiet family time, the gardens provide versatility throughout the seasons. The gated setting enhances both security and privacy, making it ideal for families. Overall, the external offering matches the quality and scale of the home itself.

Area Description

Langstone is widely regarded as one of Newport's most desirable residential areas, offering a unique balance of semi-rural surroundings and exceptional connectivity. Situated less than a mile from Junction 24 of the M4, the area is particularly popular with commuters, providing easy access to Bristol, Cardiff and beyond. The nearby Celtic Manor Resort is a major lifestyle draw, offering world class golf, leisure and dining facilities within minutes of the property. Langstone itself retains a village feel, with a strong sense of community and a reputation for being one of the more affluent areas within Newport. The surrounding landscape is characterised by rolling countryside and woodland, while still being close to the city centre. Excellent transport links include nearby rail services from Newport, connecting to London and major UK cities. The area is also well served by local amenities, schools and business hubs, making it ideal for both families and professionals. This combination of lifestyle, location and accessibility continues to make Langstone a highly sought after place to live.

Directions

What3words | [///giggle.classics.pollution](https://www.what3words.com/#!/giggle.classics.pollution) | <https://w3w.co/giggle.classics.pollution>



Grasmere Chepstow Road, Langstone, Newport, Gwent
Approximate Gross Internal Area
Main House = 1816 Sq Ft/169 Sq M
Outbuilding = 119 Sq Ft/11 Sq M
Total = 1935 Sq Ft/180 Sq M

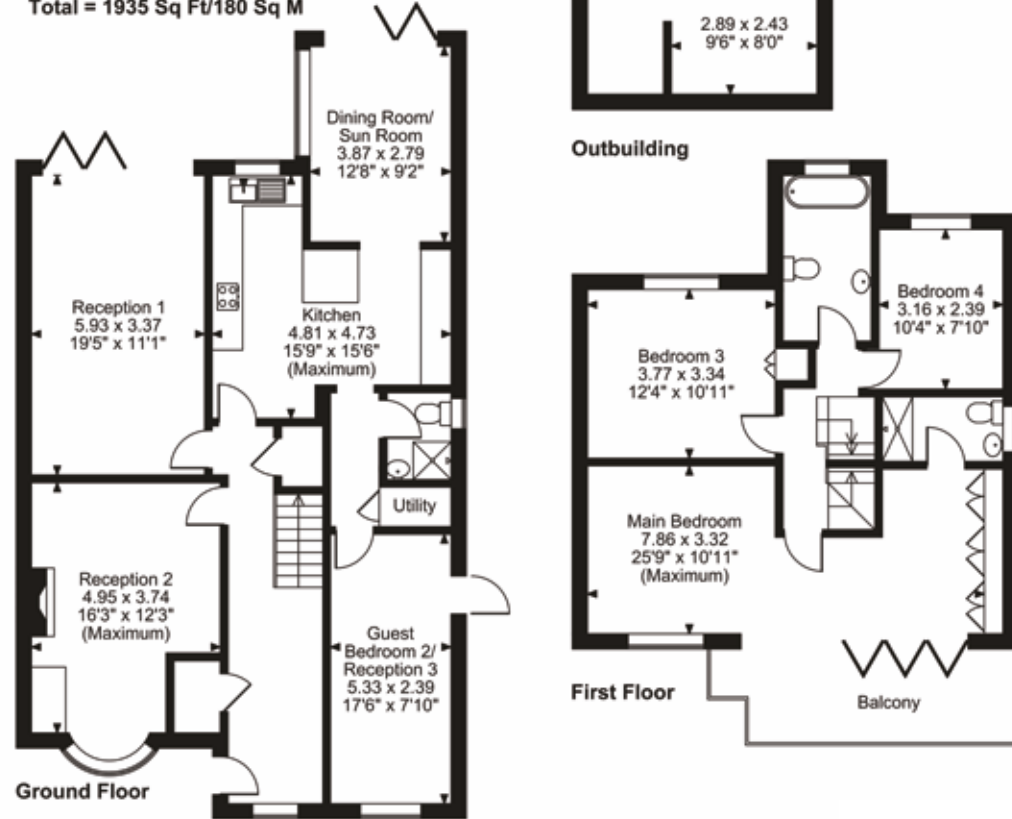

FOR ILLUSTRATIVE PURPOSES ONLY - NOT TO SCALE

The position & size of doors, windows, appliances and other features are approximate only.

© ehoush. Unauthorised reproduction prohibited. Drawing ref. dig/8688374/CNR

EPC TBC

Follow Fine & Country on



Fine & Country Cardiff and Newport
Sophia House, 28 Cathedral Road, Cardiff, CF11 9LJ
029 2169 0690 | cardiff@fineandcountry.com

