



Woodlands Heights, Vanbrugh Hill, Blackheath SE3 7EL



Woodlands Heights, Blackheath SE3

Leasehold (980 years remaining)

A thoughtfully designed apartment in Woodlands Heights on Vanbrugh Hill, offering modern living with allocated parking. Perfectly positioned between Blackheath's village charm and Greenwich's cultural attractions, with excellent transport links.

Key Features

- One Bedroom, One Bathroom
- 2nd Floor
- Communal grounds
- Council Tax: **D**
- Service Charge: **£3,675 P/A**
- Ground Rent: **£200 P/A**
- Popular location
- EPC: **B**

Nestled on the leafy slopes of Vanbrugh Hill, this 1920's period building with historic relevance in the area as originally part of Greenwich hospital, offers a contemporary one-bedroom apartment with amazing views of the London skyline and over the communal grounds and has a blend of modern comfort and excellent connectivity in one of southeast London's most distinguished residential areas.

The apartment benefits from a thoughtful layout across 505 square feet, delivering efficient modern living space with good natural light. The inclusion of allocated off-street parking adds considerable practical value in this sought-after locale, whilst the communal garden provides a pleasant outdoor retreat for residents.

The location places you between two of London's finest green spaces. Blackheath's expansive heath offers year-round recreational opportunities, from weekend kite-flying to summer fairs, whilst Greenwich Park's manicured grounds and historic Royal Observatory sit just moments away.









Woodland Heights

Approximate Gross Internal Area = 51.0 sq m / 548.8 sq ft

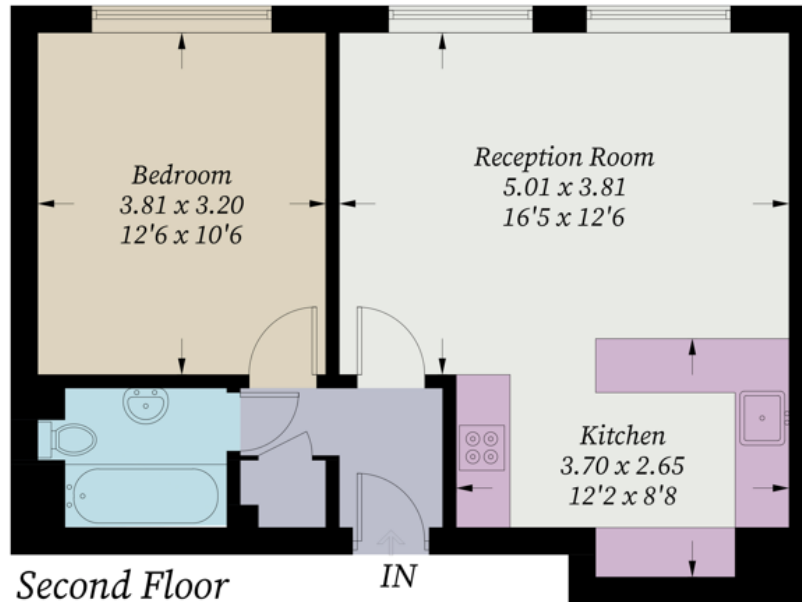

Illustration for identification purposes only, measurements are approximate, not to scale. Fourlabs.co © (ID1288887)

22 College Approach, Greenwich,
London, SE10 9HY
Tel: 020 7399 5595

Sales, Lettings & Property Management

residential.jll.co.uk

