



JAKE FARRELL
exp
FOR SALE
01225 941146
SCAN ME BELOW

Somerset Crescent, Melksham, SN12
Melksham

Offers in the Region of
£225,000

Recently refurbished three bedroom home within easy access to the town centre. Available with NO ONWARD CHAIN. Presented as a blank canvass ready for you to just move in, enjoy and make it your own.

- REF: JF0657
- NO ONWARD CHAIN
- Recently Refurbished
- Three Bedrooms
- Close to local amenities
- Brand New Kitchen
- Presented as a blank canvass to make it your own
- Walking distance to Melksham Town Centre



Recently refurbished three bedroom home within easy access to the town centre. Available with NO ONWARD CHAIN. Presented as a blank canvass ready for you to just move in and enjoy.

This property has just been renovated and is presented as a blank canvass. This property would be great for first time buyers, upsizing and all alike. There is also further potential to make the property your own.

Recent work completed includes a new kitchen, new bathroom, carpets, redecorated, new fences, new combi boiler which is now in the loft.

The property briefly comprises of an entrance hall. Open plan lounge diner. Brand new kitchen. Utility room just off from the kitchen with also it's own front door.

On the first floor you will find three bedrooms, two of which are doubles. The refurbished bathroom with separate WC.

Externally to the front is the driveway. To the rear is mainly laid to lawn with a patio area.

Please note: The property is of steel frame construction, the property is mortgageable.

Melksham is a thriving town, comprises of local businesses in the high street mixed in with some larger, national brands. There is a train station. Local park with canal paths nearby. There are plenty of supermarket options in the town, Iceland, Waitrose and Asda are all within easy access. Melksham has Melksham Oak which is a popular secondary school along with primary schools. Melksham is a good place to commute from if you need easy access to the A350. Well located for commuting to the M4 and outbound.



Council Tax Band: B

Tenure: Freehold

Property Type: Terraced House

Bedrooms: 3

Bathrooms: 1

Receptions: 1

Bedrooms: 3 | Bathrooms: 1 | Receptions: 1

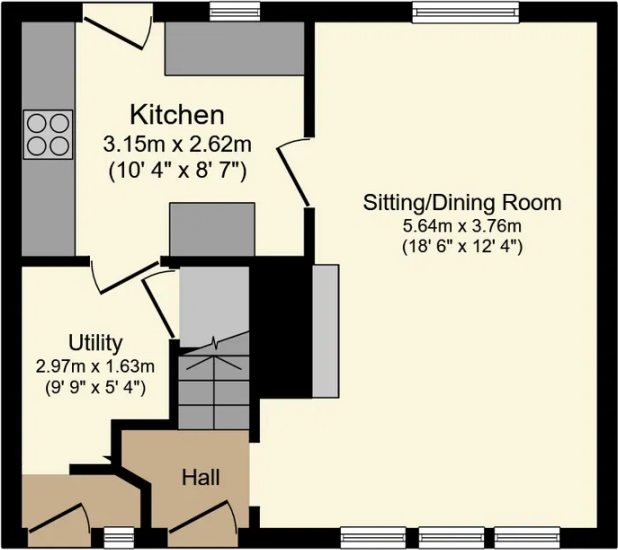

Ground Floor

Floor area 36.1 m² (388 sq.ft.)

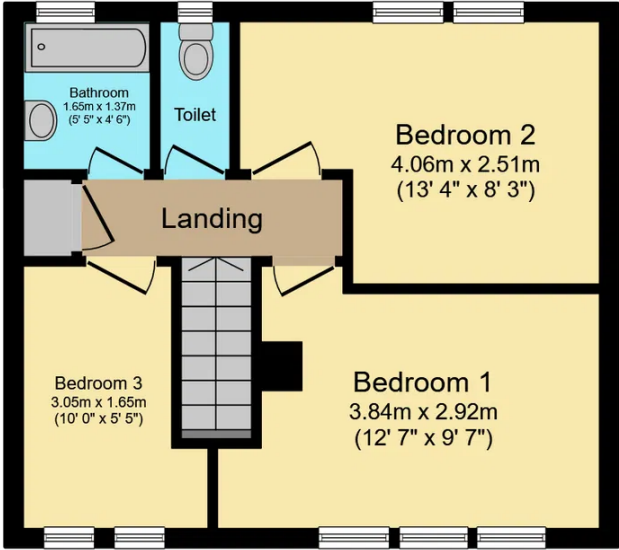

First Floor

Floor area 52.1 m² (560 sq.ft.)

TOTAL: 88.1 m² (949 sq.ft.)

This floor plan is for illustrative purposes only. It is not drawn to scale. Any measurements, floor areas (including any total floor area), openings and orientations are approximate. No details are guaranteed, they cannot be relied upon for any purpose and do not form any part of any agreement. No liability is taken for any error, omission or misstatement. A party must rely upon its own inspection(s). Powered by www.Propertybox.io