



33 Honeysuckle Close

Calne, SN11 9TE

Guide Price £290,000

Welcome to Honeysuckle Close, a family home within half a mile from Fynamore Primary School (rated good by Ofsted).

The ground floor accommodation comprises entrance hall, lounge with under stairs cupboard, cloakroom and kitchen dining room with patio doors onto the rear garden. The first floor accommodation comprises landing with airing cupboard, main bedroom and en-suite shower room, a second double bedroom, a single bedroom and a family bathroom with a shower over the bath.

The property further benefits from upvc double glazing, gas central heating (combination boiler), an enclosed rear garden with access from the garage, a single garage with power and lighting and parking.

All room measurements are approx;
 Lounge: 2.86m ext 3.62m x 2.84m ext 4.21m
 Kitchen Dining Room: 4.6m x 2.46m ext 3.43m
 Cloakroom: 2.07m x 1m
 Bedroom One: 2.53m x 3.08m ext 4.09m
 Bedroom Two: 2.99m x 2.63m
 Bedroom Three: 2.63m x 2.02m

- Three bedroom family home
- Enclosed rear garden
- Garage & driveway parking
- Gas central heating
- EPC - C
- Council Tax - C (Wiltshire Council)

Viewing

Please contact our Blueleaf Property Office on 01225 839050 if you wish to arrange a viewing appointment for this property or require further information.

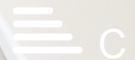

Floor Plan

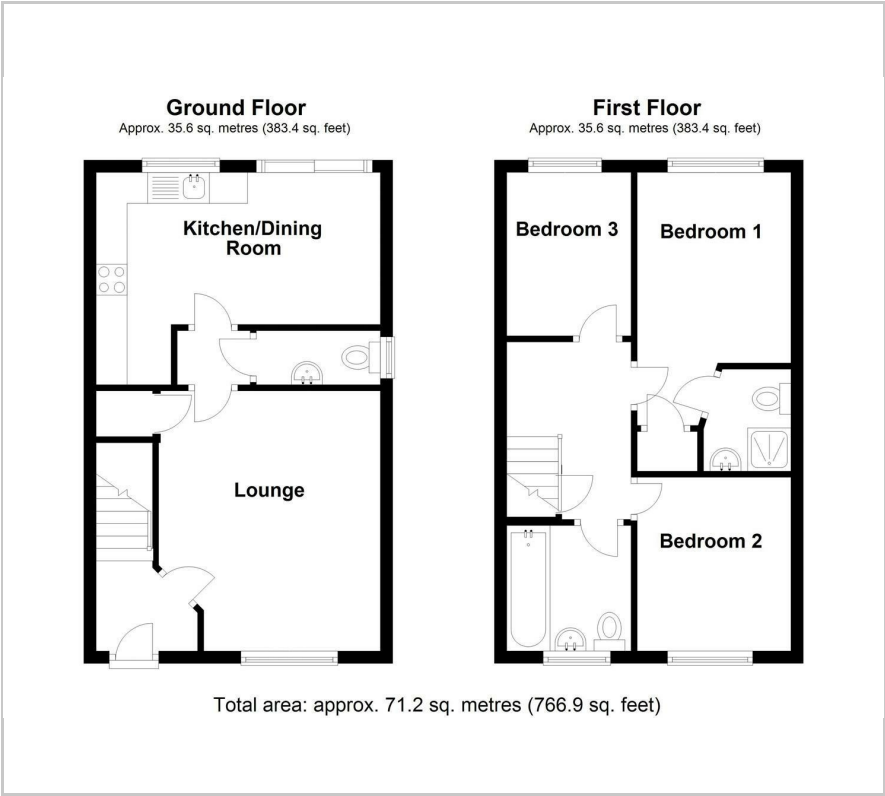

Area Map

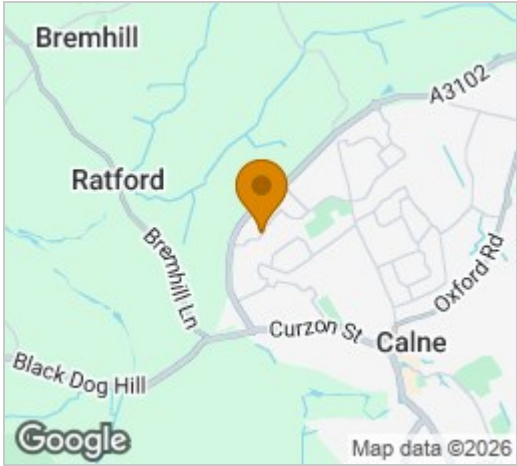

Energy Efficiency Graph

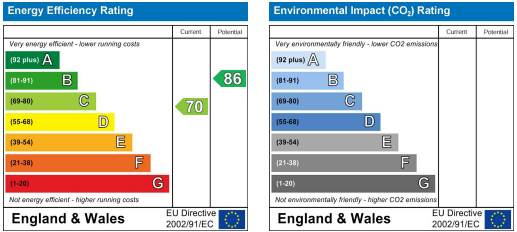

These particulars, whilst believed to be accurate are set out as a general outline only for guidance and do not constitute any part of an offer or contract. Intending purchasers should not rely on them as statements of representation of fact, but must satisfy themselves by inspection or otherwise as to their accuracy. No person in this firms employment has the authority to make or give any representation or warranty in respect of the property.