



# ASPIRE

— TO MOVE —



## Magdalena Court, Bristol, BS1

Video & Physical Viewings Available. One bedroom, flat located just 0.3 miles from Bristol Temple Meads. Ideally suited to a single professional or couple. Available to rent now.

Magdalena Court is located in the Redcliffe area of Bristol, very close to Bristol Temple Meads. Also situated only 0.5 miles away from Queen Square and surrounding amenities, including bars, pubs restaurants and shops.

- Available Immediately
- Only 0.3 miles from Temple Meads
- EPC Rating D
- Council Tax Band C
- Allocated Parking
- Holding Deposit - £282.00 - one weeks worth of rent.
- One bedroom flat
- Second Floor

**£1,225 PCM**

GROUND FLOOR  
645 sq.ft. (59.9 sq.m.) approx.

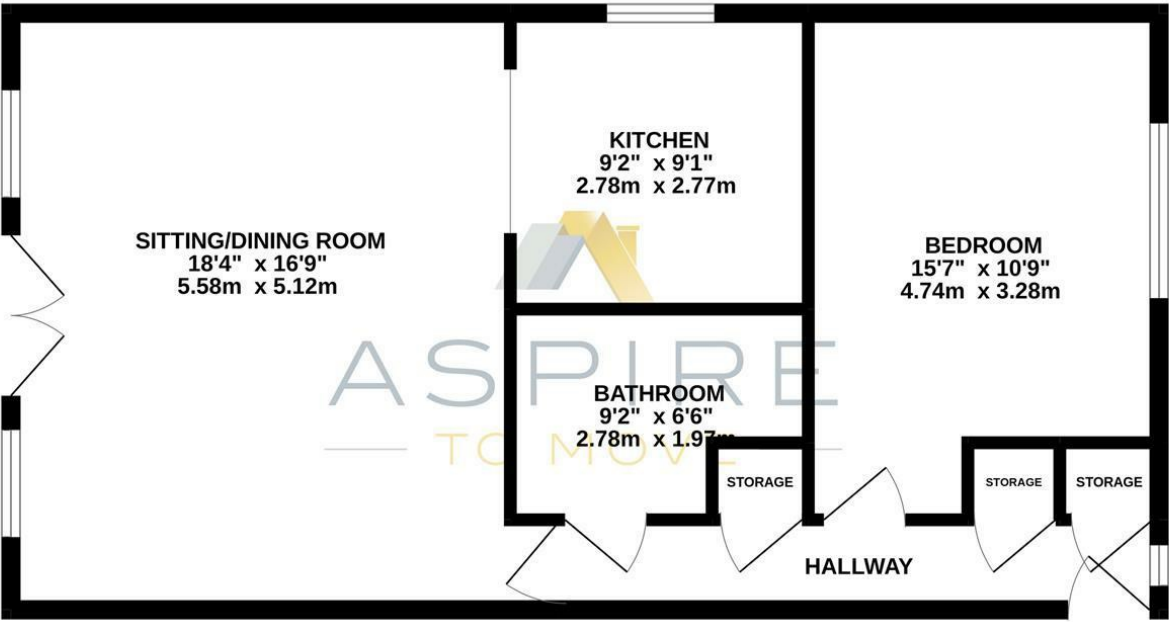

TOTAL FLOOR AREA : 645 sq.ft. (59.9 sq.m.) approx.

Whilst every attempt has been made to ensure the accuracy of the floorplan contained here, measurements of doors, windows, rooms and any other items are approximate and no responsibility is taken for any error, omission or mis-statement. This plan is for illustrative purposes only and should be used as such by any prospective purchaser. The services, systems and appliances shown have not been tested and no guarantee as to their operability or efficiency can be given.

Made with Metropix ©2022

Energy Performance Graph

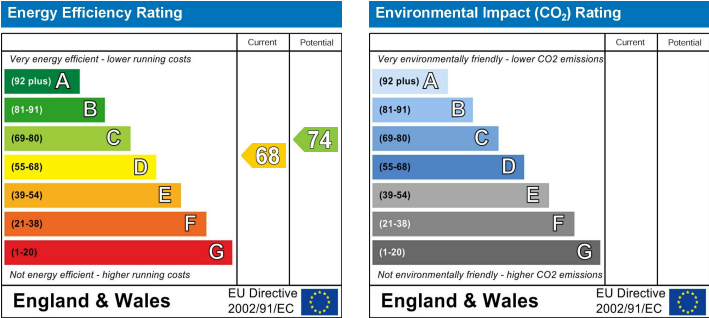

These particulars, whilst believed to be accurate are set out as a general outline only for guidance and do not constitute any part of an offer or contract. Intending purchasers should not rely on them as statements of representation of fact, but must satisfy themselves by inspection or otherwise as to their accuracy. No person in this firms employment has the authority to make or give any representation or warranty in respect of the property.