

W WHITES

RESIDENTIAL ESTATE AGENTS
PROPERTY LETTING & MANAGING AGENTS
VALUERS & PROPERTY CONSULTANTS
CHARTERED SURVEYORS

01722 336422
www.hwwhite.co.uk WEB



The Cottages, Lower Street

£1,250 PCM

5 The Cottages, Lower Street, Salisbury, Wiltshire, SP2 8HB



Energy Efficiency Rating		Current	Potential
Very energy efficient - lower running costs			
(92 plus) A			
(81-91) B			
(69-80) C		73	74
(55-68) D			
(39-54) E			
(21-38) F			
(1-20) G			
Not energy efficient - higher running costs			
England & Wales		EU Directive 2002/91/EC	

A charming two/three bedroom terraced house situated in a sought after location a short distance from the town path and therefore accessible to the town centre and railway station. The well presented accommodation comprises lounge with exposed wall beams, feature ornamental fire place, kitchen with range of units, built in electric oven and electric hob, freestanding fridge, washing machine, under stairs cupboard. Window to rear, door to rear hallway with access to outside and door to WC with basin and WC. To the first floor is Bedroom one, with window to front, exposed wall beams, feature ornamental fire pace, bedroom two with window to rear, cupboard housing gas fired combination boiler, door to en suite shower room, with modern suite of WC basin, large shower cubicle with thermostatic shower unit. From bedroom two, door to lobby and stairs to second floor opening into bedroom three, with Velux window.

Outsi
store.

uilt

The p

Ground Floor
Approx. 30.5 sq. metres (328.6 sq. feet)

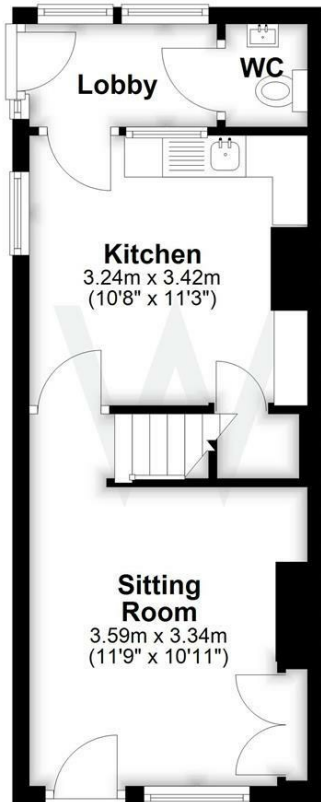

First Floor
Approx. 29.3 sq. metres (315.4 sq. feet)

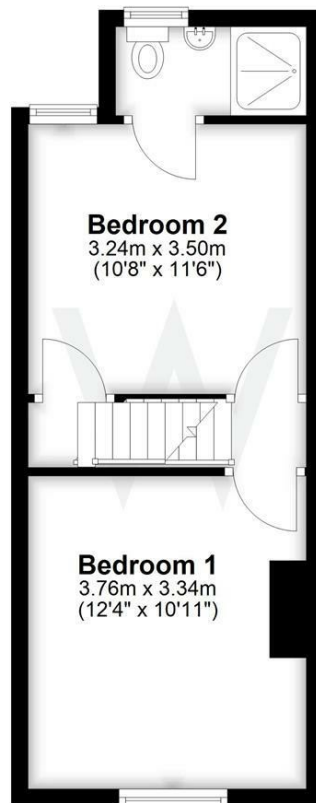

Second Floor
Approx. 17.3 sq. metres (186.2 sq. feet)

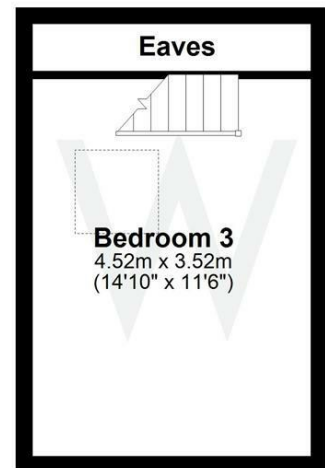

Total area: approx. 77.1 sq. metres (830.2 sq. feet)



01722 336422

47 Castle Street, Salisbury SP1 3SP 01722 320600 FAX
residential-sales@hwwhite.co.uk E.MAIL www.hwwhite.co.uk WEB