

Ist Call

SALES AND LETTINGS



Hartington Road, Southend On Sea, SS1 2HR

£150,000 - Leasehold

1-bed flat just yards from seafront, no chain! 14'4" lounge, double bed, shared garden. Double glazing, gas central heating. Newly extended lease included. Perfect first-time buy or investment. Must view!

Positioned just yards from the stunning seafront and offered with no onward chain, this charming one-bedroom first floor apartment presents an excellent opportunity in a highly desirable coastal location.

The well-presented accommodation features a generous 14'4" front lounge that creates a bright and welcoming living space, complemented by a comfortable double bedroom, practical kitchen, and modern bathroom. Quality is evident throughout with double-glazed windows ensuring peaceful living and efficient gas central heating providing reliable year-round warmth. A particular benefit is access to a shared rear garden - a delightful outdoor space perfect for relaxation and enjoying the coastal atmosphere without the maintenance responsibilities of sole ownership. Significantly, the lease will be extended, ensuring excellent long-term security and eliminating any mortgage lending concerns. This makes the property particularly attractive to both owner-occupiers and investors alike. The combination of prime seafront location, quality presentation, extended lease, and chain-free sale makes this an exceptional opportunity for first-time buyers seeking coastal living or investors looking for a property with strong rental appeal in this sought-after area. Viewing recommended to appreciate the quality, location, and investment potential this delightful seafront apartment offers.

Accommodation Comprising

Own front door accessed via front stairwell and leading to...

Lounge 14'7 into bay x 13'3 (4.45m into bay x 4.04m)



Double glazed bay window to front, radiator, coved ceiling, opening to...



Inner Hallway

Radiator, storage area, laminate wood flooring, coved ceiling, doors off to...

Bedroom 12'2 x 7'6 (3.71m x 2.29m)



Double glazed window to rear, radiator, coved ceiling...

Bathroom 7'4 x 5'4 (2.24m x 1.63m)



Modern white suite comprising panelled bath with mixer tap and shower attachment, pedestal wash hand basin, low level W.C., radiator, tiled splashbacks, extractor fan, coved ceiling, obscure double glazed window to rear...

Kitchen 13'4 x 5'6 (4.06m x 1.68m)



Range of modern fitted base units with toning roll edged working surfaces over, inset single drainer stainless steel sink unit, gas cooker, space and plumbing for washing machine, matching range of wall mounted units, wall mounted gas central heating & hot water boiler, tiled splashbacks, radiator, double glazed window to rear...

Externally

Rear Garden



Shared rear garden accessed via side of property...

Parking

The property is situated within a residents permit parking zone and an annual permit can be obtained from Southend City Council for a cost of £18.50 allowing you to park within any of the designated bays within the street...

Agents Note

We understand that the seller will extend the lease as part of the sales process providing over 100 year term with no Ground Rent payable...

Floor Plan

FIRST FLOOR
391 sq.ft. (36.3 sq.m.) approx.

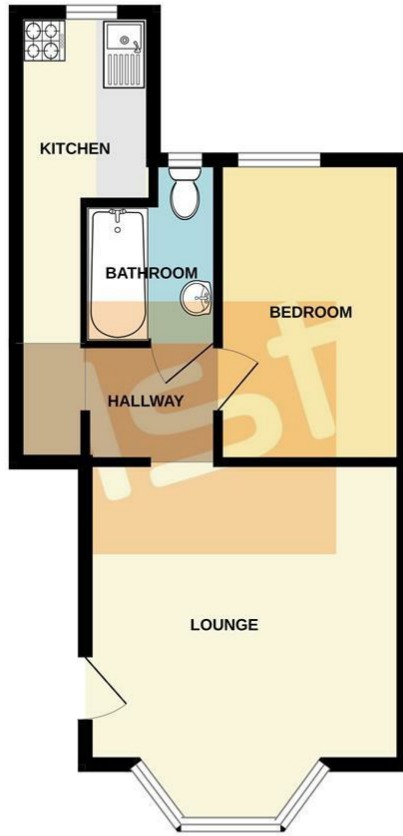

TOTAL FLOOR AREA: 391 sq.ft. (36.3 sq.m.) approx.

Whilst every attempt has been made to ensure the accuracy of the floorplan contained here, measurements of doors, windows, rooms and any other items are approximate and no responsibility is taken for any error, omission or mis-statement. This plan is for illustrative purposes only and should be used as such by any prospective purchaser. The services, systems and appliances shown have not been tested and no guarantee as to their operability or efficiency can be given.
Made with Metropix ©2025

Area Map

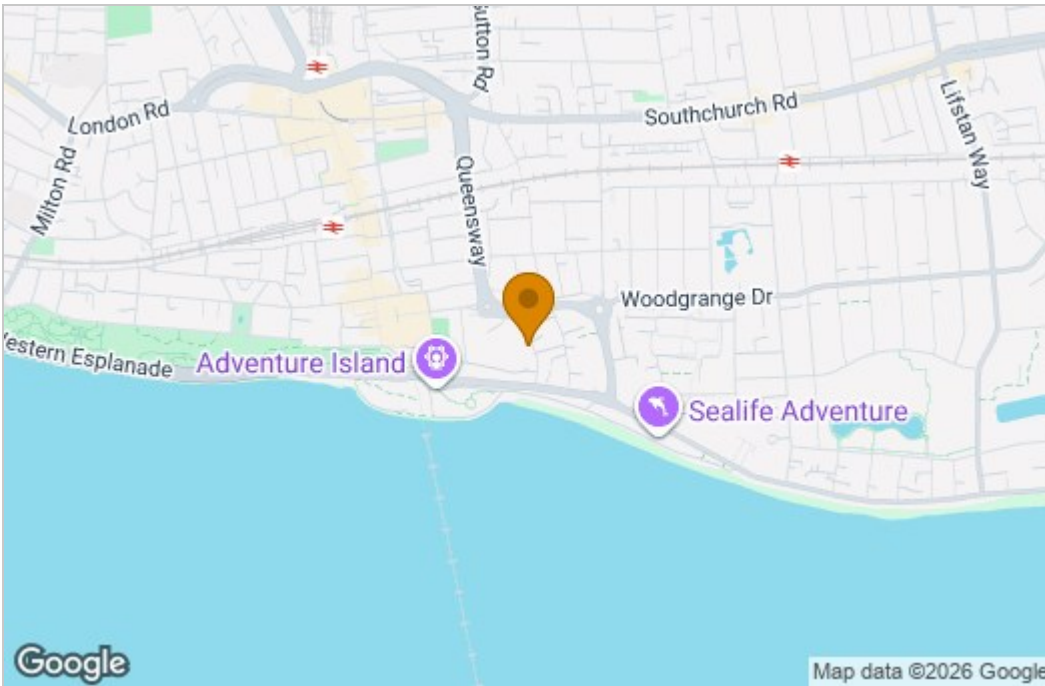

Energy Efficiency Graph

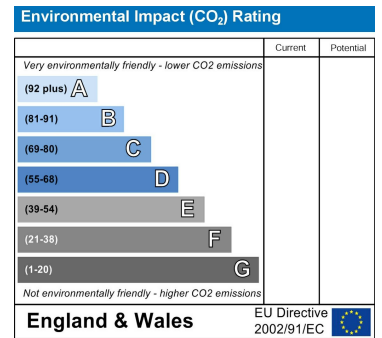
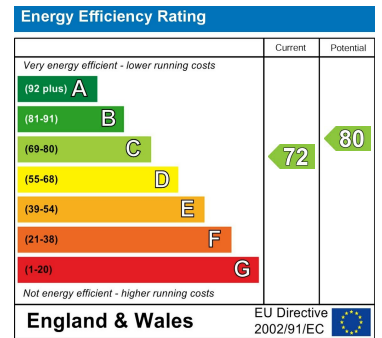

These particulars, whilst believed to be accurate are set out as a general outline only for guidance and do not constitute any part of an offer or contract. Intending purchasers should not rely on them as statements of representation of fact, but must satisfy themselves by inspection or otherwise as to their accuracy. No person in this firm's employment has the authority to make or give any representation or warranty in respect of the property.