



North Side Wandsworth Common
Wandsworth, SW18





Situated just a stone's throw from the picturesque Wandsworth Common and the vibrant hub of Clapham Junction, this spacious and well presented 2 two bedroom period garden flat offers over 1,300 sq. ft. of living space, blending classic charm with contemporary style.

The property is set within a characterful period building and boasts impressive tall ceilings and large sash windows creating a sense of light and space throughout.

The well appointed kitchen is fully equipped with modern appliances and offers ample storage, while large doors open directly onto the private garden ideal for alfresco dining and summer entertaining.

Both bedrooms are comfortable doubles with built in storage. The main bedroom has direct access to the garden as well as an en-suite.

Both double bedrooms are generously sized, with the master benefiting from plenty of built-in storage and the second bedroom offering versatility for guests, home office use, or a nursery. A contemporary family bathroom completes the flat, with high-end fixtures and fittings.

Located just a short walk from the green expanses of Wandsworth Common and the excellent transport links at Clapham Junction & Wandsworth Town, this home offers the perfect balance urban convenience. With a host of local cafes, shops, and restaurants just moments away, this is a must see property for anyone looking for a spacious, period home in a highly sought after location.

- Over 1,300 sq. ft.
- Private garden
- Chain free
- Wandsworth Common 0.1 miles
- Clapham Junction station 0.6 miles
- Wandsworth Town station 0.6 miles

Asking Price £850,000

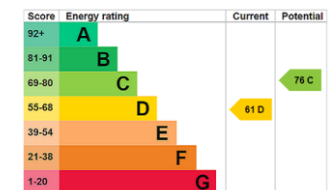

Tenure: Share of Freehold 965 years remaining

Service Charge: £1200 per annum

Local Authority: London Borough of Wandsworth

Council Tax Band: C

Chestertons Wandsworth Sales

47 East Hill

London

SW18 2QE

wandsworth@chestertons.co.uk

0208 104 7530

chestertons.co.uk

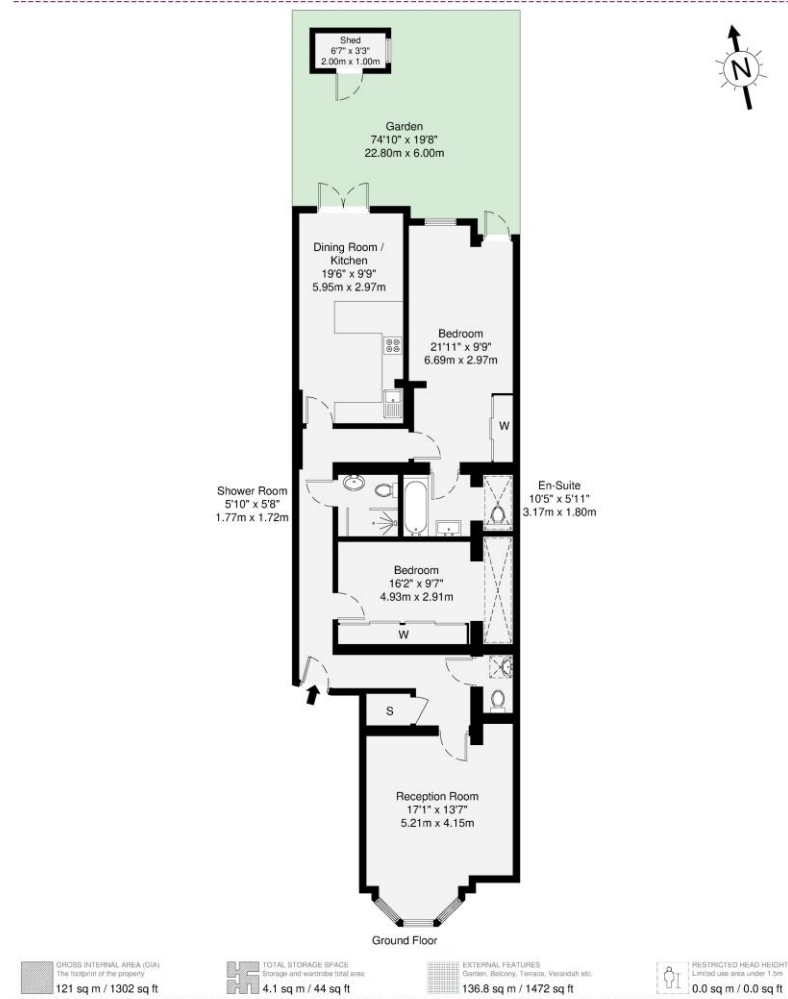

Disclaimer : Floorplan measurements are approximate and are for illustrative purposes only. While we do not doubt the floorplan accuracy and completeness, you or your advisors should conduct a careful, independent investigation of the property in respect of monetary valuation.

Maison
VUE