



Luscombe Maye

Since 1873

# Ringmore Drive, Bigbury On Sea, TQ7

4 3 1



## DESCRIPTION

Set in a sought-after plot within Bigbury-On-Sea, Broadwater offers a modern four bedroom detached bungalow with panoramic sea views from Hope Cove across to Plymouth with Burgh Island and Bigbury Beach in the centre. The property lies within a short walk of Bigbury Beach and is the perfect property for those who love coastal walks and water sports.

This outstanding detached bungalow has been tastefully modernised throughout to offer a modern and contemporary living space focused towards the breath-taking sea views. The kitchen has been finished to the highest of standards with a range of fitted units, high quality appliances and large island. Wooden floors flow through to the open plan dining/living area with unrivalled panoramic sea views, French doors leading to a large, private terrace and a log burner offering a cosy feel. To the rear of the kitchen is a well-equipped utility room with an integral door to the single garage, access to the rear garden and a shower room, ideal when returning from the beach. The entrance hall provides ample storage for shoes and coats also and there is also a fully tiled wetsuit store cupboard equipped with Pulleymaid, heating and drainage.

The separate sitting room, or fourth double bedroom, is a generous space with double doors to the front garden terrace. There are three further double bedrooms, all naturally light and bright, with the master enjoying access to the raised decking, views towards Burgh Island hotel and an ensuite with a double shower cubicle. There is also a family bathroom with freestanding bath, separate shower, vanity hand basin and WC.

The immaculate, modern finishes continue outside the property where the current owners have created an idyllic garden to enjoy throughout the year. With a range of terraces, elevated decking and lawned area, the garden has been designed so the sun can be enjoyed throughout the day as well as the breath-taking views. To the rear of the property is a further garden area with access to the home office and outside storage. The property also offers three driveway parking spaces and a single garage.



Broadwater, Ringmore Drive, Bigbury on Sea, TQ7 4AU

Approximate Gross Internal Floor Area = 199.2 sq m / 2037 sq ft  
 Outbuilding Area = 16.0 sq m / 173 sq ft  
 Total Area = 205.2 sq m / 2209 sq ft

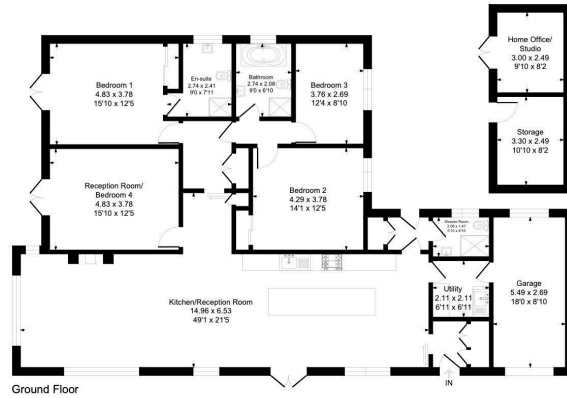
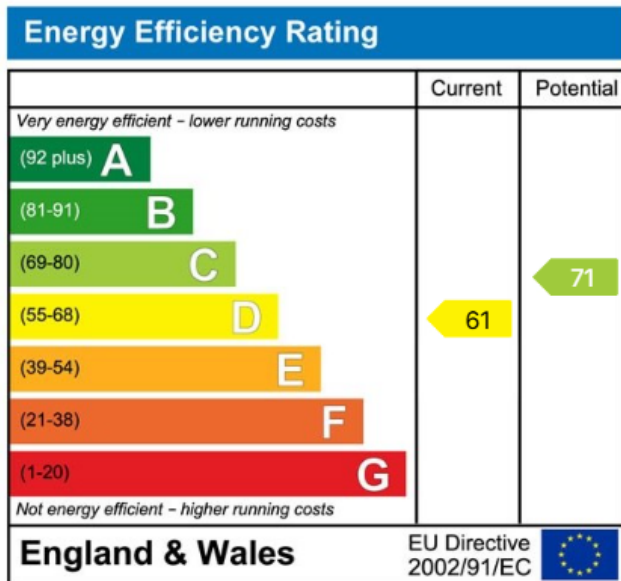
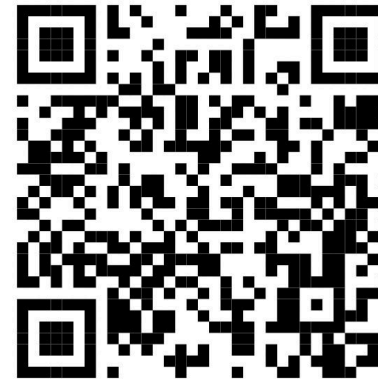

Illustration for identification purposes only, measurements are approximate, not to scale.

- Four Bedroom Detached Property
- Finished to the Highest of Standards
- Panoramic Sea Views
- Walking Distance to Bigbury Beach
- Driveway Parking and Single Garage
- Spacious Accommodation
- Landscaped Garden
- Home Office
- Renovated Throughout
- Popular Coastal Village Location



Luscombe Maye  
 Since 1873



Use the QR code for further "Material Information" about this home

Luscombe Maye  
 Since 1873

**Modbury:**  
 3 Church Street, Modbury, Ivybridge PL21 0QW  
 01548 830831  
 modbury@luscombemaye.com  
[www.luscombemaye.com](http://www.luscombemaye.com)

Important Notice: Luscombe Maye gives notice that: 1. These particulars do not constitute an offer or contract or part thereof. 2. All descriptions, photographs and plans are for guidance only and should not be relied upon as statements or representations of fact. All measurements are approximate and not necessarily to scale. Any prospective purchaser must satisfy themselves of the correctness of the information within the particulars by inspection or otherwise. 3. Luscombe Maye does not have any authority to give any representations or warranties whatsoever in relation to this property (including but not limited to planning/building regulations), nor can it enter into any contract on behalf of the Vendor.