



CHURCH LANE, SW19

£185,000

Retirement Flat
First Floor
One Bedroom
Private Balcony
Communal Gardens
EPC rating - awaiting

@marshandparsons
marshandparsons.co.uk

MARSH &
PARSONS



ABOUT THE PROPERTY

Retirement flat for over 60s. Surrounded by well kept communal gardens, this first floor apartment is neutrally decorated throughout, receives plenty of natural light and has a private balcony off the reception. There is a galley style kitchen and good size double bedroom with fitted wardrobes served by a shower room/WC. Additional communal facilities include two communal lounges, laundry room and parking facilities. Andridge Court is situated within the Merton Park conservation area within close proximity to Wimbledon town centre offering an array of shops, bars, restaurants and leisure facilities. Wimbledon Station provides frequent rail links via the District Line and Mainline to Waterloo.



STEP INSIDE CHURCH LANE

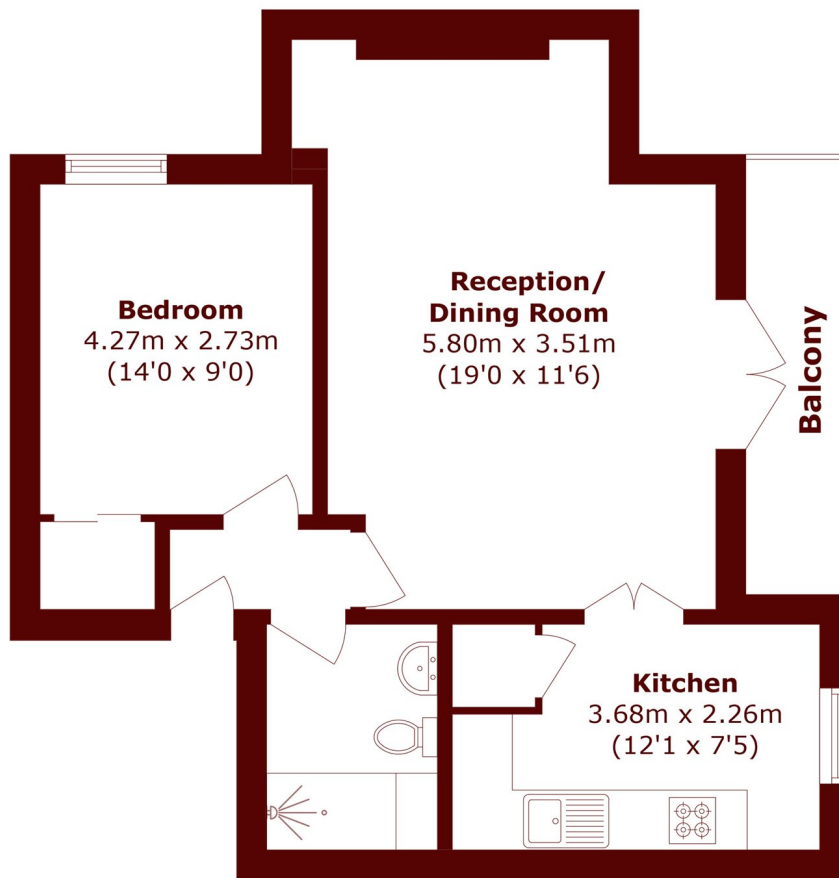

Total area (approx.): 46.6 sq. m (501.6 sq. ft)

Balcony area (approx.): 4.2 sq. m (45.2 sq. ft)

Wimbledon
020 8879 6660

Energy Rating: D We aim to make our particulars both accurate and reliable. However, they are not guaranteed; nor do they form part of an offer or contract. If you require clarification on any points then please contact us, especially if you're traveling some distance to view. Please note that appliances and heating systems have not been tested and therefore no warranties can be given as to their good working order

MARSH &
PARSONS