



## SHOOT UP HILL, NW2

£2,000 pcm

A spacious two-bedroom apartment set within the popular Mapesbury Court mansion block, ideally located just moments from the amenities of Kilburn High Road and within easy reach of the cafés, restaurants and bars of West Hampstead.

- Spacious two-bedroom
- Popular mansion block
- Separate kitchen
- Moments from Kilburn High Road

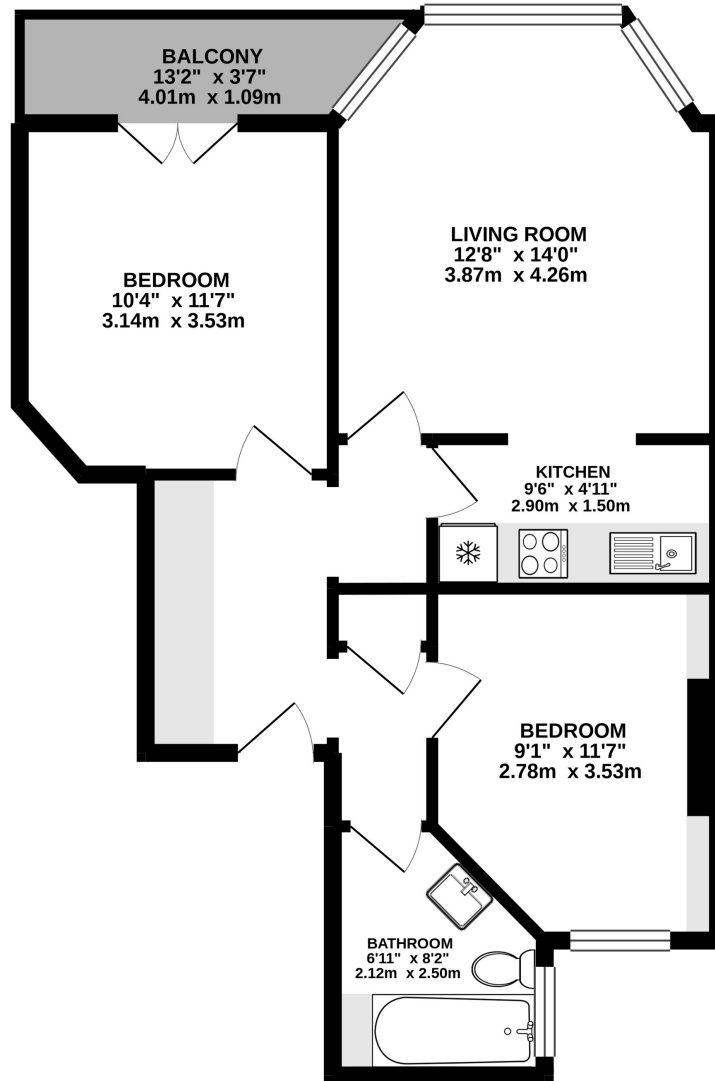

TOTAL FLOOR AREA : 576 sq.ft. (53.5 sq.m.) approx.

Whilst every attempt has been made to ensure the accuracy of the floorplan contained here, measurements of doors, windows, rooms and any other items are approximate and no responsibility is taken for any error, omission or mis-statement. This plan is for illustrative purposes only and should be used as such by any prospective purchaser. The services, systems and appliances shown have not been tested and no guarantee as to their operability or efficiency can be given.  
Made with Metropix ©2020

**LiFE RESIDENTIAL**

11 Flagstaff House, London,  
SW8 2LZ  
Sales: 020 7476 1408  
Lettings: 020 7582 7989

Energy Rating: C. We aim to make our particulars both accurate and reliable. However they are not guaranteed; nor do they form part of an offer or contract. If you require clarification on any points then please contact us, especially if you're traveling some distance to view. Please note that appliances and heating systems have not been tested and therefore no warranties can be given as to their good working order.