

shepherds  
A better home  
moving experience



28 Elder Court  
Hertford, SG13 7GD

Guide Price £270,000





## 28 Elder Court

Hertford, SG13 7GD

Just a stone's throw away from the charming Hartham Common, countryside and river walks, residents also enjoy easy access to the nearby upgraded Hartham leisure centre. A modern two-bedroom apartment situated in a sought-after and convenient location near Hertford East train station and the town centre. Boasting a spacious open-plan living room/kitchen area measuring 22' x 20', it also features modern amenities including a sleek newly fitted bathroom and the added advantage of a secure parking space in the gated underground car park.







- Two bedroom apartment
  - Close to Hertford East station and town centre
  - Third floor with lift access
  - Gated secure underground parking
  - Open plan kitchen/living room with refitted kitchen
  - Moments from Hartham Common and leisure centre
  - Newly fitted bathroom
- Leasehold: 125 years from 2009  
Ground Rent: £700 per annum  
Service Charge: £1850 per annum





Floor Plan

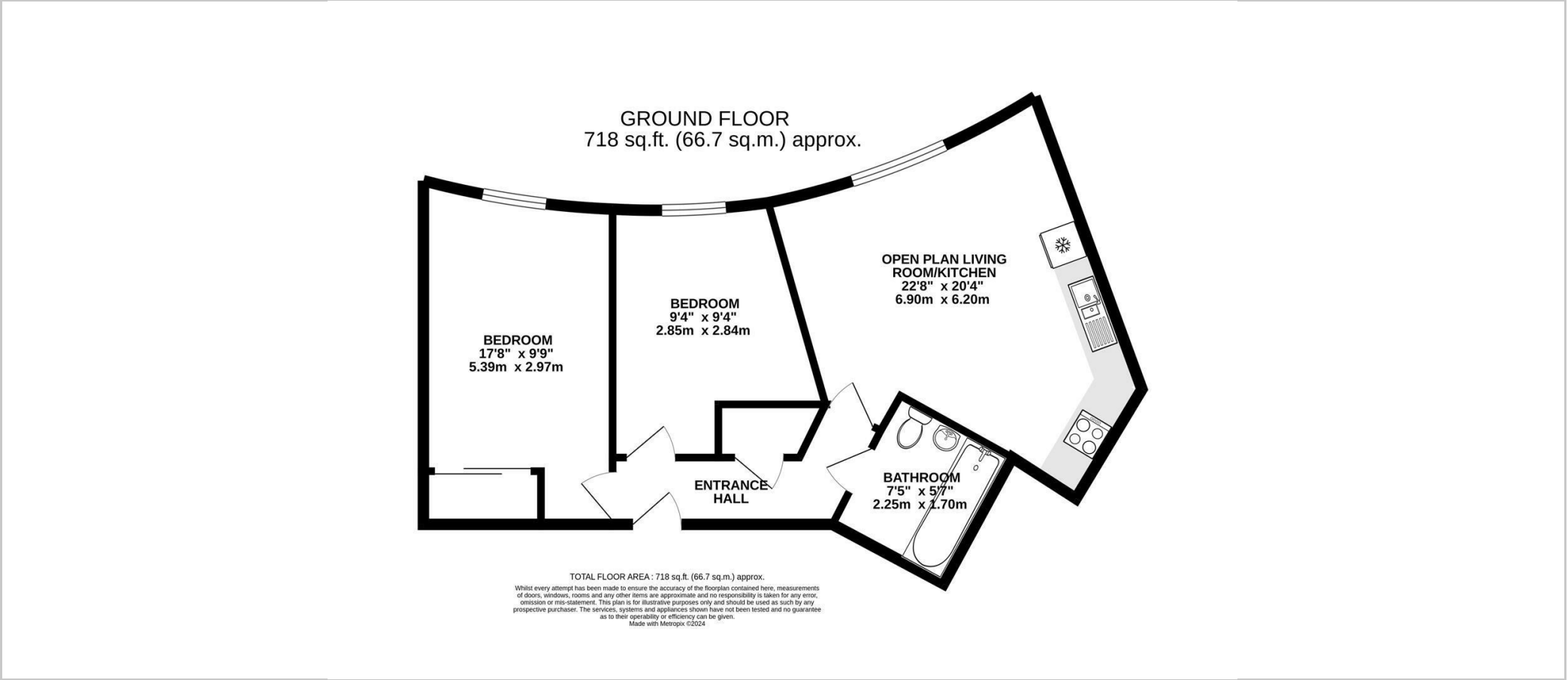

Viewing

Please contact Shepherds of Hertford on 01992 551955 if you wish to arrange a viewing appointment for this property or require further information.

Energy Performance Graph

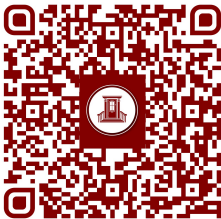
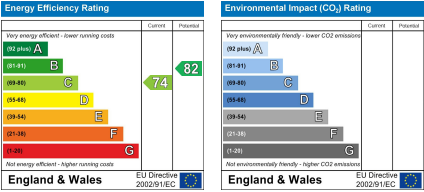

These particulars, whilst believed to be accurate are set out as a general outline only for guidance and do not constitute any part of an offer or contract. Intending purchasers should not rely on them as statements of representation of fact, but must satisfy themselves by inspection or otherwise as to their accuracy. No person in this firm's employment has the authority to make or give any representation or warranty in respect of the property.

Riverside House, 6 Millbridge, Hertford, SG14 1PY  
Tel: 01992 551955 Email: enquiries@shepherdsofhertford.co.uk