



Enfields Hythe
3 Marsh Parade,
Hythe Southampton
Hampshire, SO45 6AN
023 8084 9210
sales-hythe@enfields.co.uk

Flat 1, 74, Oakley Road,
Guide Price £165,000

🛏 2 🚿 1 🚿 1



- Two-bedroom ground floor apartment
- Bright and airy with ample natural light
- Neutral décor with potential to modernise
- Double glazing throughout
- Close to schools, parks, shops and hospital
- Generous room sizes throughout
- Separate kitchen
- Built-in wardrobe in the main bedroom
- Off-road parking space and garage included
- Currently tenanted



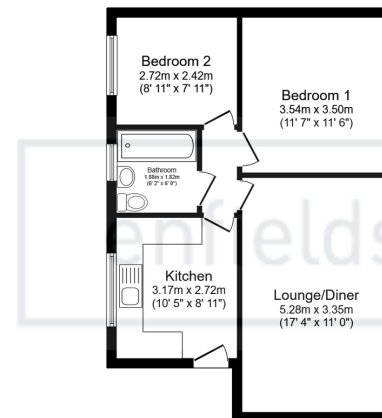

Floor Plan

Floor area 51.4 sq.m. (553 sq.ft.)

Total floor area: 51.4 sq.m. (553 sq.ft.)

This floor plan is for illustrative purposes only. It is not drawn to scale. Any measurements, floor areas (including any total floor area), openings and orientations are approximate. No details are guaranteed, they cannot be relied upon for any purpose and do not form any part of any agreement. No liability is taken for any error, omission or misstatement. A party must rely upon its own inspection(s). Powered by www.Propertybox.io

enfields

A well-proportioned two-bedroom ground floor apartment offering generous living space, off-road parking and excellent natural light throughout. Conveniently located close to local schools, amenities and Southampton General Hospital.

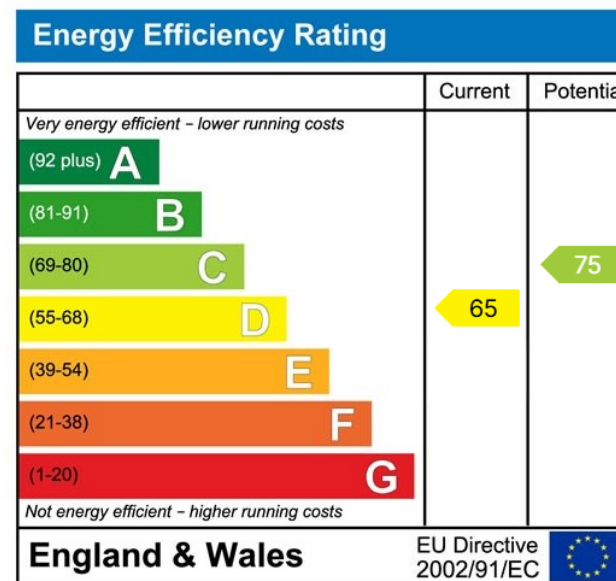

www.enfields-southampton.co.uk



It is Enfields policy to respect any sole agency currently in force and we would not be able to commence marketing until this has expired or been terminated. If you fail to terminate any previous agreement you could be liable for two sets of fees. Enfields Hythe is a trading name of YTF LTD Registered office: 345 Shirley Road, Southampton, Hampshire, England, SO15 3JD. Company Registration No: 10459987. VAT Registration No: 281 2975 81.

Enfields Lettings - Embley Management LTD T/A Enfields. Registered Address: 345 Shirley Road, Southampton, Hampshire, England, SO15 3JD. Company Registration No: 14847604. VAT Registration No: 439 8546 45.