

KEYSTONE



Bramford Road, Ipswich, IP1 2GL

£725 PCM

- One bedroom flat
- Fitted kitchen with appliances
- Bathroom with shower
- Close to town centre
- Lounge
- Electric heating
- Entrance hall
- Built in wardrobe
- PARKING

GROUND FLOOR
434 sq.ft. (40.3 sq.m.) approx.

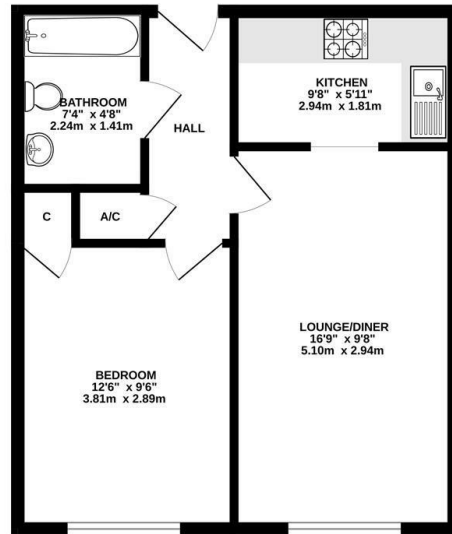

TOTAL FLOOR AREA: 434 sq.ft. (40.3 sq.m.) approx.
While every effort has been made to ensure the accuracy of the foregoing contained floor measurements, of doors, windows, rooms and any other items are approximate and no responsibility is taken for any error, omission or misstatement. This plan is for illustrative purposes only and should be used as a guide only for prospective purchasers. The services, systems and appliances shown have not been tested and no guarantee as to their operation or efficiency can be given.
Made with Metronom 02/2025

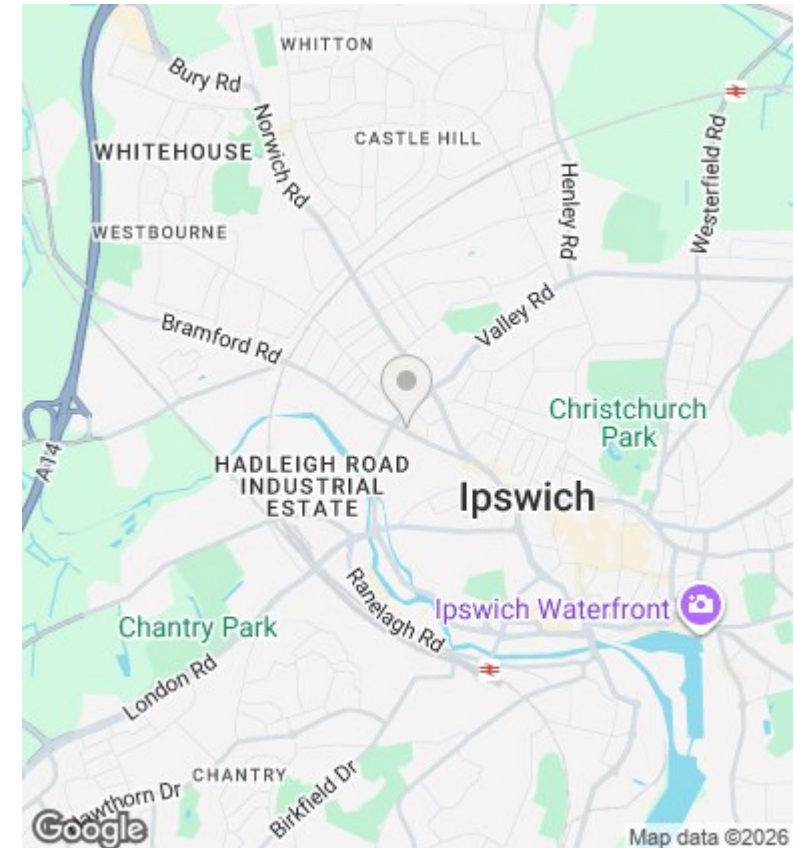

Directions

Viewings

Viewings by arrangement only. Call 01473 221 399 to make an appointment.

EPC Rating:
C

Energy Efficiency Rating		
	Current	Potential
Very energy efficient - lower running costs		
(92 plus) A		
(81-91) B		84
(69-80) C	72	
(55-68) D		
(39-54) E		
(21-38) F		
(1-20) G		
Not energy efficient - higher running costs		
England & Wales		EU Directive 2002/91/EC