



**Eleanor Walk, Woburn, Milton Keynes, MK17 9QY**

## **Welcome to**

### **Eleanor Walk, Woburn Milton Keynes**

Situated in the desirable location of Woburn, this well-presented ground floor bungalow offers comfortable and practical living throughout.

#### **Hallway**

Carpeted, Electric Heater, Smoke Alarm, Ceiling Lights, Loft Hatch (with Ladder/Partly Boarded)

#### **Airing Cupboard**

Hot Water Tank, Storage Shelves Above

#### **Lounge/Diner**

15' 1" x 10' 7" (4.60m x 3.23m)

Carpeted, Electric Heater, Electric Fireplace, Sliding Patio Doors leading to the Rear Garden

#### **Kitchen**

7' 9" x 6' 2" (2.36m x 1.88m)

Hard Flooring, Electric Hob (4 rings), Fridge/Freezer, Washing Machine, Pantry Storage Cupboard (fuse box), Window to the Front Aspect

#### **Bedroom One**

11' 9" x 9' 9" (3.58m x 2.97m)

Carpeted, Electric Heater, 2 Windows to the Front Aspect

#### **Bedroom Two**

8' 7" max x 8' 6" max (2.62m max x 2.59m max)

Carpeted, Electric Heater, Window to the Rear Aspect

#### **Bathroom**

Hard Flooring, WC, Wash Hand Basin, Large Shower Cubicle, Extractor Fan, Heated Towel Rail, Storage Underneath

#### **Rear Garden**

Patio Section (Part of the Title), Grass Area (Shared & Maintained by the Management Company)

#### **Agent Note**

Management/Service Charges - £300 per month.  
Covers outside maintenance and buildings insurance.





**View this property online** [williamhbrown.co.uk/Property/BFD105594](http://williamhbrown.co.uk/Property/BFD105594)



## Welcome to

### Eleanor Walk, Woburn, Milton Keynes

- Ground Floor Bungalow
- Two Bedrooms
- Desirable Location of Woburn
- Electric Fireplace
- Loft Hatch with Ladder

Tenure: Freehold EPC Rating: E  
Council Tax Band: C

# £275,000

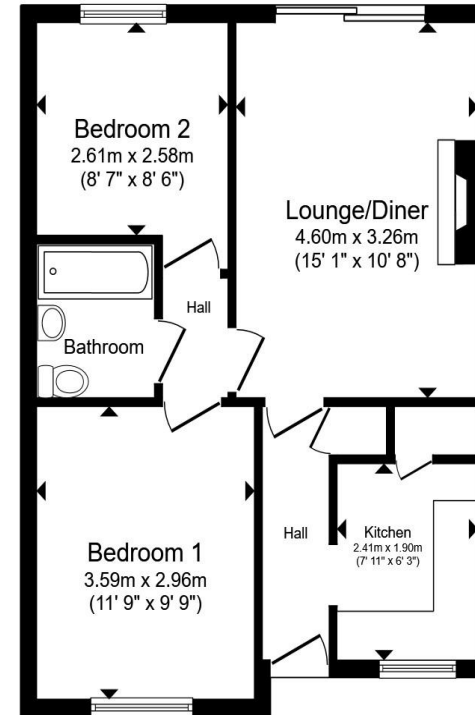

Ground Floor

Total floor area 47.8 m<sup>2</sup> (514 sq.ft.) approx

This floor plan is for illustrative purposes only. It is not drawn to scale. Any measurements, floor areas (including any total floor area), openings and orientation are approximate. No details are guaranteed, they cannot be relied upon for any purpose and they do not form part of any agreement. No liability is taken for any error, omission or misstatement. A party must rely upon its own inspection(s). Powered by [www.propertybox.io](http://www.propertybox.io)



**View this property online** [williamhbrown.co.uk/Property/BFD105594](http://williamhbrown.co.uk/Property/BFD105594)



Property Ref:  
BFD105594 - 0002

1. MONEY LAUNDERING REGULATIONS Intending purchasers will be asked to produce identification documentation at a later stage and we would ask for your co-operation in order that there is no delay in agreeing the sale. 2. These particulars do not constitute part or all an offer or contract. 3. The measurements indicated are supplied for guidance only and as such must be considered incorrect. Potential buyers are advised to recheck measurements before committing to any expense. 4. We have not tested any apparatus, equipment, fixtures or services and it is in the buyers' interest to check the working condition of any appliances. 5. Where an EPC, or a Home Report (Scotland only) is held for this property, it is available for inspection at the branch by appointment. If you require a printed version of a Home Report, you will need to pay a reasonable production charge reflecting printing and other costs. 6. We cannot offer an opinion either written or verbal on the content of these reports and this must be obtained from your legal representative. 7. Whilst we take care in preparing these reports, a buyer should ensure that his/her legal representative confirms as soon as possible all matters relating to title including the extent and boundaries of the property and other important matters before exchange of contracts.

William H Brown is a trading name of Sequence (UK) Limited which is registered in England and Wales under company number 4268443, Registered Office is Cumbria House, 16-20 Hockliffe Street, Leighton Buzzard, Bedfordshire, LU7 1GN. VAT Registration Number is 500 2481 05.

  
william h brown



**01234 268367**



[bedford@williamhbrown.co.uk](mailto:bedford@williamhbrown.co.uk)



40 Allhallows, BEDFORD, Bedfordshire, MK40 1LN



[williamhbrown.co.uk](http://williamhbrown.co.uk)