



# ASPIRE

— TO MOVE —



## Portland Place, Bath, BA1

Video and physical viewings available. Two bedroom basement flat with a delightful rear courtyard. Offered unfurnished and available now.

The apartment enjoys an enviable position in Portland Place, one of Bath's most elegant Georgian terraces, situated on the sought-after northern slopes of the city. Just a short walk from the independent shops and cafés of Julian Road and within easy reach of Bath city centre, the property offers excellent access to a wide range of cultural, leisure and shopping amenities.

Spa railway station provides direct links to London Paddington and Bristol and Portland Place enjoys convenient road access to the M4 and surrounding countryside.

**£1,595 PCM**

# Portland Place, Bath, BA1

- Video and physical viewings available
- Available now
- Council tax band C
- 2 bedroom apartment
- Courtyard garden
- Unfurnished
- Holding deposit: £368

Video and physical viewings available. Two bedroom basement flat with a delightful rear courtyard. Offered unfurnished and available now.

The apartment enjoys an enviable position in Portland Place, one of Bath's most elegant Georgian terraces, situated on the sought-after northern slopes of the city. Just a short walk from the independent shops and cafés of Julian Road and within easy reach of Bath city centre, the property offers excellent access to a wide range of cultural, leisure and shopping amenities.

Spa railway station provides direct links to London Paddington and Bristol and Portland Place enjoys convenient road access to the M4 and surrounding countryside.

Steps lead down to the private entrance with an entrance hallway. The generous living room, with its rich oak flooring and striking feature fireplace, creates a sophisticated space for both relaxing and entertaining. There are two bedrooms, both of which have working shutters and one of which has a built in wardrobe and feature fireplace. There is a kitchen to the rear with base and wall units, double oven, hob, undercounter fridge and washing machine. A half glazed door leads out onto a private enclosed courtyard and provides a rare haven - ideal for al fresco dining, quiet mornings with a coffee, or evening gatherings with friends.

The property would best suit a professional couple and is available now.

Council tax band C: £2066.91

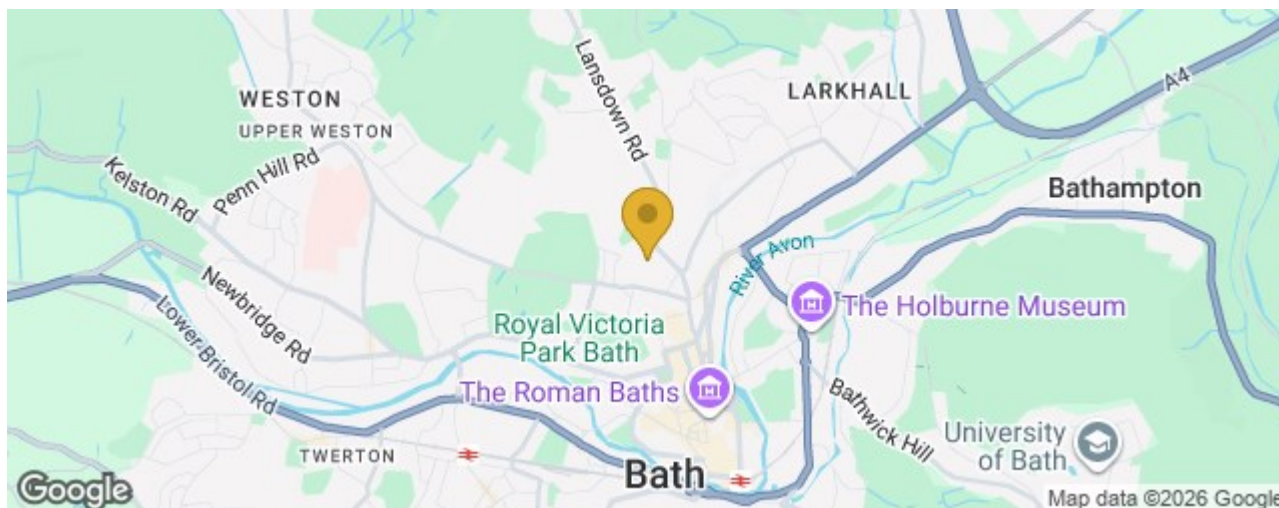



BASEMENT FLOOR  
742 sq.ft. (69.0 sq.m.) approx.

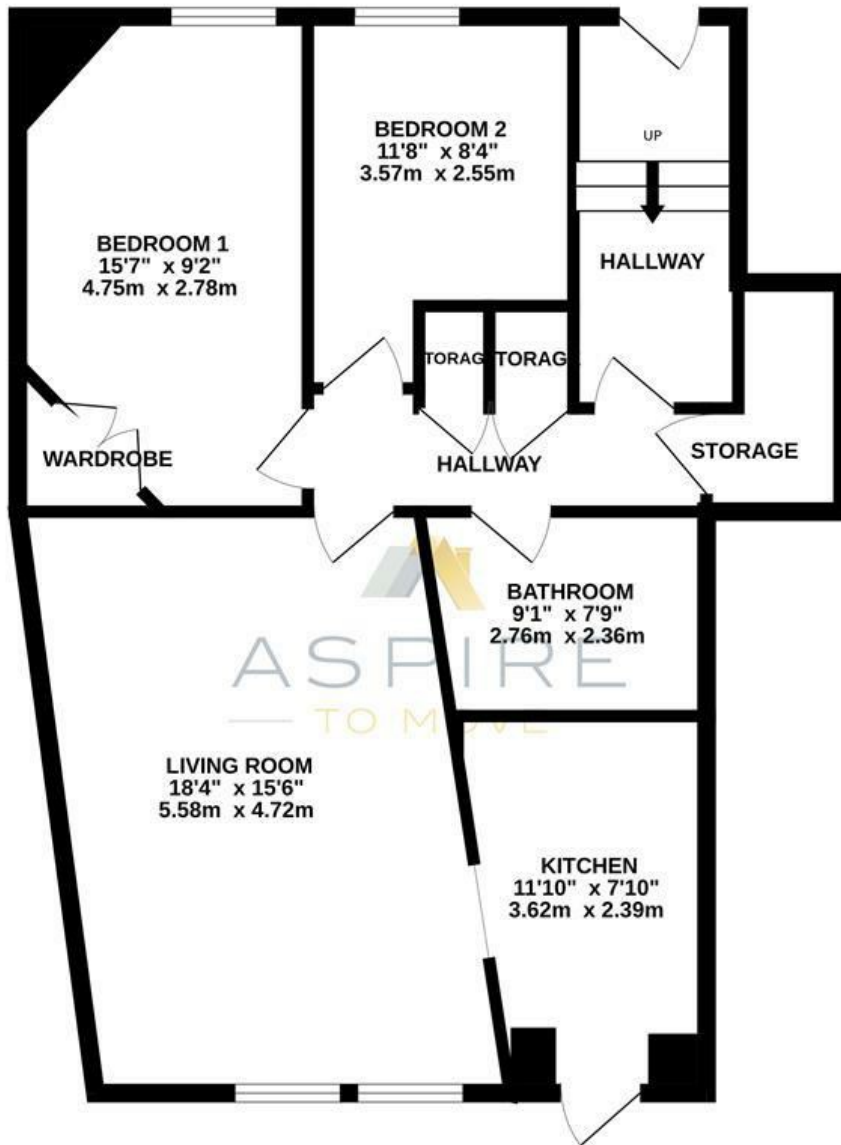

PORTLAND PLACE, BATH, BA1

TOTAL FLOOR AREA : 742 sq.ft. (69.0 sq.m.) approx.

Whilst every attempt has been made to ensure the accuracy of the floorplan contained here, measurements of doors, windows, rooms and any other items are approximate and no responsibility is taken for any error, omission or mis-statement. This plan is for illustrative purposes only and should be used as such by any prospective purchaser. The services, systems and appliances shown have not been tested and no guarantee as to their operability or efficiency can be given.  
Made with Metropix. ©2026

These particulars, whilst believed to be accurate are set out as a general outline only for guidance and do not constitute any part of an offer or contract. Intending purchasers should not rely on them as statements of representation of fact, but must satisfy themselves by inspection or otherwise as to their accuracy. No person in this firms employment has the authority to make or give any representation or warranty in respect of the property.

