



91 KINGS ROAD WEST, SWANAGE
£365,000 Freehold

This well presented semi-detached family home is conveniently located in a popular residential area approximately three quarters of a mile from the town centre and seafront and within easy reach of local convenience store and open country.

The property offers an easy living style with light and spacious accommodation and a particular feature is the dining room with casement doors to the conservatory leading to the enclosed South facing rear garden, providing the perfect entertaining space. It is well presented throughout but does require some updating. It is thought to have been built during the 1930s of traditional brick construction with a cement render under a conventional pitched roof covered with clay tiles. There is potential to extend the property, subject to planning consent. There is no forward chain.

Swanage lies at the eastern tip of the Isle of Purbeck delightfully situated between the Purbeck Hills. It has a fine, safe, sandy beach, and is an attractive mixture of old stone cottages and more modern properties, all of which blend in well with the peaceful surroundings. Swanage has an active shopping centre, with branches of a number of multiple stores. To the south is the Durlston Country Park renowned for being the gateway to the Jurassic Coast and World Heritage Coastline.



The spacious entrance hall welcomes you to this family home. Leading off is an attractive and spacious living room with bay window and brick fireplace. The dining room has double doors to the South facing conservatory which leads to the rear garden providing a perfect space for entertaining. A throughway from the dining room leads to the kitchen fitted with a range of coloured units, contrasting worktops and spaces for freestanding appliances.

On the first floor there are three good sized double bedrooms. Bedroom 1 is South facing with views over the garden. Bedrooms 2 and 3 are at the front of the house with access to low level storage. The bathroom completes the accommodation.

Outside, the front garden is easily maintained with a mix of paving and a shingle bed. There is a good sized South facing rear garden, bound by fencing, with flower and shrub borders, lawned area and paved patio.

Viewing is strictly by appointment through the Sole Agents, **Corbens, 01929 422284**.

Property Ref KIN1993

Council Tax Band D - £2,689.44 for 2025/2026

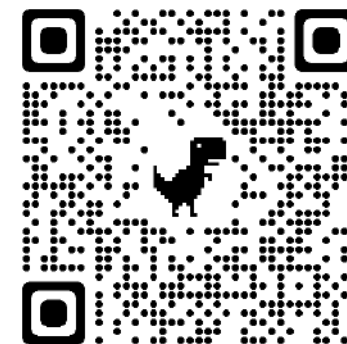
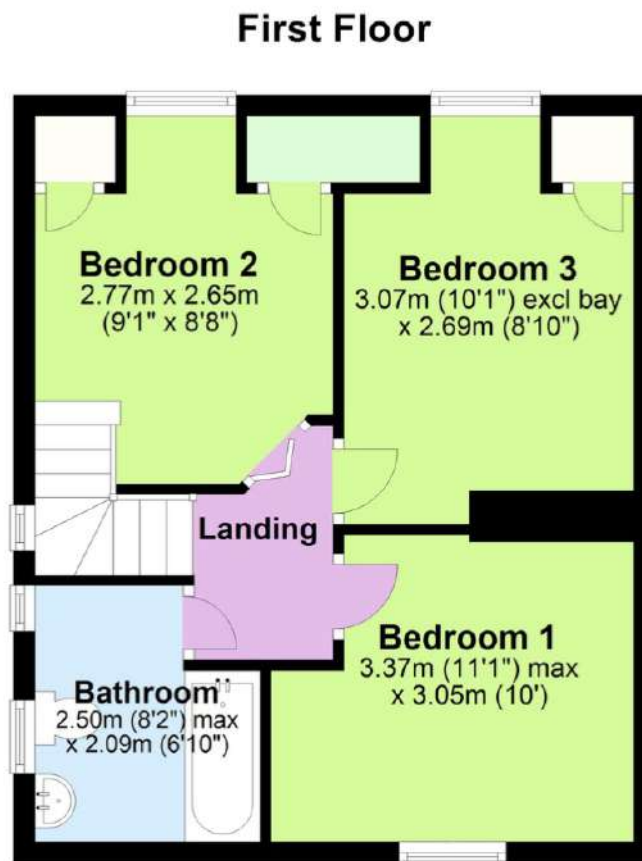
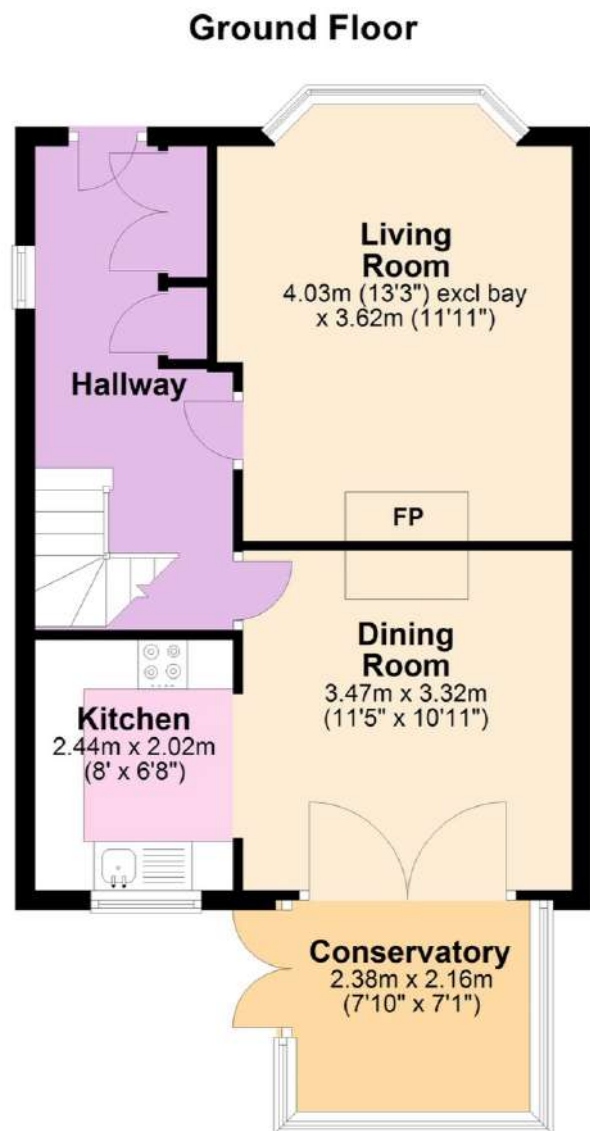

Scan to View Video Tour

Total Floor Area Approx. 84m² (904 sq ft)

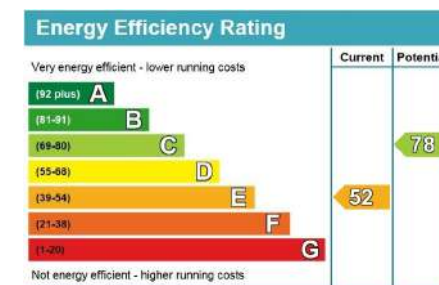

THE PROPERTY MISDESCRIPTION ACT 1991 You are advised to check the availability of this property before travelling any distance to view. The Agent has not tested any apparatus, equipment, fixtures and fittings or services and so cannot verify that they are in working order or fit for the purpose. References to the Tenure of a Property are based on information supplied by the Seller. The area of the building is given for guidance purposes only and must be verified by the purchasers surveyor. A Buyer is advised to obtain verification of this information from their Solicitor and/or Surveyor. FLOOR PLANS The floor plans supplied are for guidance purposes only and should not be used for measuring. Small recesses, cupboards & sloping ceilings may not appear on the plans. LOCATION PLAN The location plans supplied are for identification purposes only and are reproduced from the Ordnance Survey Map with permission of the Controller of H.M. Stationery Office. Crown Copyright reserved.





91 Kings Road West, Swanage, Dorset, BH19 1HN



Swanage Railway

LB



91

91a

ESS

89a

89b

68

2

8

11

13

15

166

10.7m

168

168a

12

14

21

279

279a

279b

279c

281

281a

281b

281c

281d

281e

281f

281g

281h

281i

281j

281k

281l

281m

281n

281o

281p

281q

281r

281s

281t

281u

281v

281w

281x

281y

281z

281aa

281ab

281ac

281ad

281ae

281af

281ag

281ah

281ai

281aj

281ak

281al

281am

281an

281ao

281ap

281aq

281ar

281as

281at

281au

281av

281aw

281ax

281ay

281az

281ba

281bb

281bc

281bd

281be

281bf

281bg

281bh

281bi

281bj

281bk

281bl

281bm

281bn

281bo

281bp

281bq

281br

281bs

281bt

281bu

281bv

281bw

281bx

281by

281bz

281ca

281cb

281cc

281cd

281ce

281cf

281cg

281ch

281ci

281cj

281ck

281cl

281cm

281cn

281co

281cp

281cq

281cr

281cs

281ct

281cu

281cv

281cw

281cx

281cy

281cz

281da

281db

281dc

281dd

281de

281df

281dg

281dh

281di

281dj

281dk

281dl

281dm

281dn

281do

281dp

281dq

281dr

281ds

281dt

281du

281dv

281dw

281dx

281dy

281dz

281ea

281eb

281ec

281ed

281ee

281ef

281eg

281eh

281ei

281ej

281ek

281el

281em

281en

281eo

281ep

281eq

281er

281es

281et

281eu

281ev

281ew

281ex

281ey

281ez

281fa

281fb

281fc

281fd

281fe

281ff

281fg

281fh

281fi

281fj

281fk

281fl

281fm

281fn

281fo

281fp

281fq

281fr

281fs

281ft

281fu

281fv

281fw

281fx

281fy

281fz

281ga

281gb

281gc

281gd

281ge

281gf

281gg

281gh

281gi

281gj

281gk

281gl

281gm

281gn

281go

281gp

281gq

281gr

281gs

281gt

281gu

281gv

281gw

281gx

281gy

281gz

281ha

281hb

281hc

281hd

281he

281hf

281hg

281hh

281hi

281hj

281hk

281hl

281hm

281hn

281ho

281hp

281hq

281hr

281hs

281ht

281hu

281hv

281hw

281hx

281hy

281hz

281ia

281ib

281ic

281id

281ie

281if

281ig

281ih

281ii

281ij

281ik

281il

281im

281in

281io

281ip

281iq

281ir

281is

281it

281iu

281iv

281iw

281ix

281iy

281iz

281ja

281jb

281jc

281jd

281je

281jf

281jg

281jh

281ji

281jj

281jk

281jl

281jm

281jn

281jo

281jp

281jq

281jr

281js

281jt

281ju

281jv

281jw

281jx

281jy

281jz

281ka

281kb

281kc

281kd