



**BEAUCHAMP
ESTATES**

Cranley Gardens

SOUTH KENSINGTON





A Grade II listed, period house with lift and swimming pool.



Exterior

This stunning house benefits from elegant reception rooms on the ground and first floors with high ceilings and period features. Originally designed by Charles Freake, this prestigious street forms part of the South Kensington conservation area and is named after the eldest son of the Earl of Onslow, the Viscount Cranley.

Highlights

- Four terraces
- Two balconies
- Patio
- High ceilings





Interiors

The accommodation comprises a hall with beautiful staircase, reception room, dining room, study, elegant first floor drawing room with balcony and views over gardens to the front, kitchen/breakfast room, family room, principal bedroom with two dressing rooms and ensuite bathroom, four further en-suite bedrooms, gym/bedroom six with ensuite shower, three guest cloakrooms, swimming pool with spa facilities, lift access from basement level through to the second floor, four terraces, two balconies, and a patio.



Features

- Air Conditioning
- Crestron Home Automation
- Lift
- Spa - Inside
- Swimming Pool

Location

Located in one of London's most luxurious neighbourhoods, Cranley Gardens is close to an abundance of eclectic dining options, designer boutiques, sophisticated hotels, and cultural hotspots. The open spaces of Hyde Park, as well as the South Kensington Underground Station (Circle & District lines, Piccadilly line), are easily reachable.

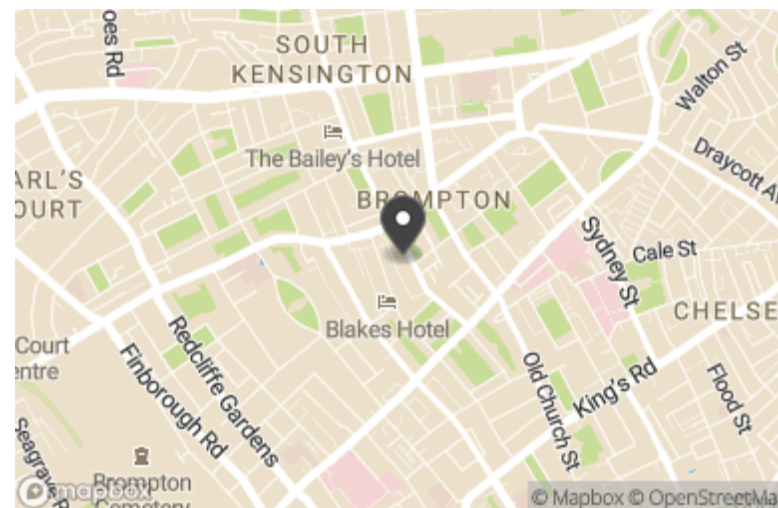

Terms

Price: £13,950,000

Tenure: Freehold

Local Authority: Kensington & Chelsea

Council Tax: H

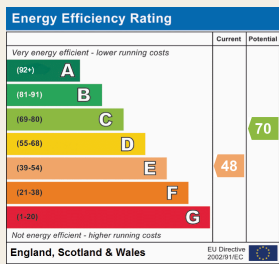

Beauchamp Estates, their clients and any joint agents give notice that: 1. They are not authorised to make or give any representation or warranties in relation to the property either here or elsewhere, either on their own behalf or on behalf of their client or otherwise. They assume no responsibility for any statement that may be made in these particulars. These particulars do not form part of any offer or contract and must not be relied upon as statements or representations of fact. 2. Any Areas, measurements or distances are approximate. The text photographs and plans are for guidance only and are not necessarily comprehensive. It should not be assumed that the property has all necessary planning, building regulation or other consents and Beauchamp Estates have not tested any services, equipment or facilities. Purchasers must satisfy themselves by inspection or otherwise.

Cranley Gardens, SW7

Approximate Gross Internal Area = 615.6 sq m / 6626 sq ft
 Basements = 79.6 sq m / 857 sq ft
 Total = 695.2 sq m / 7483 sq ft

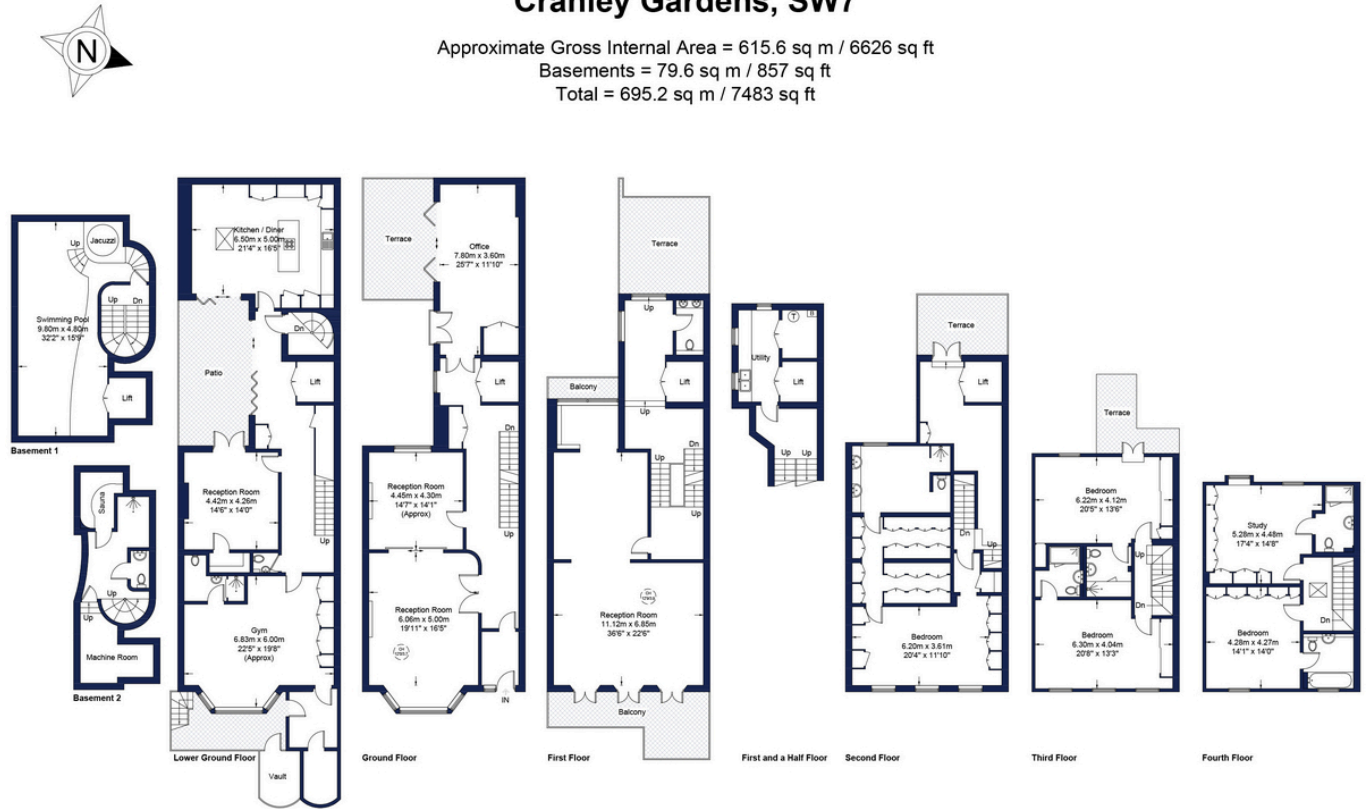

This plan is for layout guidance only. Not drawn to scale unless stated. Windows and door openings are approximate. Whilst every care is taken in the preparation of this plan, please check all dimensions, shapes and compass bearings before making any decisions reliant upon them. (ID769225)





**BEAUCHAMP
ESTATES**

Beauchamp Estates - Mayfair

24 Curzon Street,
London, W1J 7TF

020 7499 7722

londoninformation@beauchampestates.com

www.beauchampestates.com