

Coram Street, WC1N

£1,625 Per calendar month

A well presented studio apartment situated within a sought after portered mansion block in the heart of Bloomsbury. The accommodation offers wood flooring throughout, a separate fitted kitchen and a private bathroom. Heating and hot water are included within the rent.

Ideally located just moments from King's Cross St Pancras, Euston and Russell Square stations, offering excellent transport connections across London. Witley Court is also within easy reach of the West End and benefits from a wide selection of local cafés, supermarkets, restaurants and everyday amenities.

Features

- Studio Apartment
- Heating & Hot Water Included
- Russell Square
- Day Time Porter
- Key Transport Links

Coram Street,
London, WC1N

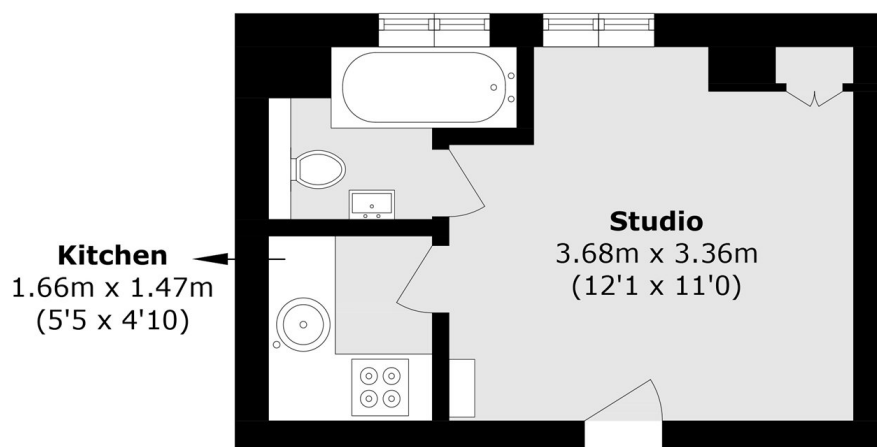

Ground Floor

Total area (approx.): 17.6 sq. m (189.4 sq. ft)