

GUILDHALL

SALES & LETTINGS



63 Lowthorpe Road

, Preston, PR1 6SB

Offers Over £210,000



****CONTEMPORARY THREE BEDROOMED SEMI DETACHED PROPERTY****

Guildhall Sales and Lettings are delighted to introduce this well presented, three bedroomed semi-detached property to the market. Situated within the popular area of Deepdale, within close proximity to local amenities, commuter routes and schools. Boasting deceptively spacious accommodation and contemporary features throughout, this property is well suited for small families or first time buyers and internally comprises briefly:

Entrance through to the lounge housing the staircase to the first floor and door to the contemporary fitted kitchen with access to the rear. To the first floor are three bedrooms and a three piece family bathroom suite.

Externally to the rear of the property is an enclosed laid to lawn garden with a paved patio seating area and access to the garage! To the front is a driveway providing off road parking.



Floor Plans

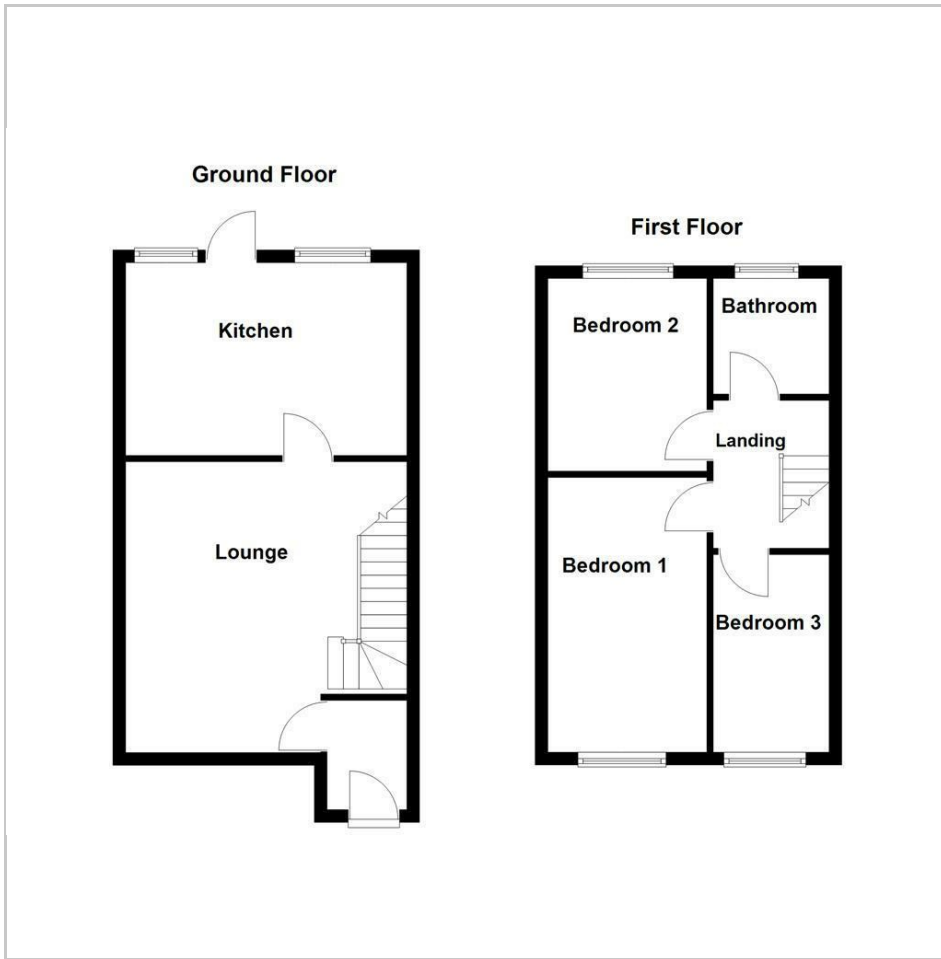

Area Map

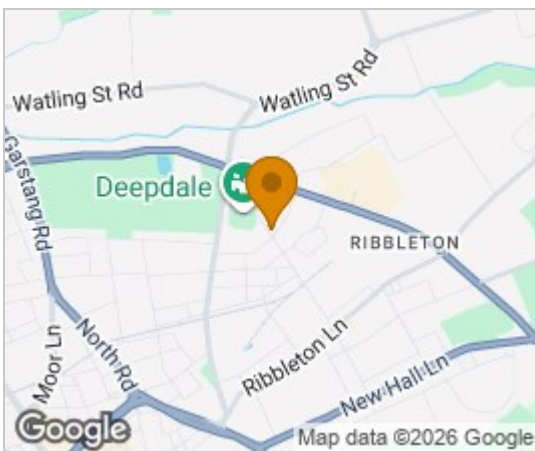

Energy Efficiency Graph

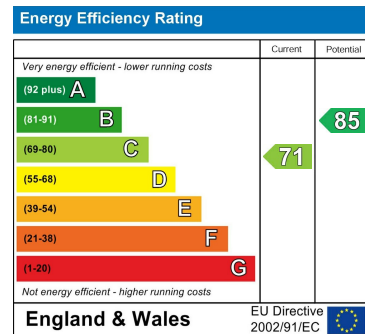

These particulars, whilst believed to be accurate are set out as a general outline only for guidance and do not constitute any part of an offer or contract. Intending purchasers should not rely on them as statements of representation of fact, but must satisfy themselves by inspection or otherwise as to their accuracy. No person in this firm's employment has the authority to make or give any representation or warranty in respect of the property.