



Belsize Avenue NW3

Parkheath  
*Sold on Service*





## **Belsize Avenue, NW3**

### **Asking Price £775,000**

### **Share of Freehold**

- A stunning, spacious and well proportioned apartment
- Set in this highly regarded 1930's mansion block
- Rarity of a parking space
- 2 generous double bedrooms with built-in wardrobes and 2 impressive fully tiled bathrooms
- Communal gardens and portorage
- Wood flooring throughout with underfloor heating
- 850 sq ft approx on the ground floor
- 16ft reception plus sleek 12ft contemporary kitchen
- Share of freehold
- Moments from all Belsize Park amenities

Belsize Park/Hampstead  
 208 Haverstock Hill  
 NW3 2AG  
 Sales 020 7431 1234  
 Lettings 020 7431 3104  
[nw3@parkheath.com](mailto:nw3@parkheath.com)

South/West Hampstead  
 192 West End Lane  
 NW6 1SG  
 Sales & Lettings  
 Tel 020 7794 7111  
[192@parkheath.com](mailto:192@parkheath.com)

**Parkheath**  
*Sold on Service*

**Camden Tax band F**

Property Management  
 192 West End Lane  
 NW6 1SG  
 020 7433 6174  
[pm@parkheath.com](mailto:pm@parkheath.com)

[www.parkheath.com](http://www.parkheath.com)



Hillfield Court, London, NW3

Approximate Gross Internal Area 79.18 sqm / 851 sqft

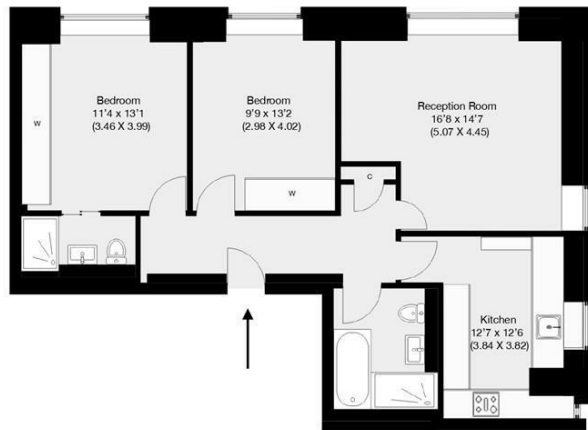

Ground Floor

THIS FLOOR PLAN IS PRODUCED FOR PARKHEATH SUBMITTED BY ARCHIMEDIA web: www.archi-media.co.uk

Whilst every attempt has been made to ensure the accuracy of the floor plan contained here, measurements of doors, windows and rooms are approximate and no responsibility is taken for any error, omission or misstatement. These plans are for representation purposes only and should be used as such by any prospective buyer or tenant. Specifically no guarantee is given on the gross internal floor area of the property if quoted on this plan and any figures given is initial guidance only and should be treated as such.

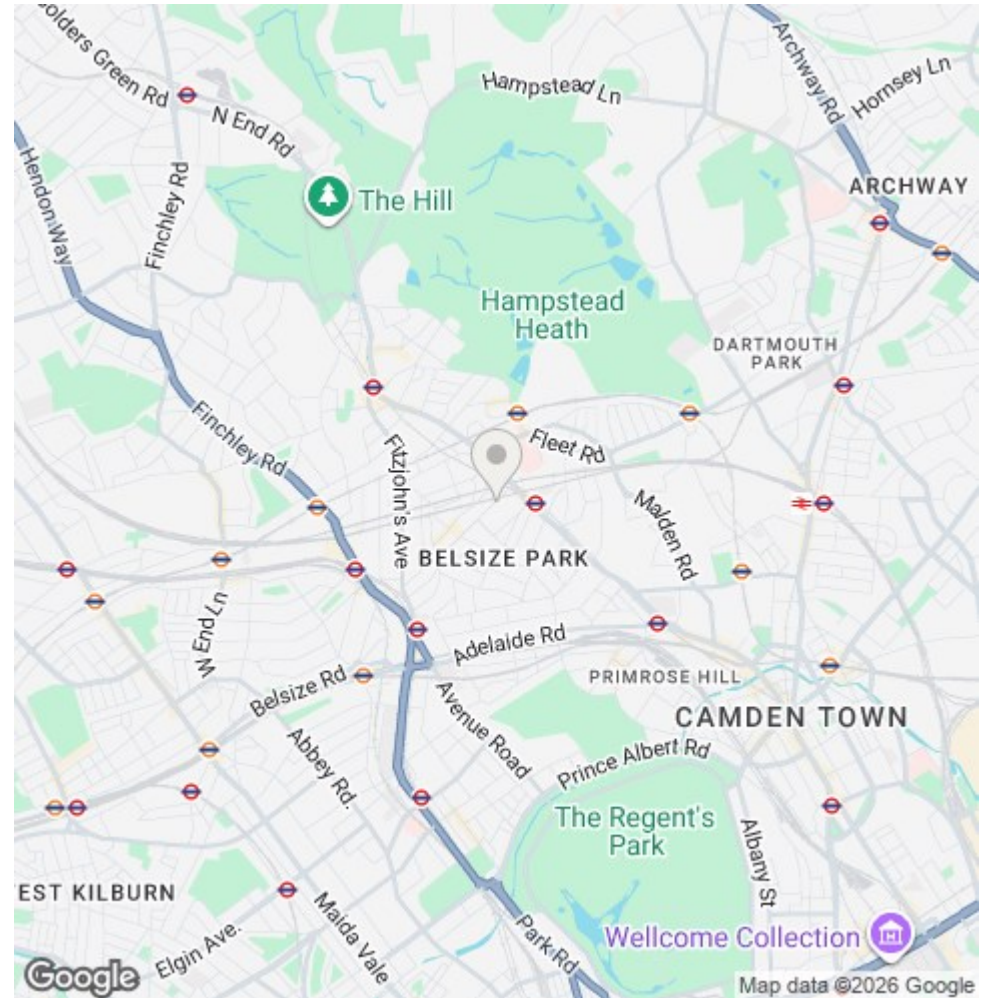

The particulars do not constitute part of an offer or contract. The particulars, including text, photographs and plans, are for the guidance only of prospective purchasers/tenants and must not be relied upon as statements of fact. The descriptions provided therein represent the opinion of the author and whilst given in good faith should not be construed as statements of fact. Nothing in these particulars shall be deemed a statement that the property is in good condition or otherwise or that any services or facilities are in good working order. All measurements are approximate