



Guide Price
£435,000

Freehold

4x  2x  1x 

**Dungeness Road, Lydd,
Romney Marsh, Kent,
TN29**

OVER 60?

Secure this property
for up to **59% less!**

Wards
Helping you move forwards



Main features

- Beautifully refurbished home
- Extended to provide plenty of room
- Landscaped garden in which to relax and enjoy the sun
- Open plan kitchen/diner with top of the range appliances
- Workshop/studio ideal for home working

Accommodation

GROUND FLOOR

Entrance Hall

Bedroom 1: 12'0 x 11'0 (3.66m x 3.36m)

Bedroom 2: 11'10 x 10'11 (3.61m x 3.33m)

Bedroom 3: 12'6 x 9'1 (3.81m x 2.77m)

Bedroom 4: 11'10 x 8'11 (3.61m x 2.72m)

Bathroom

Kitchen/Diner: 21'5 (6.53m) x 11'9 (3.58m) narrowing to 8'4 (2.54m)

Utility Room: 13'7 x 5'7 (4.14m x 1.70m)

Rear Lobby

Shower Room

Lounge: 17'5 x 12'4 (5.31m x 3.76m)

OUTBUILDING

Studio/Workshop: 17'6 x 10'0 (5.34m x 3.05m)

OUTSIDE

Off Road Parking

Front & Rear Gardens

Ground Floor

Approx. 120.7 sq. metres (1299.2 sq. feet)

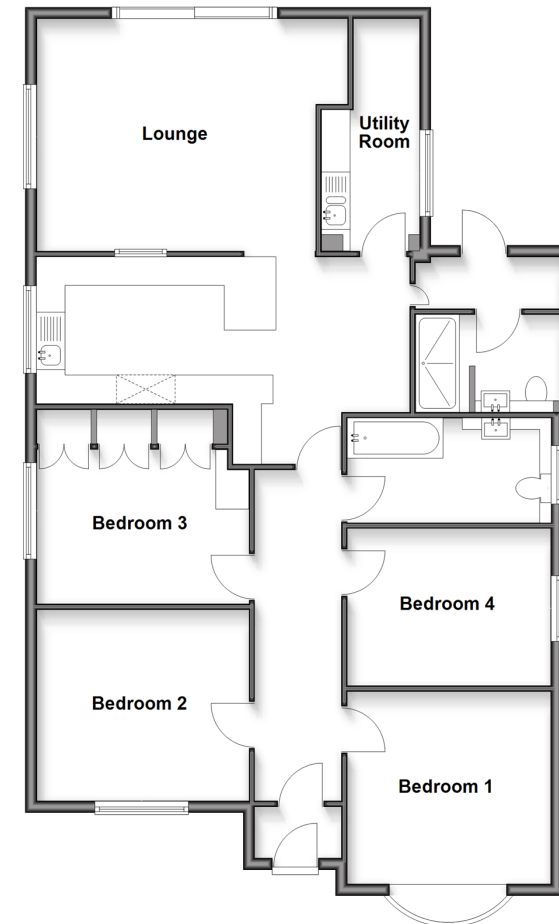

Outbuilding

Approx. 16.0 sq. metres (171.7 sq. feet)

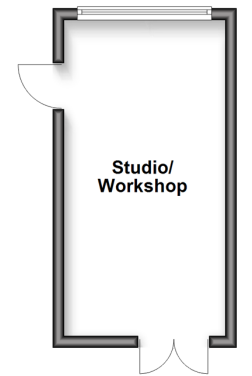

Call New Romney - 01797 363745 ■ wardsof Kent.co.uk

- Legal advice should be taken to verify fixtures/fittings, planning, alterations and/or lease details
- Appliances & services are untested, dimensions are approximate and floor plans are not to scale
- Through a Homewise Home For Life Plan people aged 60+ can secure this property for up to 59% less, by purchasing a Lifetime Lease.



13524800/20250610/SRH/SRH