



**Guide Price**  
**£250,000**

**Freehold**

1x  1x  1x 

**Elmstone Road,  
Rainham, Gillingham,  
Kent, ME8**

**OVER 60?**

Secure this property  
for up to **59% less!**

*Wards*  
Helping you move forwards



## Main features

- Well presented property
- Perfect for someone looking to downsize
- Potential for off road parking (subject to the relevant planning permission)
- Newly paved low maintenance rear garden
- Central location close to the local amenities

## Accommodation

### GROUND FLOOR

- Entrance Hall
- Kitchen : 11'6 x 5'0 (3.51m x 1.53m)
- Bathroom
- Bedroom : 10'11 x 9'7 (3.33m x 2.92m)
- Lounge/Diner : 16'8 x 15'0 (5.08m x 4.58m)

### OUTSIDE

- Front Garden
- Side Garden
- Rear Garden

### Ground Floor

Approx. 47.7 sq. metres (513.8 sq. feet)

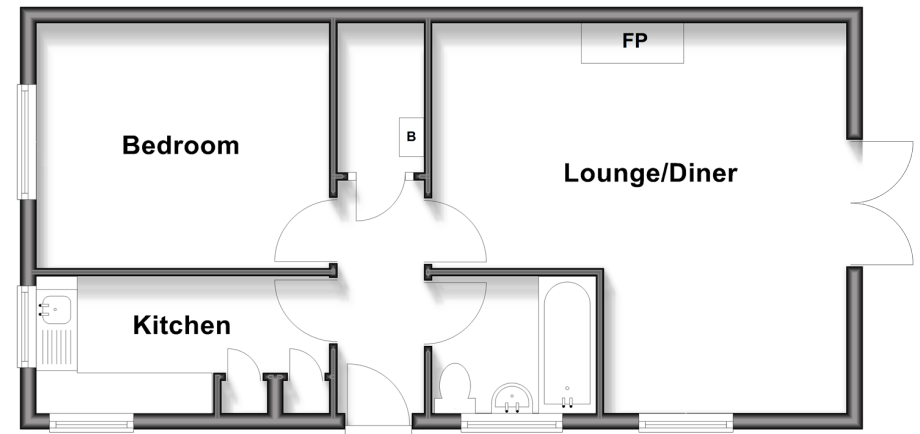

Call Rainham - 01634 373531 ■ [wardsofkent.co.uk](http://wardsofkent.co.uk)

- Legal advice should be taken to verify fixtures/fittings, planning, alterations and/or lease details
- Through a Homewise Home For Life Plan people aged 60+ can secure this property for up to 59% less, by purchasing a Lifetime Lease

- Appliances & services are untested, dimensions are approximate and floor plans are not to scale



11339160/20260124/NJ/NJ