



www.chrystals.co.im

26 Mill Street, Castletown, IM9 1AG
Asking Price £429,000

26 Mill Street, Castletown, IM9 1AG

Asking Price £429,000

This well appointed spacious modern house is situated in a convenient location, minutes walk to Castletown centre and all its amenities and shops. Accommodation comprises lounge with good sized conservatory off, leading to garden, recently refurbished breakfast kitchen, 3 bedrooms and bathroom. Outside is a lovely lawned rear garden with large patio area, and garage. The property is offered with no onward chain.



LOCATION

Travelling from Port Erin towards Castletown, proceed ahead at the traffic lights and at S&S Motors, turn right into Milner Terrace. Proceed ahead and cross over the junction into Mill Street. Number 26 can be found on the left hand side almost at the end of the street.

ENTRANCE HALLWAY

Staircase to first floor. Storage/cloaks cupboard.

BREAKFAST KITCHEN

14' 10" x 10' 0" (4.52m x 3.05m)

Recently refurbished with an excellent range of white fronted base and wall units, generous work surfaces incorporating an Asterite single bowl sink unit. 4-ring ceramic cooker with stainless steel filter hood above, integrated fridge/freezer and washer/dryer, tiled splashbacks, stable door to rear garden, French doors to:

LOUNGE

16' 2" x 10' 8" (4.92m x 3.25m)

Fireplace with new electric fire inset. Double doors to:

CONSERVATORY

10' 9" x 9' 0" (3.27m x 2.74m)

Plantation fitted blinds. Door to rear garden.

FIRST FLOOR

LANDING

Access to boarded loft via ladder. Airing cupboard.

BEDROOM 1

12' 9" x 9' 5" (3.88m x 2.87m)

Built-in wardrobes. Rear aspect.

BEDROOM 2

9' 1" x 9' 0" (2.77m x 2.74m)

Stand alone double wardrobes. Rear aspect.

BEDROOM 3

9' 7" x 6' 10" (2.92m x 2.08m)

Front aspect.

BATHROOM

Recently refurbished with a modern suite comprising jacuzzi bath, wash hand basin in vanity unit and w.c. Chrome heated towel rail, tiled walls and flooring, extractor fan.

OUTSIDE

Lovely enclosed sunny lawned garden with large patio area.

GARAGE

Up and over door, power and lighting, rear door to garden.

SERVICES

Mains water, drainage and electricity. Gas central heating.

POSSESSION

Freehold. Vacant possession on completion of purchase. No onward chain. The company do not hold themselves responsible for any expenses which may be incurred in visiting the same should it prove unsuitable or have been let, sold or withdrawn. DISCLAIMER - Notice is hereby given that these particulars, although believed to be correct do not form part of an offer or a contract. Neither the Vendor nor Chrystals, nor any person in their employment, makes or has the authority to make any representation or warranty in relation to the property. The Agents whilst endeavouring to ensure complete accuracy, cannot accept liability for any error or errors in the particulars stated, and a prospective purchaser should rely upon his or her own enquiries and inspection. All Statements contained in these particulars as to this property are made without responsibility on the part of Chrystals or the vendors or lessors.





GROUND FLOOR

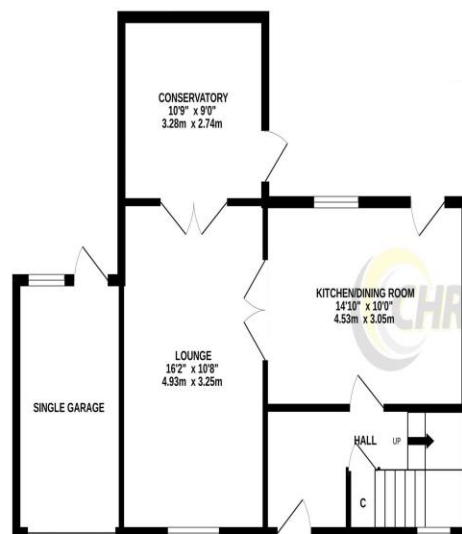

1ST FLOOR



Measurements are approximate. Not to scale. Illustrative purposes only
Made with Metropix ©2026

Notice is hereby given that these particulars, although believed to be correct do not form part of an offer or a contract. Neither the Vendor nor Chrystals, nor any person in their employment, makes or has the authority to make any representation or warranty in relation to the property. The Agents whilst endeavouring to ensure complete accuracy, cannot accept liability for any error or errors in the particulars stated, and a prospective purchaser should rely upon his or her own enquiries and inspection. All Statements contained in these particulars as to this property are made without responsibility on the part of Chrystals or the vendors or lessors.

Since 1854



DOUGLAS

31 Victoria Street
Douglas IM1 2SE
T. 01624 623778
E. douglas@chrystals.co.im

PORT ERIN

23 Station Road
Port Erin IM9 6RA
T. 01624 833903
E. porterin@chrystals.co.im

COMMERCIAL

Douglas Office: 01624 625100, commercial@chrystals.co.im

RENTALS

Douglas Office: 01624 625300, douglasrentals@chrystals.co.im

Directors: Shane Magee M.R.I.C.S.; Neil Taggart BSc (Hons), M.R.I.C.S.; Joney Kerruish BSc (Hons), M.R.I.C.S.; Dafydd Lewis BSc (Hons), M.R.I.C.S., MA (Cantab), Dip Surv Prac. Registered in the Isle of Man No. 34808, Chrystal Bros, Stott & Kerruish Ltd. Trading as Chrystals. Registered Office, 31 Victoria Street, Douglas, Isle of Man IM1 2SE.