



Hampton Court, Batavia Road, London, SE14 6AQ



Hampton Court, London, SE14

Leasehold (115 years remaining)

A modern top floor apartment spanning 837 Sq. Ft., located in the heart of New Cross, with restaurants, bars and independent coffee shops all within walking distance.

Key Features

- Two Double Bedrooms
- Two Bathrooms
- Beautifully presented throughout
- South-West facing balcony
- Ground Rent: **£250 P/A**
- Service Charge: **£1,893 P/A**
- Council Tax: C
- EPC: B

This apartment is on a quiet side street, and the accommodation comprises: large entrance hall with built in double cupboard and doors leading to all rooms. The open plan reception room / kitchen is a generous size at 20'2 x 17'3 which opens onto a private balcony. The kitchen has been thoughtfully arranged with an array of eye and base level units and integrated appliances. Both bedrooms are large double rooms. The primary bedroom has the additional benefit of an en-suite shower room and completing the flat is the family bathroom, laid out with toilet, hand basin and bathtub.

The transport links nearby are super convenient, as commuters and socialisers. Being 4 minutes from New Cross Gate Station with excellent transport links to the City and West End. This location also benefits from an array of local pubs, bars and shops on your doorstep together with a selection of beautiful parks and green walks.









Hampton Court

Approximate Gross Internal Area = 77.76 sq m / 837 sq ft

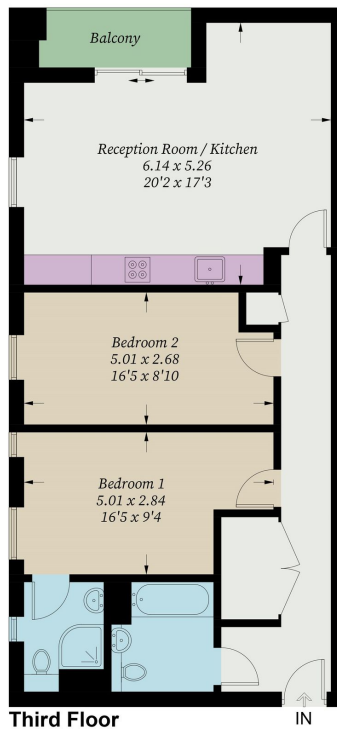

Illustration for identification purposes only, measurements are approximate, not to scale. Fourtats.co © (ID1157626)

22 College Approach, Greenwich,
London, SE10 9HY
Tel: 020 7399 5595

Sales, Lettings & Property Management

residential.jll.co.uk

