



Fairfield Road, E3

£350,000

A one double bedroom apartment on Fairfield Road comprising an open-plan reception area, a private balcony, and access to a communal roof terrace.

The property is centrally located within easy reach of Bow Road, Mile End, and Stratford, offering convenient access to local cafés, restaurants, and bars.

Features

- Secure Entry System
- Wooden Flooring
- Juliet Balcony
- Roof Terrace
- Chain Free
- Local Amenities

Fairfield Road, London, E3

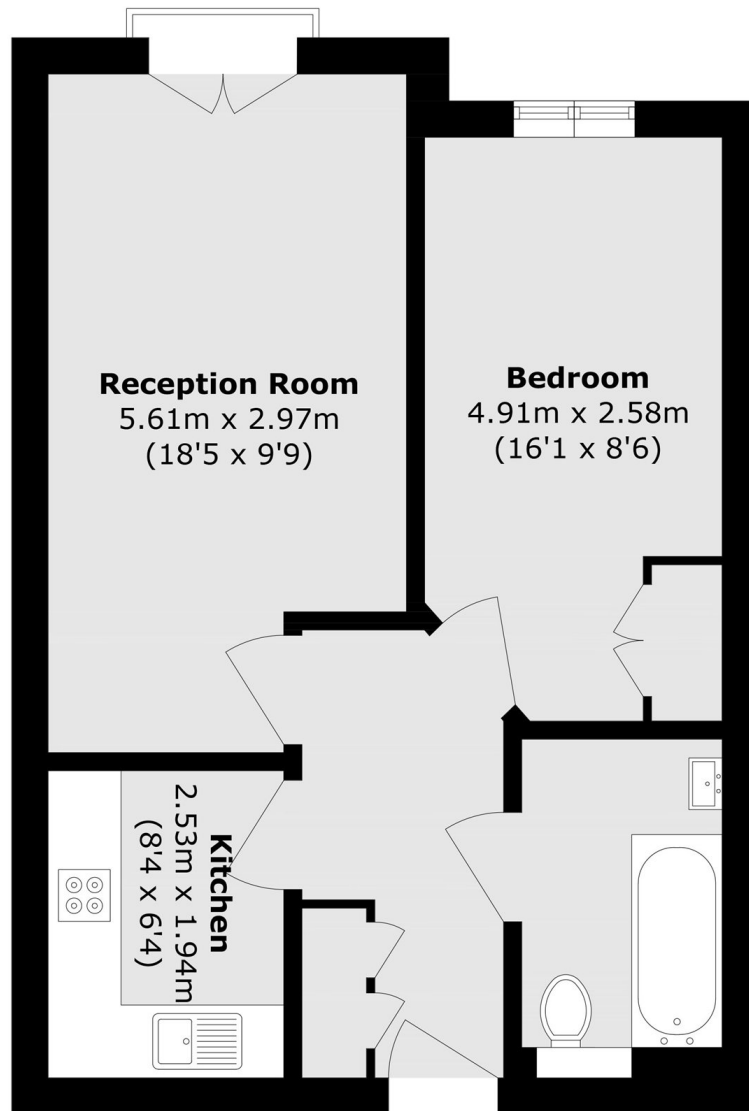

Total area (approx.): 44.6 sq. m (480.0 sq. ft)