



**move**  
Property Sales & Lettings

Redmarley Road, Cheltenham



## Redmarley Road

Cheltenham

Chain-free two-bed apartment in Oakley Grange with en suite, built-in storage, allocated parking, and bright living space. Ideal for first-time buyers or investors. Lease: 131 years remaining.

Council Tax band: B

Tenure: Leasehold

EPC Energy Efficiency Rating: B

EPC Environmental Impact Rating: B

- Two Double Bedrooms
- NO ONWARD CHAIN
- Ideal For First Time Buyers Or Investors
- Close to Local Amenities
- First Floor Apartment
- Allocated Parking
- Bathroom & En-suite
- Views to Surrounding Hills



# GROUND FLOOR

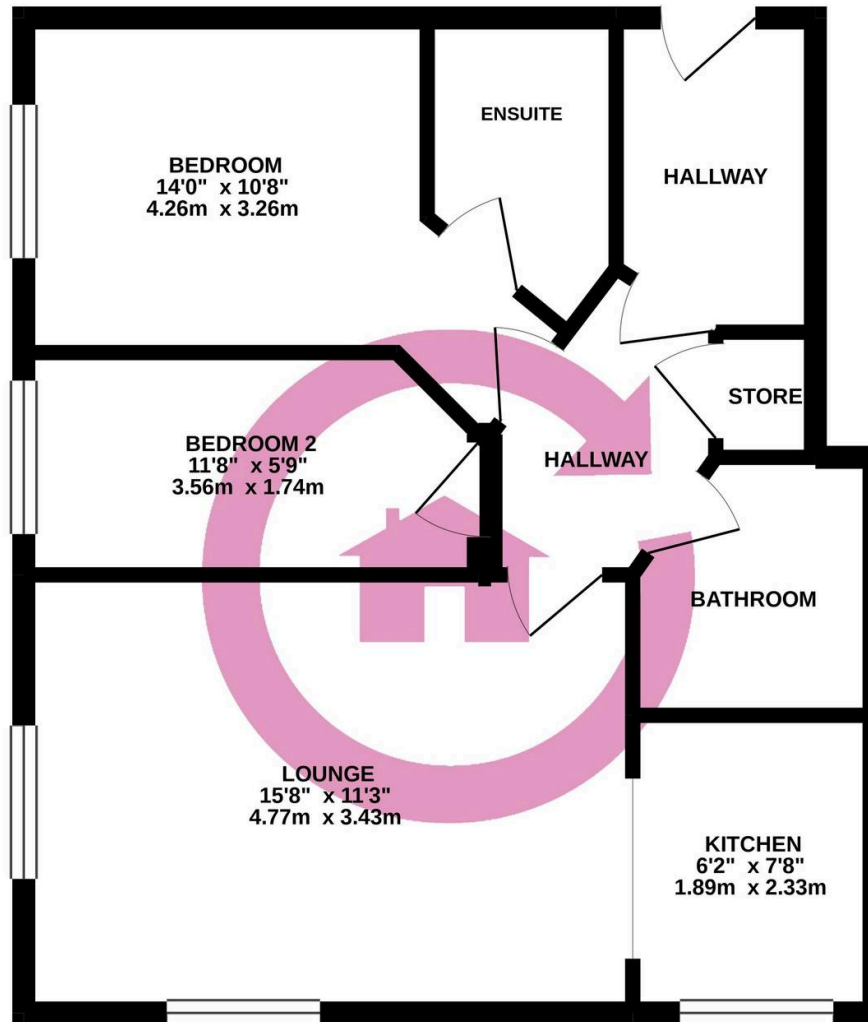



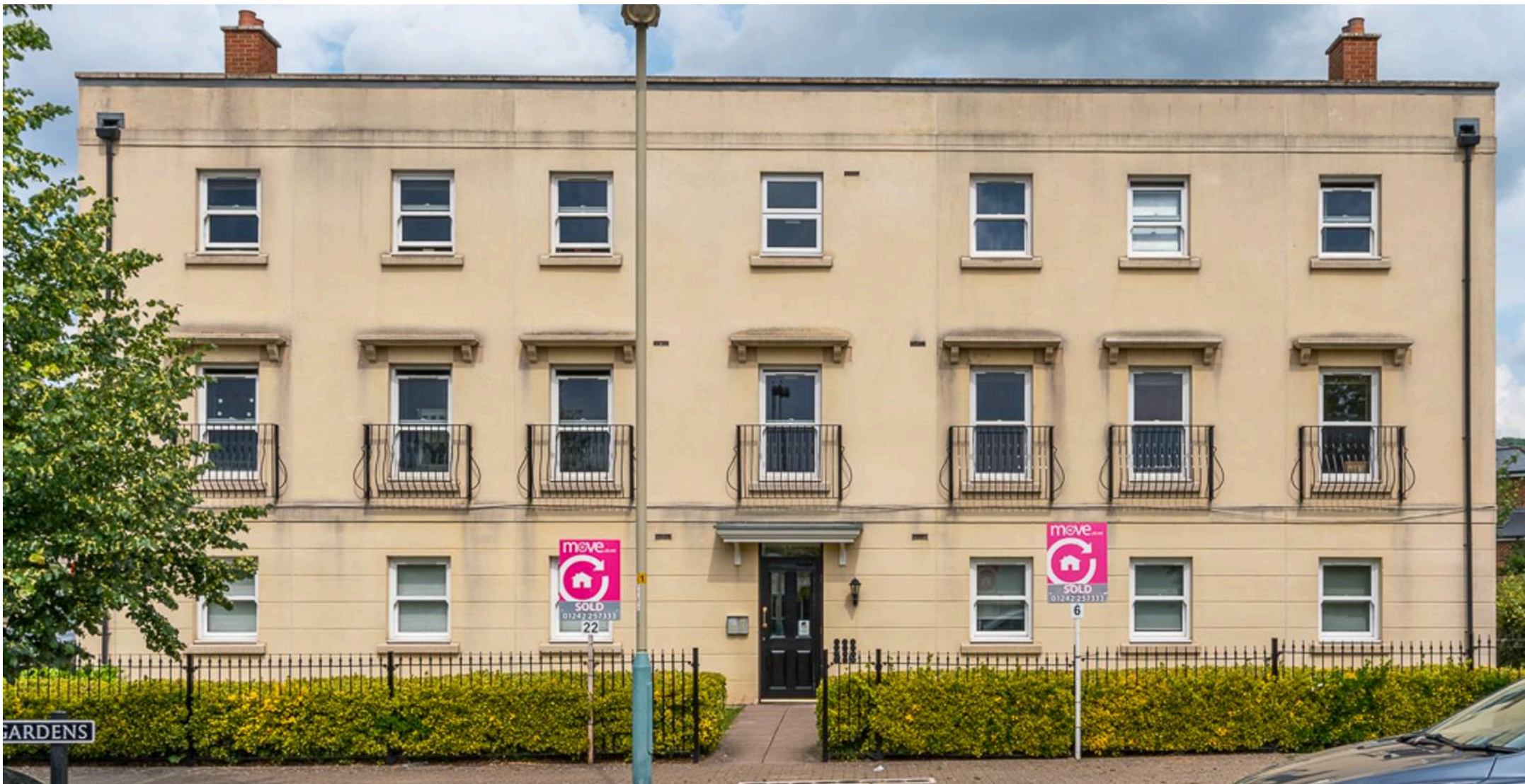

## Move Estate Agents Cheltenham

1 The Clarence Clarence Parade, Cheltenham - GL50 3NY

01242 257333

cheltenham@move.uk.net

move.uk.net/

**move**  
Property Sales & Lettings