



Lytham Close, Grantham NG31 9GE

welcome to

Lytham Close, Grantham

GUIDE PRICE £165,000 - £175,000 - End-Terraced house, perfect for a First Time Buyer and benefitting from two parking spaces and garage. This lovely property offers a lounge with an archway to the kitchen diner, two bedrooms and bathroom. Garden to the rear featuring lawn and a patio area.



Entrance

Entering the property at the front through a part-glazed door into the hallway having a window to the front aspect, radiator, staircase to the first floor landing.

Kitchen

10' 5" x 6' 7" (3.17m x 2.01m)

With a window to the front aspect and having a range of grey units to both the floor and eye level with worktops over, stainless steel sink, drainer and mixer tap. Integrated oven, hob and extractor hood above, space for a washing machine and fridge freezer. Partial tiling to the walls and tile effect flooring, coving to the ceiling, wall mounted boiler, radiator and archway through to the lounge.

Lounge

13' 1" x 13' 5" (3.99m x 4.09m)

Having wood effect laminate flooring, a radiator, coving to the ceiling and patio doors leading out to the garden.

First Floor Landing

The landing has carpet, hatch access to the loft and doors giving access to the bedrooms and bathroom.

Bedroom One

13' 2" x 9' 5" (4.01m x 2.87m)

With two window to the rear aspect, built-in wardrobe, coving and spotlights to the ceiling, carpet and a radiator.

Bedroom Two

12' 3" x 6' 5" (3.73m x 1.96m)

Large single bedroom with a window to the front aspect, carpet and a radiator.

Bathroom

6' 4" x 6' 1" (1.93m x 1.85m)

With a window to the front aspect and comprising of a bath with shower over, wash hand basin, low level WC, tiling to the walls, vinyl flooring and a heated towel rail.

General Description Outside

The front features two parking spaces, paved area, lawn and a pathway leading to the front door and garage. Gated access to the rear garden.

The rear garden benefits from raised beds, a patio area which is perfect for outside dining and entertaining, lawn, enclosed by fencing.



view this property online williamhbrown.co.uk/Property/GST113708



welcome to

Lytham Close, Grantham

- End-Terraced House
- Lounge & Kitchen Diner
- Two Bedrooms
- Two Parking Spaces and Garage
- Garden to the Rear

Tenure: Freehold EPC Rating: C
Council Tax Band: B

guide price

£165,000 - £175,000

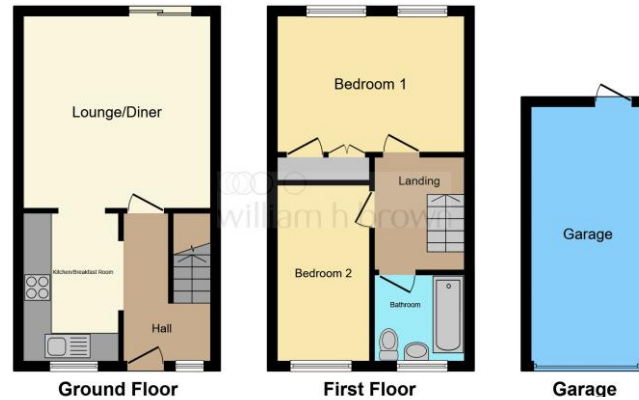

Please note the marker reflects the postcode not the actual property

view this property online [williamhbrown.co.uk/Property/GST113708](https://www.williamhbrown.co.uk/Property/GST113708)



Property Ref:
GST113708 - 0004

1. MONEY LAUNDERING REGULATIONS Intending purchasers will be asked to produce identification documentation at a later stage and we would ask for your co-operation in order that there is no delay in agreeing the sale. 2. These particulars do not constitute part or all of an offer or contract. 3. The measurements indicated are supplied for guidance only and as such must be considered incorrect. Potential buyers are advised to recheck measurements before committing to any expense. 4. We have not tested any apparatus, equipment, fixtures or services and it is in the buyers interest to check the working condition of any appliances. 5. Where an EPC, or a Home Report (Scotland only) is held for this property, it is available for inspection at the branch by appointment. If you require a printed version of a Home Report, you will need to pay a reasonable production charge reflecting printing and other costs. 6. We are not able to offer an opinion either written or verbal on the content of these reports and this must be obtained from your legal representative. 7. Whilst we take care in preparing these reports, a buyer should ensure that his/her legal representative confirms as soon as possible all matters relating to title including the extent and boundaries of the property and other important matters before exchange of contracts.

William H Brown is a trading name of Sequence (UK) Limited which is registered in England and Wales under company number 4268443, Registered Office is Cumbria House, 16-20 Hockliffe Street, Leighton Buzzard, Bedfordshire, LU7 1GN. VAT Registration Number is 500 2481 05.



william h brown



01476 566363



Grantham@williamhbrown.co.uk



63 High Street, GRANTHAM, Lincolnshire,
NG31 6NN



[williamhbrown.co.uk](https://www.williamhbrown.co.uk)