



**Guide Price**  
**£675,000**

**Freehold**

5x  2x  1x 

**Linton Hill, Linton,  
Maidstone, Kent, ME17**

**OVER 60?**

Secure this property  
for up to **59% less!**

*Wards*  
Helping you move forwards

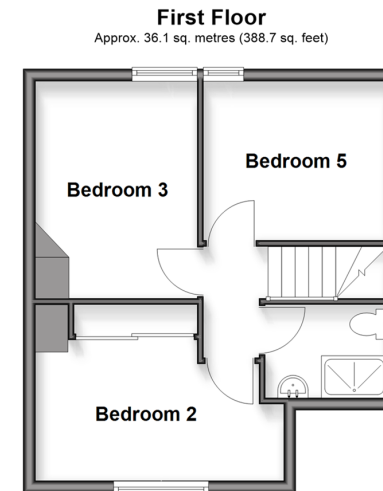

## Accommodation

### GROUND FLOOR

Entrance Hall  
 Lounge: 14'0 x 13'1 (4.27m x 3.99m)  
 Family Area: 19'0 x 8'1 (5.80m x 2.47m)  
 Kitchen/Breakfast Area: 31'1 x 18'1 (9.48m x 5.52m)  
 Inner Hallway  
 Bedroom 1: 16'1 x 13'0 (4.91m x 3.97m)  
 Walk-in Wardrobe  
 Bedroom 4: 10'0 x 9'1 (3.05m x 2.77m)  
 Bathroom: 7'0 x 6'1 (2.14m x 1.86m)

### FIRST FLOOR

Landing  
 Bedroom 2: 13'0 x 7'1 (3.97m x 2.16m)  
 Bedroom 3: 11'1 x 8'1 (3.38m x 2.47m)  
 Bedroom 5: 9'1 x 8'1 (2.77m x 2.47m)  
 Shower Room: 6'0 x 4'1 (1.83m x 1.25m)

### OUTSIDE

Double Garage and Driveway  
 Rear Garden





## Main features

- Beautifully renovated to the highest standard throughout and immaculately presented
- Flexible layout with bedrooms on both floors
- Superb bedroom 1 complete with walk-in wardrobe
- Stunning garden with far reaching views across the surrounding countryside
- Picturesque semi rural location, with local shops & amenities in the neighbouring village



### Nearest Schools

Primary Schools: Boughton Monchelsea Primary 1.2 miles, Coxheath Primary 1.4 miles, Loose Primary 1.9 miles  
Secondary Schools: Cornwallis Academy 1.1 miles, Sutton Valence School 3.5 miles, Maidstone Grammar School 3.5 miles



### Transport Information

Train Stations: Marden 2.9 miles, Staplehurst 3.5 miles, East Farleigh 3.5 miles



### Address

Linton Hill, Linton, Maidstone, Kent, ME17



### Directions

For directions to this property please contact us.







Call Loose Branch 01622 744067 ■ [wardsofkent.co.uk](http://wardsofkent.co.uk)



- Legal advice should be taken to verify fixtures/fittings, planning, alterations and/or lease details
- Appliances & services are untested, dimensions are approximate and floor plans are not to scale
- Through a Homewise Home For Life Plan people aged 60+ can secure this property for up to 50% less, by purchasing a Lifetime Lease



13022038/20251105/KIR/VMK