



12 Old Rectory Mews, Hamworthy, Poole, Dorset, BH15 4BP

£385,000

- Three Bedrooms
- Fully Fitted Kitchen
- Flooring Included
- Popular Location
- New Home
- Driveway
- Deceptively Spacious
- En-Suite Shower
- Lovely Garden
- Downstairs Toilet



Ground Floor

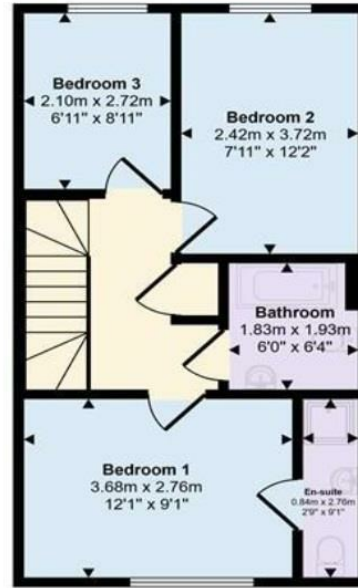

First Floor

This floorplan is only for illustrative purposes and is not to scale. Measurements of rooms, doors, windows, and any items are approximate and no responsibility is taken for any error, omission or mis-statement. Icons of items such as bathroom suites are representations only and may not look like the real items. Made with Made Snappy 360.

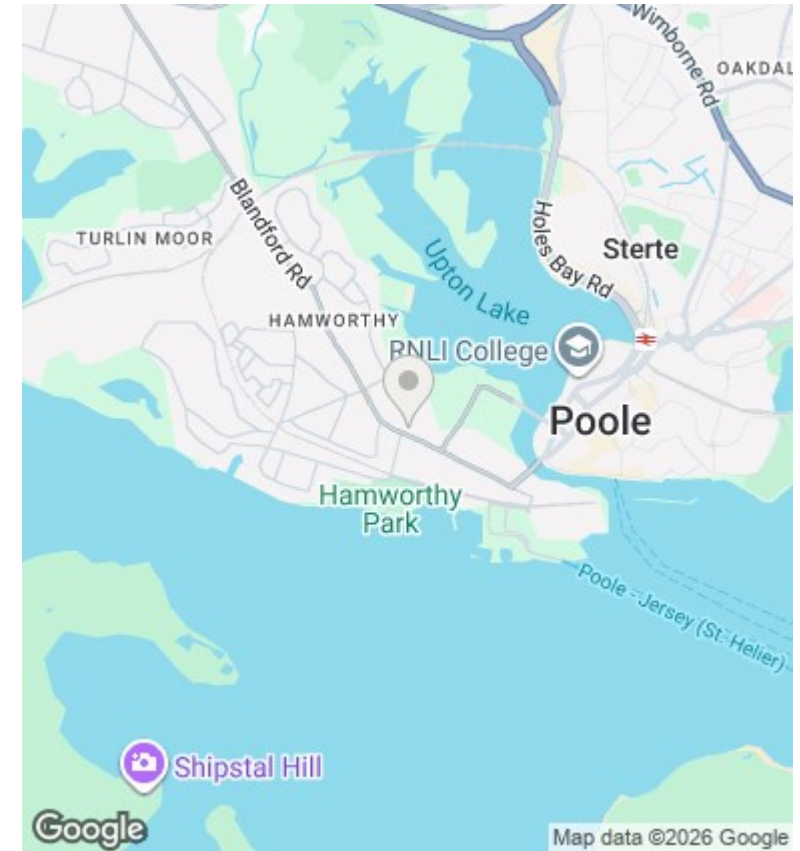

Directions

Viewings

Viewings by arrangement only. Call 01202 622101 to make an appointment.

Council Tax Band

New Build

EPC Rating:

A

Energy Efficiency Rating		Current	Potential
<i>Very energy efficient - lower running costs</i>			
(92 plus) A		93	93
(81-91) B			
(69-80) C			
(55-68) D			
(39-54) E			
(21-38) F			
(1-20) G			
<i>Not energy efficient - higher running costs</i>			
England & Wales		EU Directive 2002/91/EC	