

## Baldock Road, Stotfold, Hitchin, SG5 4PB

Guide Price £650,000

5 3 3



A traditional family home with a modern touch, on a plot presenting a south-facing garden, a driveway and a garage. The location is on the edge of fields and 150m from the river, while within easy reach of all Stotfold offers

## Key Features

- Detached family home
- Lots of added extras
- Five double bedrooms
- Private front garden
- 150m from river and fields
- Extended accommodation
- Stunning kitchen
- South-facing rear garden
- Two driveways and a garage
- Walk to schools and amenities

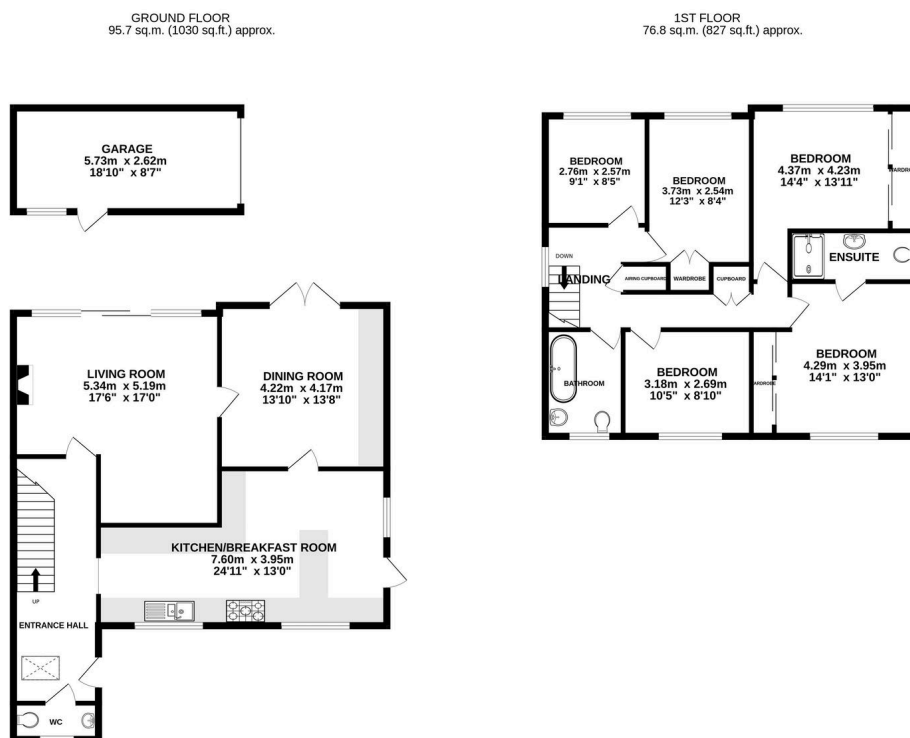

TOTAL FLOOR AREA: 172.5 sq.m. (1857 sq.ft.) approx.

Whilst every attempt has been made to ensure the accuracy of the floorplan contained here, measurements of doors, windows, rooms and any other items are approximate and no responsibility is taken for any error, omission or mis-statement. This plan is for illustrative purposes only and should be used as such by any prospective purchaser. The services, systems and appliances shown have not been tested and no guarantee as to their operability or efficiency can be given.

Made with Metropix ©2025