

# BARKER DRIVE, NW1 0JZ

£2,300pm

---

LONDON NW1

CHESTERTONS

# BARKER DRIVE

This recently refurbished two bedroom apartment is situated on the second floor within this purpose built development. The property comprises; reception room, semi-open plan kitchen, double bedroom, smaller bedroom and three piece bathroom suite.





## Specifications

- Recently refurbished two bedroom purpose built apartment
- Reception, Semi Open-Plan Kitchen & Bathroom
- Moments from Camden Town's local amenities & transport
- Benefits from having wood floors throughout











Price: | EPC: C

**Barker Drive, NW1**

Approximate gross internal area

50.35 sq m / 542 sq ft

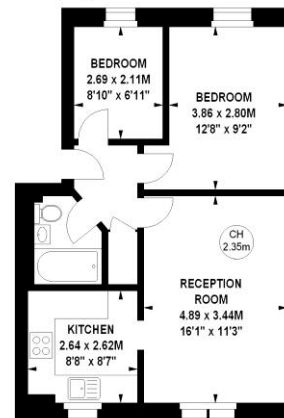
Key:  
CH - Ceiling Height**Second Floor**

The floor plan is not to scale and measurements and areas shown are approximate and therefore should be used for illustrative purposes only. The plan has been prepared in accordance with the RICS code of Measuring Practice and whilst we have confidence in the information produced, it must not be relied on. If there is any aspect of particular importance, you should carry out or commission your own inspection of the property.  
Copyright of FeaturePRO.

**Barker Drive, NW1**

Approximate gross Internal area  
50.4 sq m / £4.24/Sq.Ft. p/m

This plan is for layout guidance only. Not drawn to scale unless stated. Windows and door openings approximate. Whilst every care is taken in the preparation of this plan, please check all dimensions, shapes and compass bearings before making decisions reliant upon them.

## Location

This property offers a rare blend of tranquillity and central London convenience. Just a short walk from **Camden Road (Overground)** and **Camden Town (Northern Line)** stations, with **King's Cross & St Pancras International** also nearby, providing excellent national and international transport links.

The area benefits from easy access to **Regent's Canal**, **Camley Street Natural Park**, and **Regent's Park**, perfect for outdoor leisure. Camden's vibrant mix of cafes, bars, shops, and cultural attractions are all within walking distance, making this an ideal location for professionals and families seeking both calm and connectivity.

Chestertons Camden & Primrose Hill  
99-101 Parkway  
London, NW1

02072673574  
camdentownlettingsusers@chestertons.  
chestertons.co.uk

Chesterton Global Ltd trading as Chestertons for themselves and for the vendor of this property whose agents they are, give notice that (i) these particulars do not constitute any part of an offer or contract, (ii) all statements contained within these particulars are made without responsibility on the part of Chestertons or the vendor, (iii) whilst made in good faith, none of the statements contained within these particulars are to be relied upon as a statement or representation of fact, (iv) any intending purchasers must satisfy themselves by inspection or otherwise as to the correctness of each of the statements contained within these particulars, (v) the vendor does not make or give either Chestertons or any person in their employment any authority to make or give representation or warranty whatsoever in relation to this property. Wide angle lenses may be used. ©Copyright Chestertons | Chesterton Global Ltd | Registered Office 40 Connaught Street, Hyde Park, London W2 2AB Registered Company Number 05334580.

