

## £239,995

### CARBERRY DRIVE, PORTCHESTER, PO16 9JD



- Two Double Bedrooms
- Entrance Lobby
- Lounge
- Dual Aspect Kitchen
- Ground Floor Study/Office
- Bathroom
- Double Glazed Windows
- Gas Central Heating
- Enclosed Rear Garden
- Leasehold

#### Portchester Office

92 West Street Portchester Hampshire PO16 9UQ

Tel: 02392 327 070 | E: [tiffany.porchester@fenwicks-estates.co.uk](mailto:tiffany.porchester@fenwicks-estates.co.uk)

[www.fenwicks-estates.co.uk](http://www.fenwicks-estates.co.uk)

Property Reference: P2905

Council Tax Band: A

Score	Energy rating	Current	Potential
92+	A		
81-91	B		
69-80	C	72 C	74 C
55-68	D		
39-54	E		
21-38	F		
1-20	G		

Floor Plans (For illustrative purposes and not drawn exactly to scale)

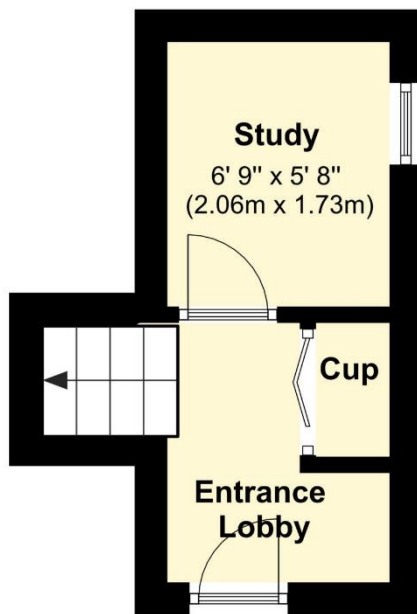

Ground Floor

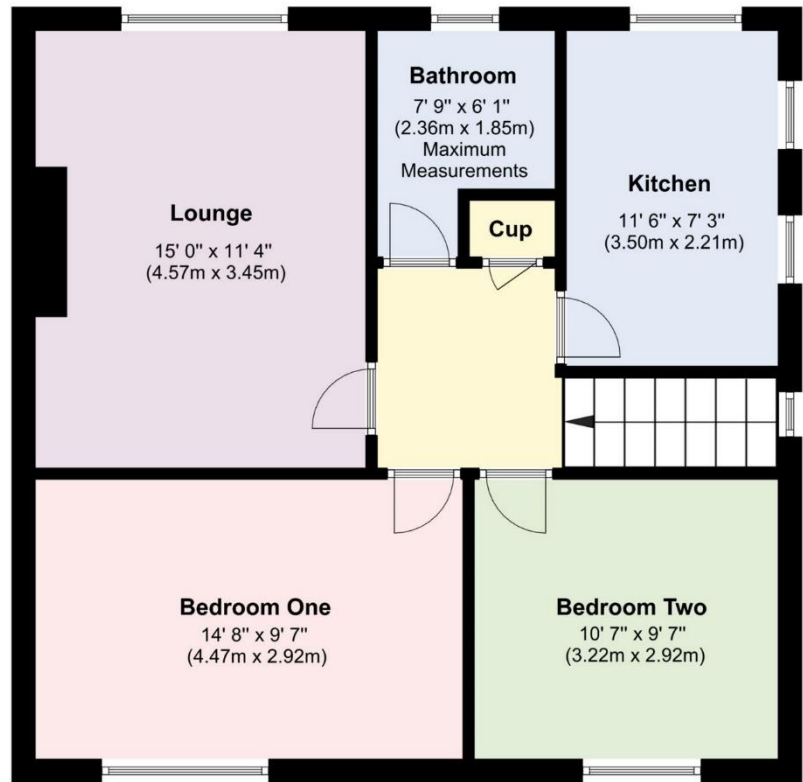

First Floor

**Portchester Office**

92 West Street Portchester Hampshire PO16 9UQ

Tel: 02392 327 070 | E: tiffany.porchester@fenwicks-estates.co.uk

www.fenwicks-estates.co.uk



## The Accommodation Comprises:-

UPVC part double glazed door to:

### Entrance Lobby:-

Stairs leading to the first floor, contemporary radiator, built-in storage cupboard, tiled flooring, flat ceiling. Doors to:

### Study/Office:-

6' 9" x 5' 8" (2.06m x 1.73m)

UPVC double glazed window to the side elevation, power connected and flat ceiling.

### First Floor Landing:-

UPVC double glazed window to the side elevation, built-in storage housing the meters, wooden flooring, flat ceiling with access to the part boarded loft via a fitted ladder. Doors to:

### Lounge:-

15' 0" x 11' 4" (4.57m x 3.45m)

UPVC double glazed window to the rear elevation, radiator, feature open fireplace with slate hearth and wooden surround, TV aerial point and coving to textured ceiling.



### Kitchen:-

11' 6" x 7' 3" (3.50m x 2.21m)

A dual aspect room with UPVC double glazed windows to the side and rear elevations, the kitchen is fitted with a range of base and eye level storage cupboards with roll top worksurfaces, single bowl single drainer sink unit inset with a mixer tap and part tiled walls, space for cooker with extractor canopy above, recess for fridge/freezer, space and plumbing for washing machine, under floor heating, matching cupboard housing the gas central heating boiler, heated towel rail, tiled flooring and flat ceiling.



## Portchester Office

92 West Street Portchester Hampshire PO16 9UQ

Tel: 02392 327 070 | E: [tiffany.porchester@fenwicks-estates.co.uk](mailto:tiffany.porchester@fenwicks-estates.co.uk)

[www.fenwicks-estates.co.uk](http://www.fenwicks-estates.co.uk)

## Bedroom One:-

14' 8" x 9' 7" (4.47m x 2.92m)

UPVC double glazed window to the front elevation, radiator and flat ceiling.



## Bedroom Two:-

10' 7" x 9' 7" (3.22m x 2.92m)

UPVC double glazed window to the front elevation, radiator and flat ceiling.



## Bathroom:-

7' 9" x 6' 1" (2.36m x 1.85m) Maximum Measurements

UPVC double glazed window to the rear elevation, white suite comprising P-shaped panelled bath with mixer tap, electric shower and screen, pedestal wash hand basin with mixer tap, close coupled WC, part tiled walls, chrome heated towel rail, wood effect laminate flooring and flat ceiling.



## Outside:-

The front garden is lawn with shingle borders. Side access then leads to:



## Rear Garden:-

The enclosed South facing rear garden with decking for entertaining purposes, lawn, water tap, outside power sockets and sheds to remain.

## Portchester Office

92 West Street Portchester Hampshire PO16 9UQ

Tel: 02392 327 070 | E: [tiffany.porchester@fenwicks-estates.co.uk](mailto:tiffany.porchester@fenwicks-estates.co.uk)

[www.fenwicks-estates.co.uk](http://www.fenwicks-estates.co.uk)





### Agents Note:-

We have been advised this property is leasehold starting 21st June 1982 until 20th June 2197 inclusive.

The charges for 2026/2027 are:

Maintenance: £500.00 Per Annum

Ground Rent: £10.00 Per Annum

Buildings Insurance: £121.00 Per Annum

**Disclaimer:** These particulars are set out as a general outline in accordance with the Consumer Protection from Unfair Trading Regulations 2008 (CPR's) and Business Protection from Misleading Marketing Regulations 2008 (BPR's) only for the guidance of intending purchasers or lessees, and do not constitute any part of an offer or contract. Details are given without any responsibility, and any intending purchasers, lessees or third parties should not rely on them as statements or representations of fact, but must satisfy themselves by inspection or otherwise as to the correctness of each of them.

We have not carried out a structural survey and the services, appliances and specific fittings have not been tested. All photographs, measurements, floor plans and distances referred to are given as a guide only and should not be relied upon for the purchase of carpets or any other fixtures or fittings. Gardens, roof terraces, balconies and communal gardens as well as tenure and lease details cannot have their accuracy guaranteed for intending purchasers. Lease details, service ground rent (where applicable) are given as a guide only and should be checked and confirmed by your solicitor prior to exchange of contracts.

No person in the employment of Fenwicks Estates Ltd has any authority to make any representation or warranty whatever in relation to this property. Purchase prices, rents or other prices quoted are correct at the date of publication and, unless otherwise stated, exclusive of VAT.

**Data Protection:** We retain the copyright in all advertising material used to market this Property.

**Money Laundering Regulations 2017:** Intending purchasers will be required to produce identification documentation once an offer is accepted

Your home is at risk if you do not keep up repayments on mortgage or other secured loans.

### Portchester Office

92 West Street Portchester Hampshire PO16 9UQ

Tel: 02392 327 070 | E: [tiffany.porchester@fenwicks-estates.co.uk](mailto:tiffany.porchester@fenwicks-estates.co.uk)

[www.fenwicks-estates.co.uk](http://www.fenwicks-estates.co.uk)

