

Morton Close, E1

£2,200 Per calendar month

This spacious two double bedroom, two bathroom apartment is based within a quiet gated development. An ideal property for couple or professional sharers looking for short commute to the City or Canary Wharf.

The apartment is located on a quiet street just off Commercial Road and the property offers excellent access to both the City and Canary Wharf with Shadwell Station (DLR) only a short distance away.

Features

- Gated Development
- Two Double Bedrooms
- Two Bathrooms
- Open Plan
- Great Transport Links
- Communal Garden

Morton Close, London, E1

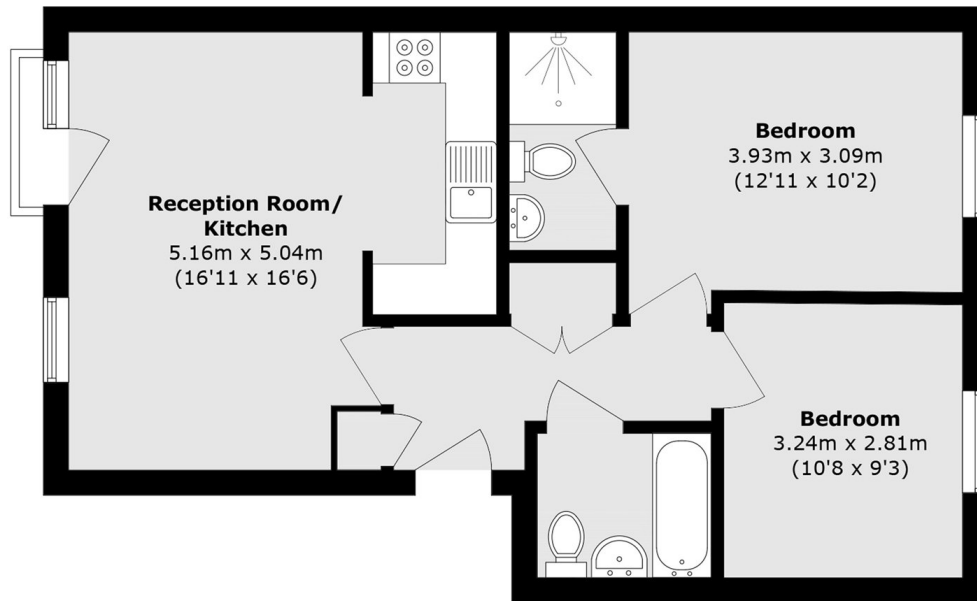

Total area (approx.): 60.6 sq. m (652.3 sq. ft)