



Colney Hatch Lane, N10

London

Guide Price

£400,000 - £425,000

This bright and well-proportioned two-bedroom first-floor apartment is situated on Colney Hatch Lane, just 0.2 miles from the heart of Muswell Hill Broadway. Flooded with natural light and offering a peaceful yet incredibly convenient setting, the flat benefits from an allocated off-street parking space to the front and access to a large communal garden to the rear.

The spacious reception room is bright with large windows, while the separate modern kitchen is practical and well-equipped. Both bedrooms feature French doors opening onto Juliette balconies with lovely views over the communal gardens. The apartment has wood effect parquet flooring throughout, with the bathroom finished in modern tiles.

Externally, the flat benefits from its allocated off-street parking space at the front, access to the large mainly lawned communal garden at the rear, and its own private shed – a lovely bonus for storage or gardening.





The location is excellent. Colney Hatch Lane is quietly positioned yet moments from the vibrant Muswell Hill Broadway, with its array of independent shops, cafés, restaurants, bars and boutiques literally on the doorstep. Alexandra Park and Highgate Wood are both easily accessible for walks and recreation, and there are excellent bus routes plus convenient access to Bounds Green and East Finchley Underground stations (Piccadilly Line). There is also an excellent mix of well-regarded primary and secondary schools close by.

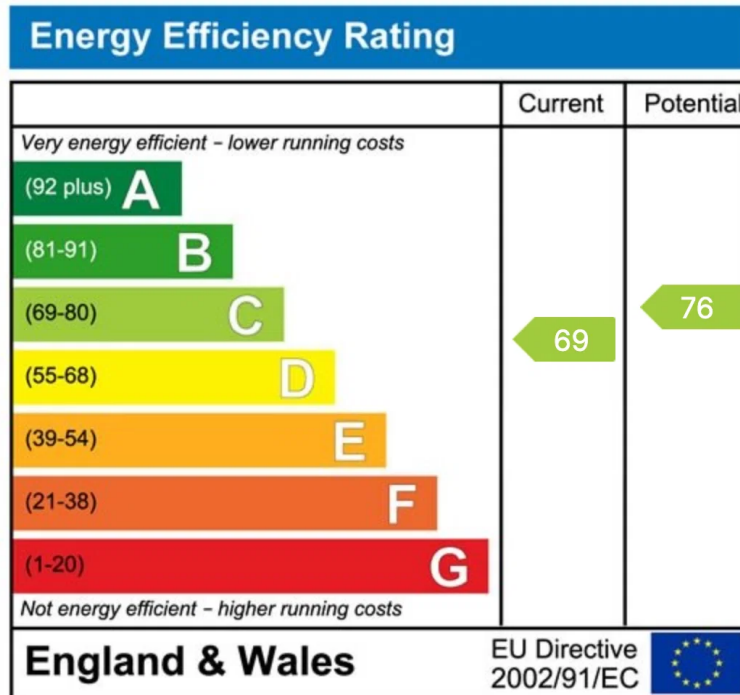

A bright, well-located two-bedroom flat with allocated parking and communal garden access in a prime N10 position – early viewing is highly recommended.

Please Quote Ref: AW1324

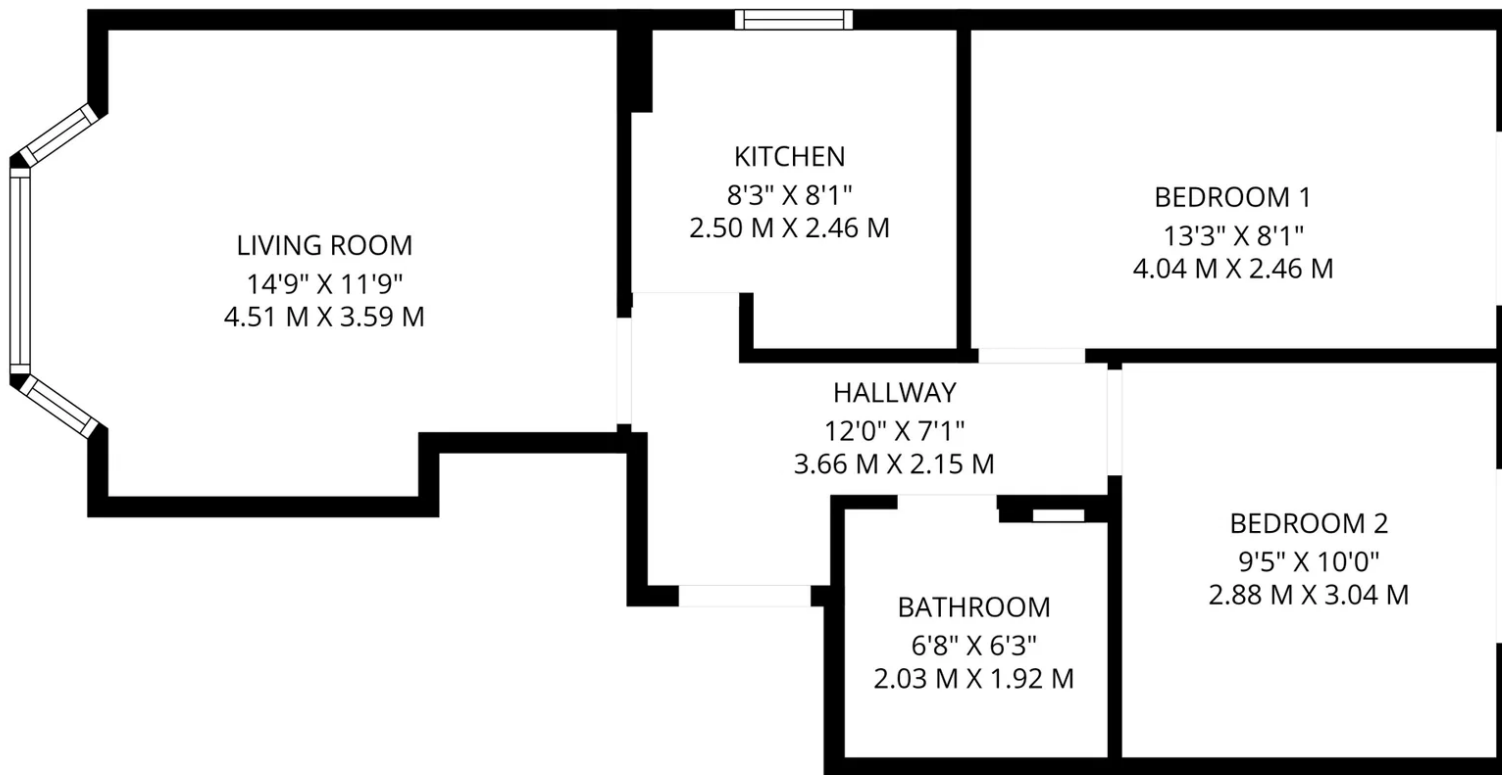

Total: 535 sq. Ft, 50 m2
Ground Floor: 535 sq. Ft, 50 m2
Excluded Areas: Walls: 57 sq. Ft, 5 m2

FLOOR PLAN CREATED BY CUBICASA APP. MEASUREMENTS DEEMED HIGHLY RELIABLE BUT NOT GUARANTEED.



Amanda Walker

07817 598 309

amanda.walker@expuk.com

<https://amandawalker.exp.uk.com>