



## Gloucester Street London, SW1V

**£2,200 Per month**

One double bedroom apartment situated on the raised ground floor of a beautiful period building on the popular and desirable area on the Pimlico Grid. Arranged over approx. 562 sq ft, the accommodation comprises of an entrance hallway, kitchen, spacious living/dining room, bathroom and a double bedroom. Benefits include original characterful features such as high ceilings, sash windows and an open fireplace. The property is available from mid-May and comes part-furnished.

Deposit: 5 weeks  
Council - Westminster  
Council Tax Band - F

### Viewing

Please contact our Intra Capital Estates Office on 0207 183 6676 if you wish to arrange a viewing appointment for this property or require further information.

- One Bedroom Apartment
- Raised Ground Floor
- Characterful Features
- Located on the Desirable Pimlico Grid
- Part Furnished
- Available Early May

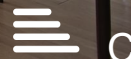

## Floor Plan

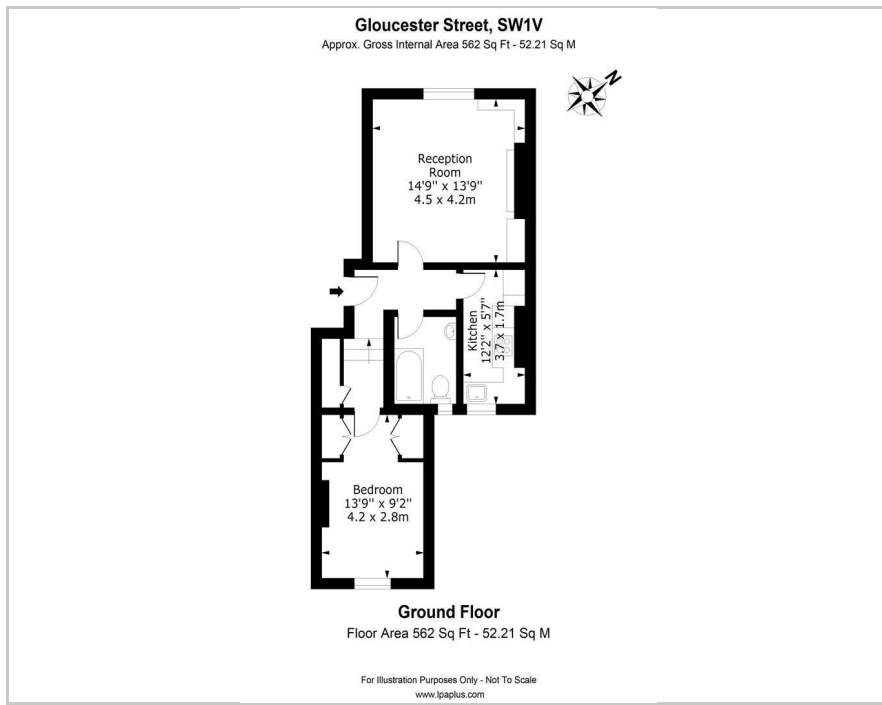

## Area Map



## Energy Efficiency Graph

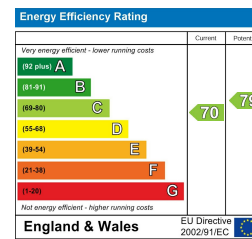

These particulars, whilst believed to be accurate are set out as a general outline only for guidance and do not constitute any part of an offer or contract. Intending purchasers should not rely on them as statements of representation of fact, but must satisfy themselves by inspection or otherwise as to their accuracy. No person in this firm's employment has the authority to make or give any representation or warranty in respect of the property.

## INTRA-CAPITAL ESTATES

Paddington Works, 8 Hermitage Street, London, W2 1BE

Tel: 0207 183 6676 Email: info@intra-capital.co.uk

www.intra-capital.co.uk

Intra-Capital Estates is a trading name of Intra Capital Estates Limited, a private limited company registered in England and Wales.  
Registered number: 11840427. VAT registration number: 31763281. Registered office Paddington Works, 8 Hermitage Street, London, W2 1BE.

## MODERN APPROACH TRADITIONAL VALUES

