



Charrington Tower

11 Biscayne Avenue, E14

Offers in Excess of £475,000

An exceptionally large 820sq ft West-facing 6th floor 1 bedroom apartment overlooking the communal gardens in Ballymore's Charrington Tower at New Providence Wharf. Offered chain-free.

CHESTERTONS



Charrington Tower

11 Biscayne Avenue, E14

- 820 sq ft 6th floor 1 bedroom apartment.
- Exceptional interior finish; views over communal gardens.
- Prestigious development with superior facilities.
- Transport & amenities nearby.
- Offered chain-free.



An exceptionally large 820sq ft West-facing 6th floor 1 bedroom apartment overlooking the communal gardens in Ballymore's Charrington Tower at New Providence Wharf. The apartment offers superior fixtures & fittings throughout.

Charrington Tower's facilities will include an athletic club & gym as well as a "hydro-centre" which will include a 25m swimming pool, kids' pool, hydro pool, sauna & steam room. Residents also benefit from a 24-hour concierge service & 24 hour site security.

Offered chain-free.

Tenure: Leasehold 983 years approx. remaining.

Service Charge: £6,663 pa approx.

Ground Rent: £500 pa

Local Authority: Tower Hamlets

Council Tax Band: D

Score	Energy rating	Current	Potential
92+	A		
81-91	B	81 B	81 B
69-80	C		
55-68	D		
39-54	E		
21-38	F		
1-20	G		

Chestertons Canary Wharf & Greenwich Sales

Harbour Island

28 Harbour Exchange Square

London

E14 9GE

canarywharf@chestertons.co.uk

020 7510 8300

chestertons.co.uk

Charrington Tower, Biscayne Avenue, E14

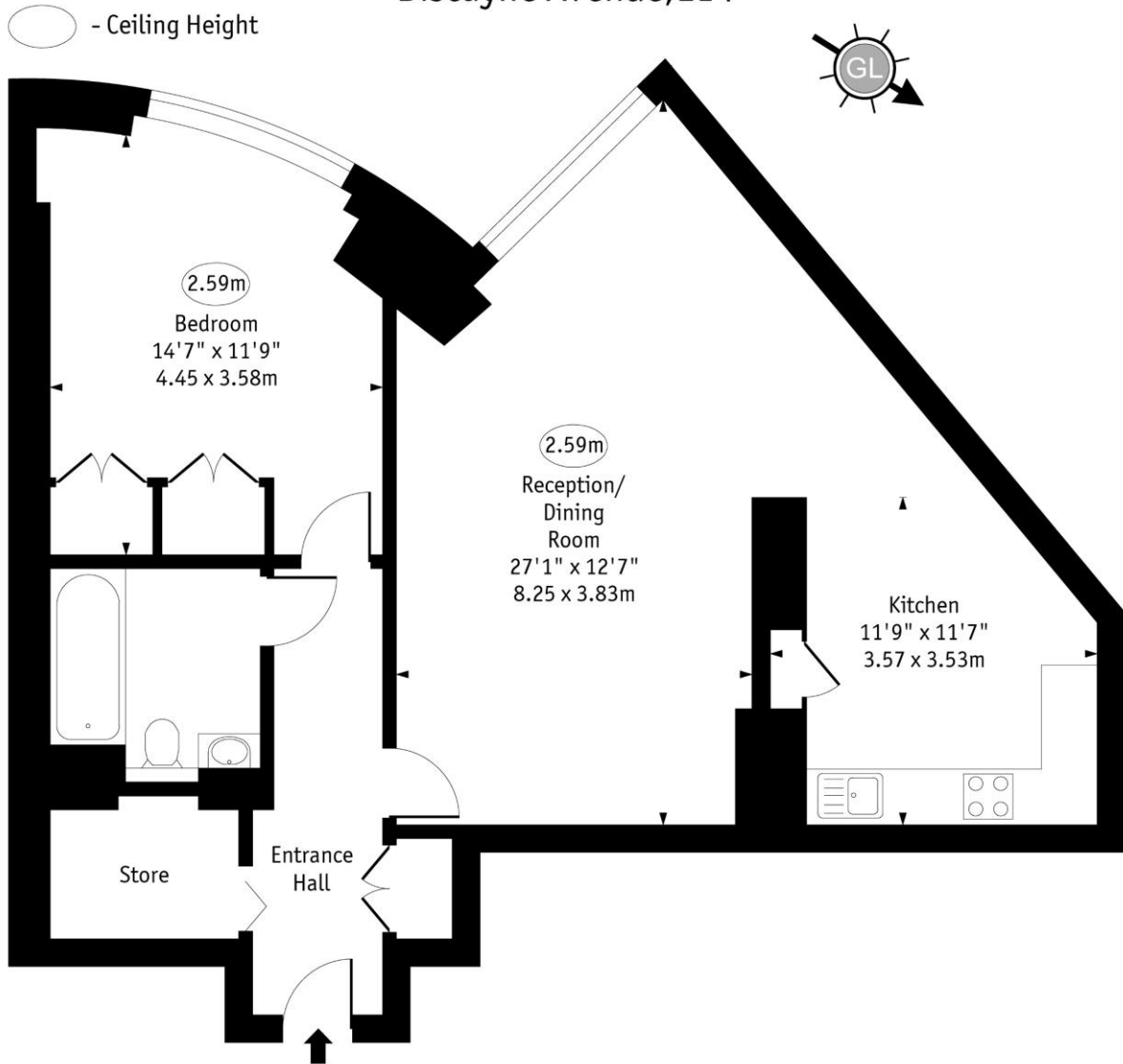

Sixth Floor

Approx Gross Internal Area 820 Sq Ft - 76.18 Sq M

Every attempt has been made to ensure the accuracy of the floor plan shown. However, all measurements, fixtures, fittings, and data shown are approximate interpretations and for illustrative purposes only. Measured according to the RICS. Not To Scale.

www.goldlens.co.uk
Ref. No. 030711JH

