

property details **approval form**

Flat 6 32 Chatsworth Road, Brighton, East Sussex, England, BN1 5DB

Date: 26 June 2026

Property Ref and Version: BHF114650 - 0002

selling your home with us!

Not for marketing purposes INTERNAL USE ONLY

>> **let's get your property sold!**

After visiting your property we have compiled this document to show you all of the information we have gathered, including all images. We just need you to review this document to make sure everything we say in here is accurate before we officially begin marketing your home.

What is covered in this marketing approval form:

1. Price
2. Key Features
3. Short Description
4. Long Description
5. Room Description
6. Property Images
7. Floor Plan

The information within this document will be used within our property particulars and on the internet; the format of how this information is displayed may be subject to change.

Your Fox & Sons office: 117-118 Western Road, BRIGHTON, East Sussex, BN1 2AD

T 01273 777000 **E** westernrd@fox-and-sons.co.uk

property details **approval form**

Flat 6 32 Chatsworth Road, Brighton, East Sussex, England, BN1 5DB

Date: 26 June 2026

Property Ref and Version: BHF114650 - 0002

>> **price**

£210,000

Tenure: Leasehold

This is a Leasehold property with details as follows; Term of Lease 999 years from 25 Dec 2001.

>> **key features**

- > One-bedroom apartment with approx. 348 sq. ft. of accommodation
- > Open-plan kitchen/living area ideal for modern living
- > Well-proportioned double bedroom
- > Practical bathroom and hallway layout
- > Close to transport links, shops, and amenities
- > EPC Rating: D

>> **short description**

This well-designed and efficiently proportioned one-bedroom apartment offers approximately 348 sq. ft. (32.3 sq. m.) of accommodation, making it an ideal purchase for first-time buyers, investors, or professionals seeking a low-maintenance home close to Brighton city centre.

The property is accessed

>> **long description**

This well-designed and efficiently proportioned one-bedroom apartment offers approximately 348 sq. ft. (32.3 sq. m.) of accommodation, making it an ideal purchase for first-time buyers, investors, or professionals seeking a low-maintenance home close to Brighton city centre.

The property is accessed via a central hallway, creating a practical layout with access to all rooms. The main living space is an impressive open-plan kitchen/reception room (17'4" x 11'0"), providing a bright and versatile area for cooking, dining, and relaxing. The kitchen is neatly arranged along one wall, maximising the usable living space and creating a sociable, modern environment.

Your Fox & Sons office: 117-118 Western Road, BRIGHTON, East Sussex, BN1 2AD

T 01273 777000 **E** westernrd@fox-and-sons.co.uk

property details **approval form**

Flat 6 32 Chatsworth Road, Brighton, East Sussex, England, BN1 5DB

Date: 26 June 2026

Property Ref and Version: BHF114650 - 0002

The double bedroom (9'11" x 8'8") is well-proportioned and offers a comfortable retreat with space for essential furnishings and storage. Adjacent to the bedroom is a bathroom (7'0" x 5'7"), fitted with a bath and essential fixtures, conveniently positioned off the hallway.

Overall, the apartment is thoughtfully arranged to maximise space and functionality, offering a well-balanced layout suited to modern city living.

property details approval form

Flat 6 32 Chatsworth Road, Brighton, East Sussex, England, BN1 5DB

Date: 26 June 2026

Property Ref and Version: BHF114650 - 0002

>> property images



Your Fox & Sons office: 117-118 Western Road, BRIGHTON, East Sussex, BN1 2AD
T 01273 777000 E westernrd@fox-and-sons.co.uk

property details **approval form**

Flat 6 32 Chatsworth Road, Brighton, East Sussex, England, BN1 5DB

Date: 26 June 2026

Property Ref and Version: BHF114650 - 0002

>> **property images**



property details **approval form**

Flat 6 32 Chatsworth Road, Brighton, East Sussex, England, BN1 5DB

Date: 26 June 2026

Property Ref and Version: BHF114650 - 0002

property details approval form

Flat 6 32 Chatsworth Road, Brighton, East Sussex, England, BN1 5DB

Date: 26 June 2026

Property Ref and Version: BHF114650 - 0002

>> floor plan

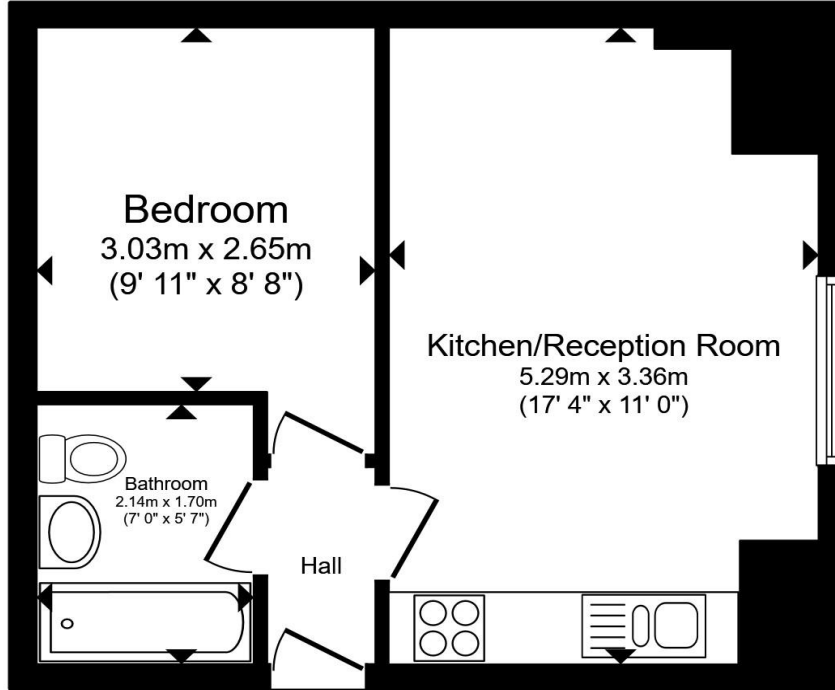

Total floor area 32.3 m² (348 sq.ft.) approx

This floor plan is for illustrative purposes only. It is not drawn to scale. Any measurements, floor areas (including any total floor area), openings and orientation are approximate. No details are guaranteed, they cannot be relied upon for any purpose and they do not form part of any agreement. No liability is taken for any error, omission or misstatement. A party must rely upon its own inspection(s). Powered by www.propertybox.io



>> approval

Signature

Date

	Signature	Date
Ben Heasman		
Stuart Heath Echidna Ltd		

Your Fox & Sons office: 117-118 Western Road, BRIGHTON, East Sussex, BN1 2AD

T 01273 777000 **E** westernrd@fox-and-sons.co.uk