

Bishop Burton Road, Cherry Burton, Beverley, HU17 7RW

£365,000

3 2 2



REFERENCE BA0665 If you are looking for a modern and energy efficient home in a very pleasant non estate location then this home, built by Peter Ward Homes in 2020, could be the ideal property for you. With the added advantage of no onward chain, my client can facilitate a quick move, if so required. Accommodation is well proportioned and offers three bedrooms to the first floor with an en-suite shower room and family bathroom. The ground floor comprises a lounge, live in kitchen/dining room, utility and cloakroom. Outside the rear garden is very generous in its size and is of a westerly aspect with the front driveway comfortably providing parking for four vehicles. In addition to the gas fired central heating system and double glazing the property also benefits from air-conditioning and a security system.

- Lounge
- Utility Room
- Three bedrooms
- Gas Fired CH/Double Glazing/Air Conditioning
- Driveway Parking For Multiple vehicles
- Live in Kitchen/Dining Room
- Cloakroom
- En Suite Shower/ Family Bathroom
- Good Sized West Facing Rear Garden
- Garage

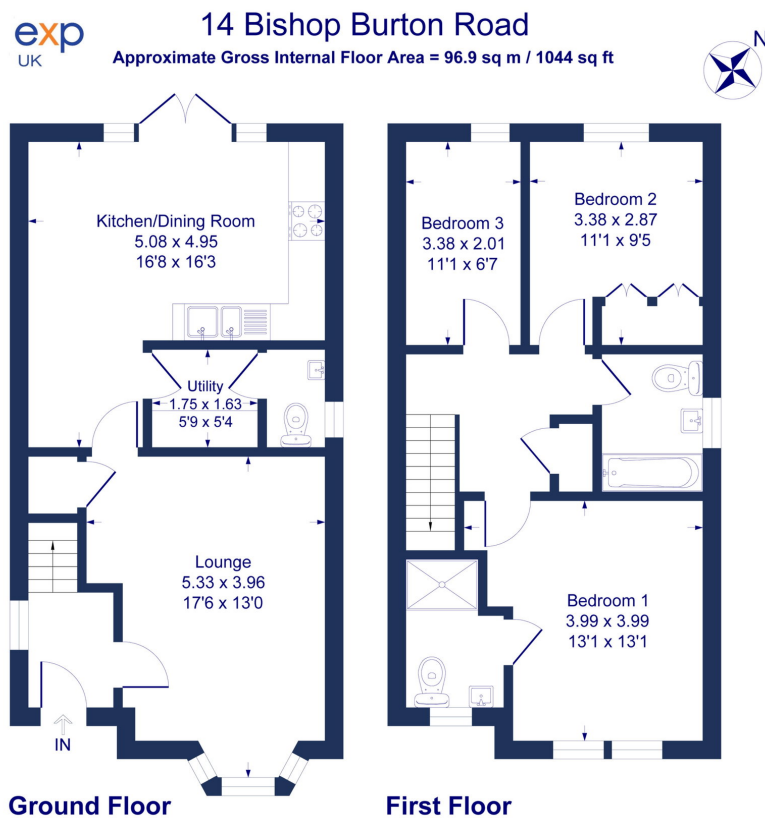

Illustration for identification purposes only, measurements are approximate, not to scale.