



## Kings Grove, SE15

£975,000

A substantial period house arranged over three floors, offering generous internal space, a truly impressive rear garden and excellent potential to extend and reconfigure, subject to the usual planning consents.

Kings Grove is a quiet residential street well placed for the open spaces of Peckham Rye and the amenities of Bellenden Road, with excellent transport links nearby including Peckham Rye and Queens Road stations.

### Features

- Three Double Bedrooms
- Two Receptions
- Glorious East Facing Garden
- No Trough Road
- Potential To Extend STPP
- Close To Queen's Road
- Peckham Station

# Kings Grove, London, SE15

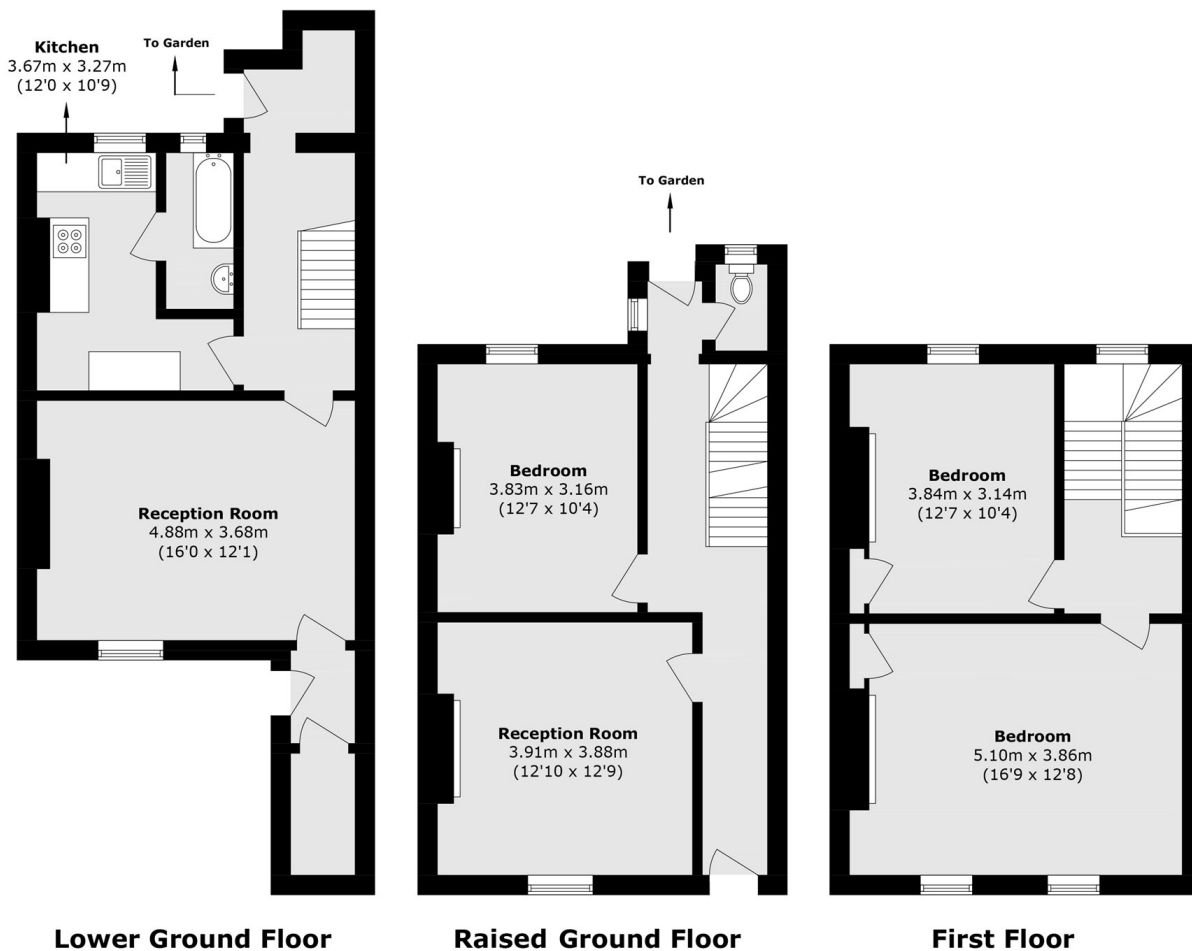

Total area (approx.): 124.9 sq. m (1344.4 sq. ft)