



## ST. JOHNS WOOD ROAD, NW8

£800,000

Set on the upper floor of a well-maintained building with lift access, this fantastic two-bedroom apartment offers a spacious and versatile living space.

Lift access  
Secure Covered Parking Space

Two bedrooms  
Balcony

@marshandparsons  
marshandparsons.co.uk

MARSH &  
PARSONS

# STEP INSIDE ST. JOHNS WOOD ROAD

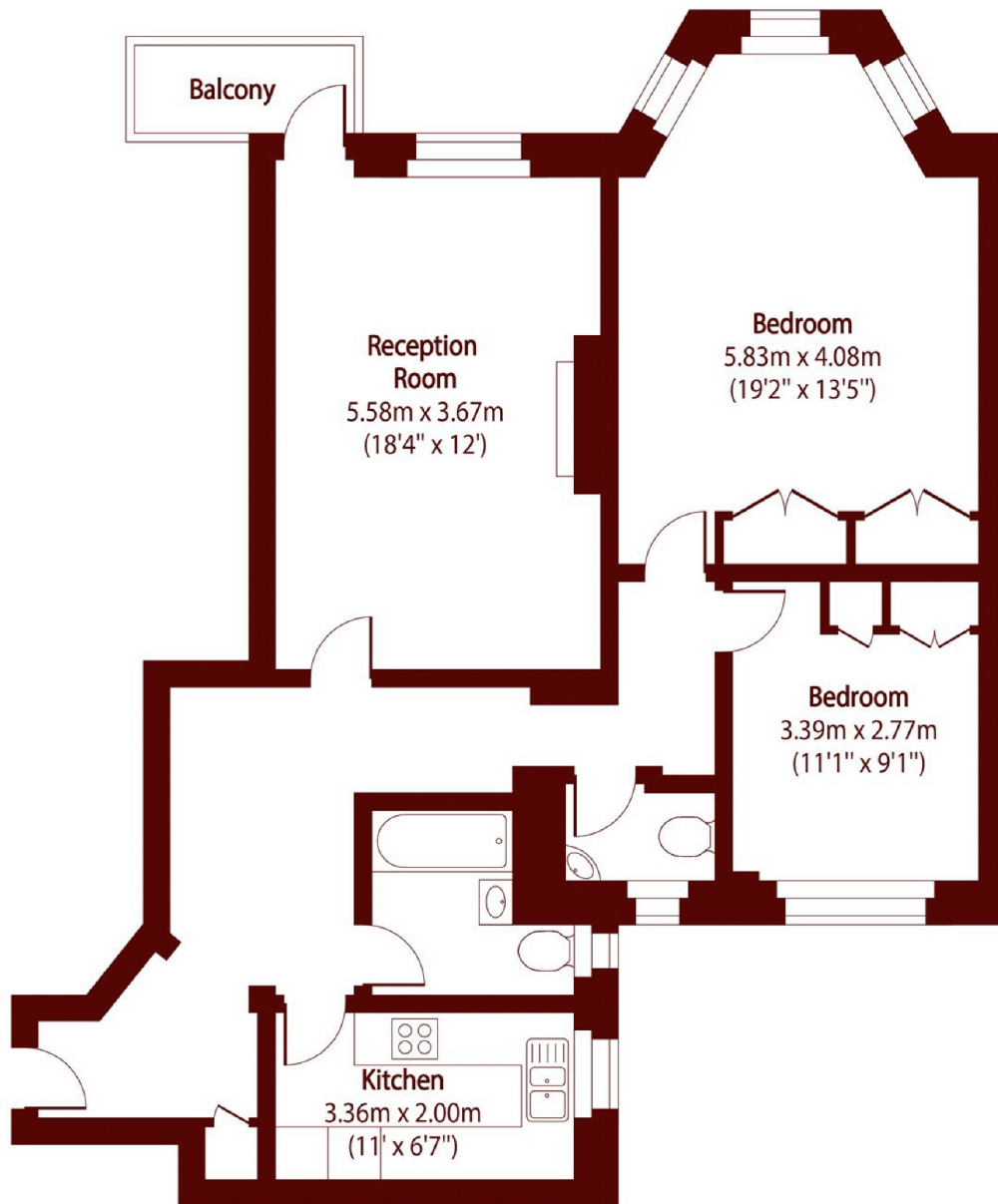

Total area (approx): 87.55 sq m (942 sq. ft)

Patio/Balcony/Terrace total area (approx): 2.50 sq m (27 sq. ft)

**Little Venice**  
020 7993 3050

Energy Rating: C We aim to make our particulars both accurate and reliable. However, they are not guaranteed; nor do they form part of an offer or contract. If you require clarification on any points then please contact us, especially if you're traveling some distance to view. Please note that appliances and heating systems have not been tested and therefore no warranties can be given as to their good working order

**MARSH &  
PARSONS**