



BRUTON
— PROPERTY —

3 Wood Crescent Television Centre
London, W12 7GN

£2,850 Per month



3 Wood Crescent Television Centre

London, W12 7GN

Stylish One-Bedroom 3rd Floor Luxury Apartment with Balcony in the Prestigious Television Centre, W12, featuring SOHO House gym access, pool, spa, residents lounge and 24-hour concierge.

A beautifully finished unfurnished apartment in the Television Centre development in White City. The apartment offers a sleek, modern aesthetic with solid wooden flooring, air conditioning, and a spacious open-plan living and dining area, enhanced by sliding glass doors opening onto a private balcony. Views over Hammersmith Park.

The principal bedroom suite features a walk-in wardrobe and a stylish en-suite bathroom, providing excellent storage and comfort. The bespoke kitchen is fitted with high-quality Siemens appliances, ideal for contemporary city living.

Residents benefit from exclusive access to the SOHO House gym, swimming pool and spa, with two complimentary membership passes included. Additional amenities include a 24-hour concierge, private cinema, and a residents' lounge opening onto beautifully Japanese-landscaped gardens.

Set within one of London's most exciting neighbourhoods, Television Centre seamlessly blends heritage architecture with modern design and is home to working TV studios, independent restaurants and an





art-house cinema. White City and Wood Lane Underground stations are moments away, offering excellent transport connections across London.

Key Features:

Open-plan living area with sliding glass door to private balcony

Bedroom with walk-in wardrobe and en-suite

Solid wood flooring and air conditioning throughout

Access to SOHO House gym, pool and spa (two passes included)

24-hour concierge, private cinema and residents' lounge

Unfurnished

EPC Rating: B

Council: Hammersmith & Fulham

Council Tax Band: E (2026/27):

£1,773.95 per annum



Floor Plan

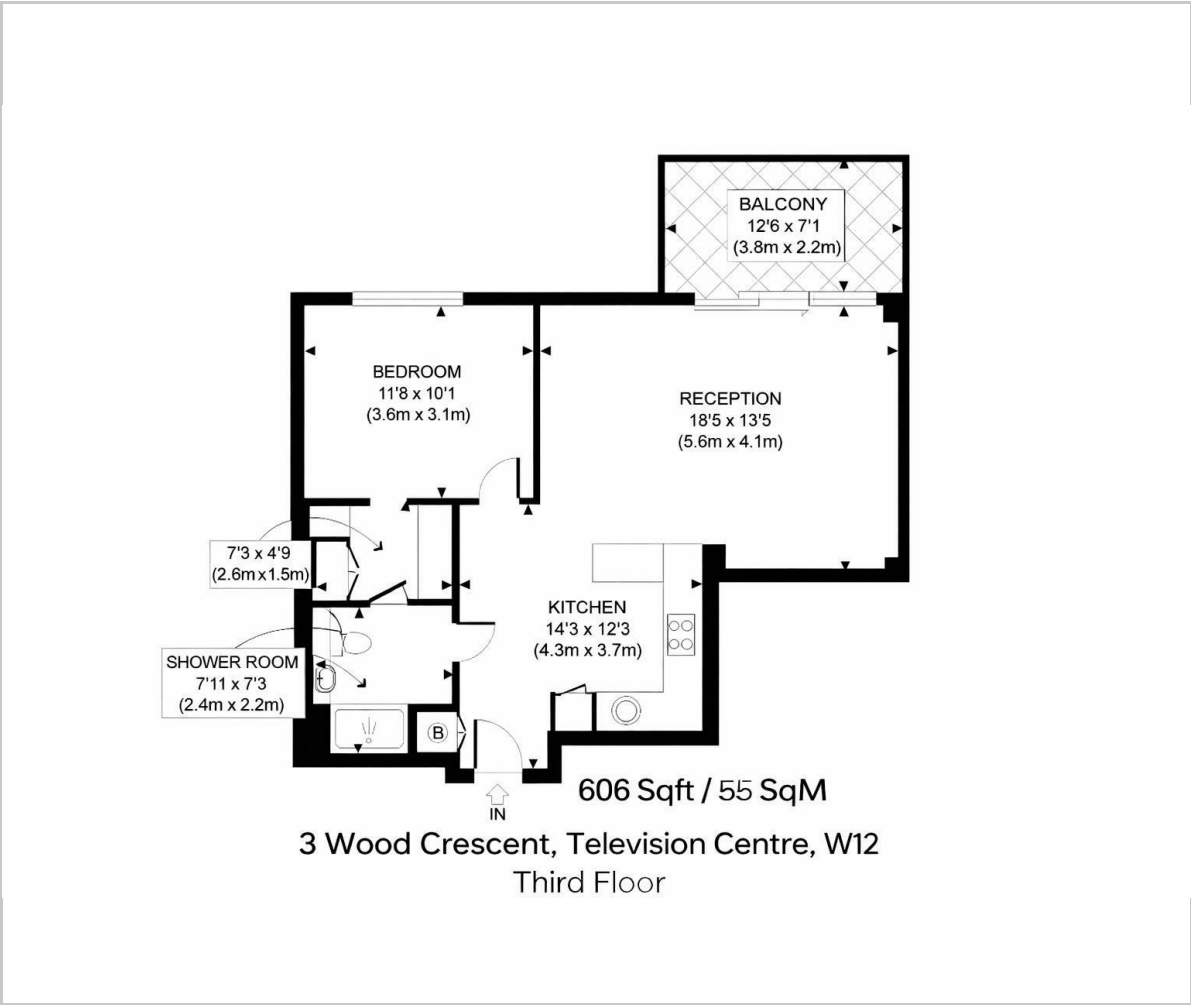

Viewing

Please contact our Bruton Property Office on 0207 459 4696 if you wish to arrange a viewing appointment for this property or require further information.

These particulars, whilst believed to be accurate are set out as a general outline only for guidance and do not constitute any part of an offer or contract. Intending purchasers should not rely on them as statements of representation of fact, but must satisfy themselves by inspection or otherwise as to their accuracy. No person in this firms employment has the authority to make or give any representation or warranty in respect of the property.

 **20 Lees Place, Mayfair**
London, W1K 6LP

 **020 7459 4696**

 **info@brutonproperty.co.uk**
www.brutonproperty.co.uk

Area Map

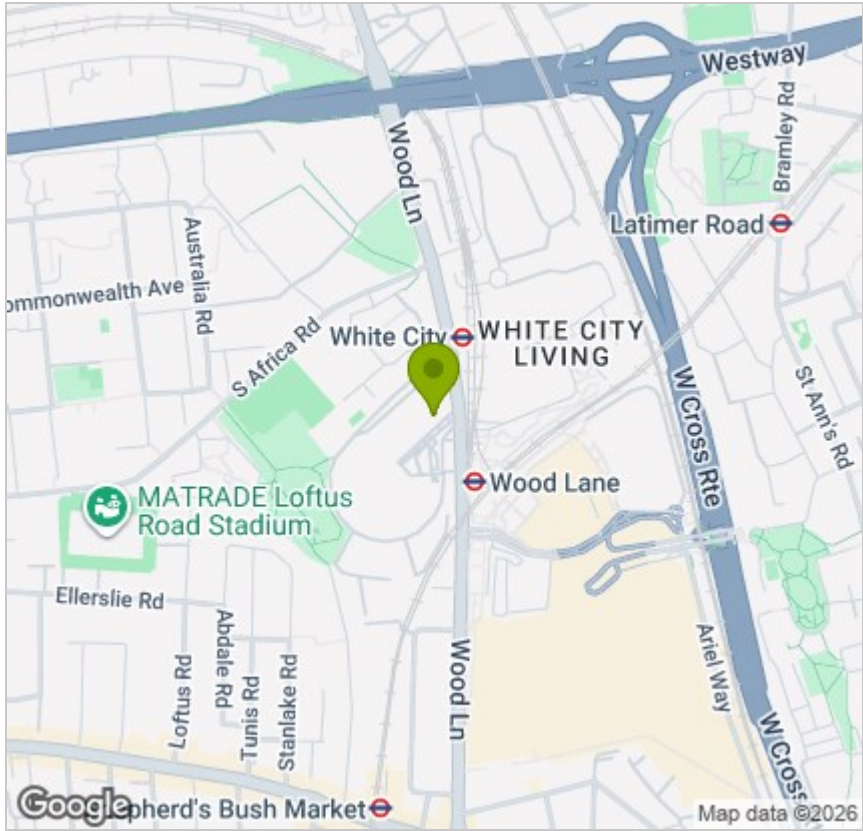

Energy Efficiency Graph

