



Connells

Millwood Nelson Avenue
Minster On Sea Sheerness

Millwood Nelson Avenue Minster On Sea Sheerness ME12 3SF

for sale offers over
£525,000



Property Description

This impressive and well-maintained four double bedroom detached property offers a wealth of space and versatility, making it an ideal family home. The ground floor features a generous front lounge that flows seamlessly into a separate dining room, along with a modern kitchen fitted just three years ago and equipped with all essential appliances. A convenient downstairs WC adds further practicality.

To the rear, the property boasts two conservatories, providing flexible additional living space and direct access to the large, secluded rear garden.

Upstairs, the stylish family bathroom serves four well-proportioned double bedrooms, with the master benefitting from its own en-suite shower cubicle.

Further advantages include a large garage with workshop and pantry, as well as a driveway offering ample parking for multiple vehicles.

Situated on the sought-after Nelson Avenue in Minster on Sea, the property enjoys excellent access to the A249 and local

amenities.

Cloakroom

10' x 3' 3" (3.05m x 0.99m)

Lounge

20' 6" x 13' 5" (6.25m x 4.09m)

Dining Room

11' 9" x 10' (3.58m x 3.05m)

Kitchen

13' 8" x 11' 9" (4.17m x 3.58m)

Conservatory

11' x 9' 5" (3.35m x 2.87m)

Conservatory Two

15' 3" x 10' 7" (4.65m x 3.23m)

Bedroom 1

17' 7" x 14' 2" (5.36m x 4.32m)

Bedroom 2

12' 9" x 11' 2" (3.89m x 3.40m)

Bedroom 3

11' 6" x 11' 4" (3.51m x 3.45m)

Bedroom 4

14' 2" x 8' (4.32m x 2.44m)

Bathroom







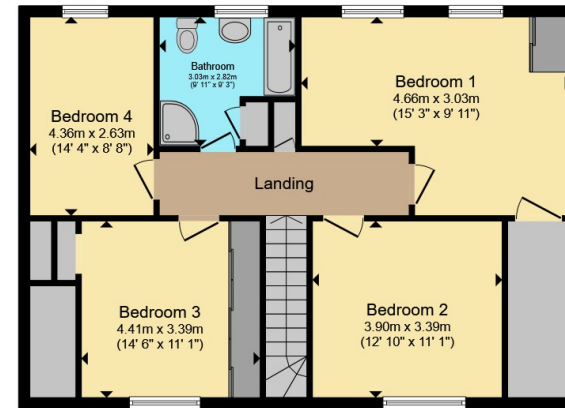

Ground Floor

First Floor

Total floor area 187.6 m² (2,019 sq.ft.) approx

This floor plan is for illustrative purposes only. It is not drawn to scale. Any measurements, floor areas (including any total floor area), openings and orientation are approximate. No details are guaranteed, they cannot be relied upon for any purpose and they do not form part of any agreement. No liability is taken for any error, omission or misstatement. A party must rely upon its own inspection(s). Powered by www.propertybox.io



To view this property please contact Connells on

T 01795 477859
E sittingbourne@connells.co.uk

68 High Street
 SITTINGBOURNE ME10 4PB

EPC Rating: D Council Tax
 Band: C

Tenure: Freehold

view this property online connells.co.uk/Property/SIT103922



1. MONEY LAUNDERING REGULATIONS Intending purchasers will be asked to produce identification documentation at a later stage and we would ask for your co-operation in order that there will be no delay in agreeing the sale. 2. These particulars do not constitute part or all of an offer or contract. 3. The measurements indicated are supplied for guidance only and as such must be considered incorrect. Potential buyers are advised to recheck measurements before committing to any expense. 4. We have not tested any apparatus, equipment, fixtures, fittings or services and it is in the buyers interest to check the working condition of any appliances.

Connells Residential is registered in England and Wales under company number 1489613, Registered Office is Cumbria House, 16-20 Hockliffe Street, Leighton Buzzard, Bedfordshire, LU7 1GN. VAT Registration Number is 500 2481 05.

See all our properties at www.connells.co.uk | www.rightmove.co.uk | www.zoopla.co.uk

Property Ref: SIT103922 - 0008