





3, Ashbourne Mews, Cheshire, SK10 3RR

Spacious two-bedroom end mews house offering attractive accommodation in a convenient location close to the hospital, local schools, and shops. The property includes a living room, dining kitchen, conservatory, two double bedrooms, and a newly renovated bathroom. Outside there is an attractive rear yard and a driveway providing parking for two vehicles.

Key Features

- Spacious end mews house
- Two double bedrooms
- Dining kitchen
- Conservatory
- Newly renovated bathroom
- Driveway with parking for two vehicles
- Attractive rear yard
- Close to hospital, local schools, and shops

Available immediately and offered part furnished with fridge, freezer, washing machine and cooker. Tax band C. EPC C. No pets. £100 Holding Deposit to be paid within 24 hours of an offer being accepted.

Viewings by appointment via Holden & Prescott.

Location:

SK10 3RR, Ashbourne Mews. Located on the left hand side.

Proceed out of Macclesfield along Cumberland Street bearing right at the roundabout into Prestbury Road and left into Victoria Road. At the next roundabout turn left into Eldon Road and then first left into Ashbourne Mews and the property can be found on the left hand side.

Viewing: By appointment with Holden and Prescott 01625 422244

Entrance Vestibule

Living Room

13'6 x 13

Dining Kitchen

13'6 x 8

Conservatory

8'10 x 8'1

Bedroom One

13'6 x 11'4

Bedroom Two

9'9 x 7'10

Bathroom

£1,000 PCM

HOLDEN & PRESCOTT

Ground Floor

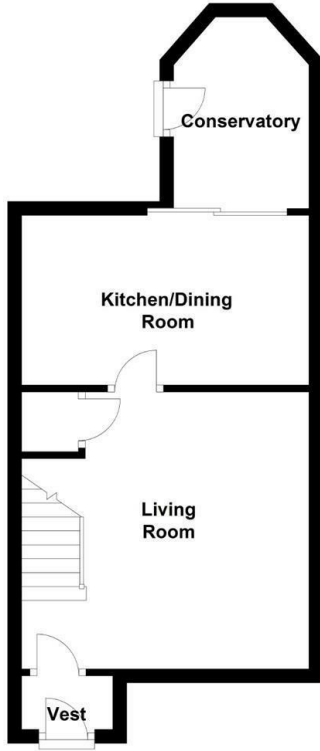

First Floor

