



## Acacia Road, SW16

£450,000

A ground-floor garden flat with three bedrooms and two bathrooms. This large maisonette apartment benefits from a brand new 999-year lease as well as a share of the freehold. There is a high specification throughout, including German Kitchens, appliances and underfloor heating in the bathrooms.

Lilium House is a boutique development tucked nicely away from the hustle and bustle of the main road but within convenient walking distance to shops, bars, restaurants and cafes as well as with extremely easy access to Norbury Station. The green open spaces of Norbury Park are just across the road, with Streatham Common also just a short walk away.

### Features

- Three Double Bedrooms
- Two Bathrooms
- Ground Floor Garden Flat
- Maisonette Apartment
- Share Of The Freehold
- High Specification
- Own Front Door
- German Kitchen + Appliances
- New Homes 10 Year Warranty

# Acacia Road, Streatham, SW16

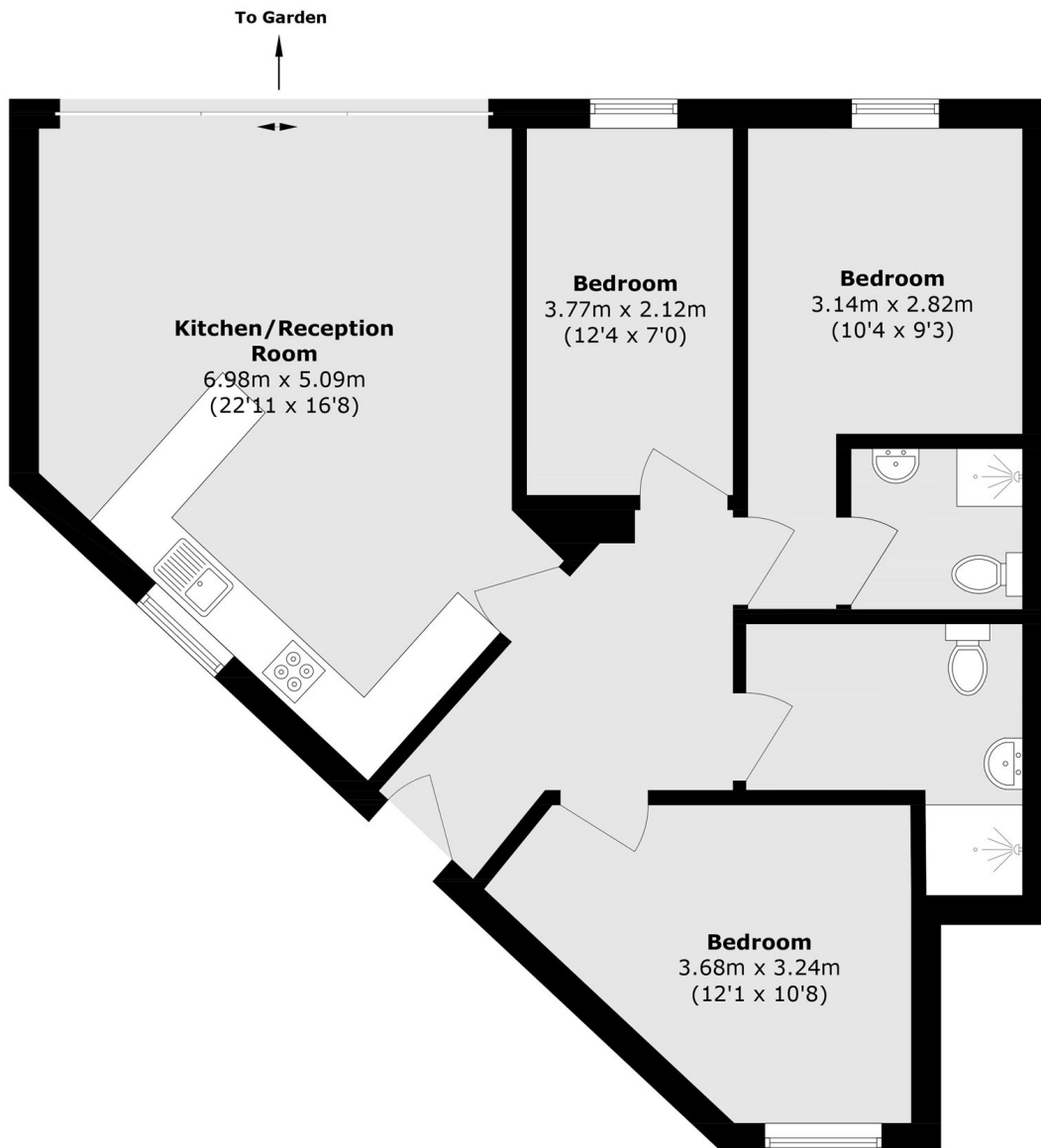

Total area (approx.): 78.6 sq. m ( 846.0 sq. ft)