



Barclay Close, SW6

£425,000

A fully renovated third-floor flat benefiting from lift access, this two-bedroom apartment is presented in immaculate condition throughout. The property features a modern, fully fitted integrated kitchen, open plan to a bright and spacious reception room, with direct access to a private balcony.

Enviably located between Parsons Green and Fulham Broadway, the property benefits from an excellent range of amenities and transport links on its doorstep. It is also ideally positioned to take advantage of a wide variety of shops, restaurants, bars, and boutiques right on its doorstep.

Features

- Two Bedrooms
- Fully Renovated Throughout
- Open Plan Kitchen Living
- Private Balcony
- Sold Chain Free
- Benefits From Lift Access

Barclay Close, London, SW6

Third Floor

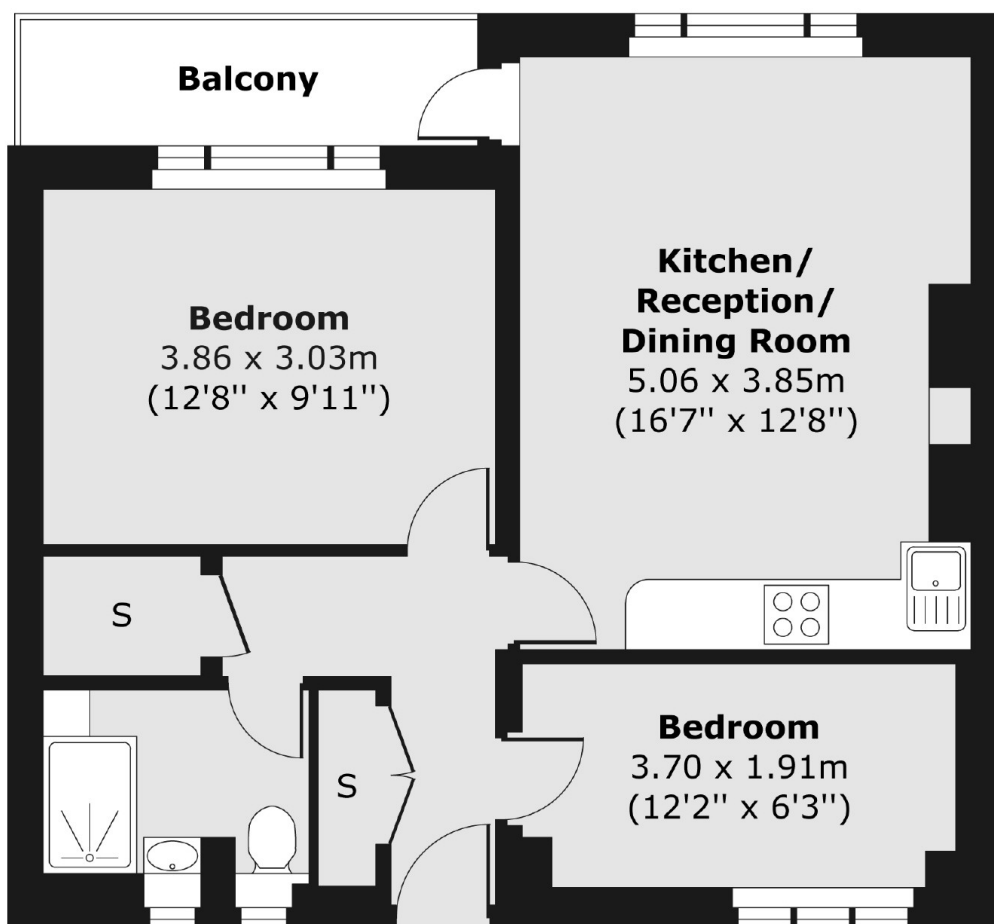

Total area (approx.) 51.17 sq. m (551 sq. ft)
Balcony area (approx.) 4.21 sq. m (45 sq. ft)