



*Jordan fishwick*

**DIDSBURY VILLAGE**  
Lidgate Grove



## Lidgate Grove, Didsbury Village, M20 6TS

£425,000



### The Property

An exciting opportunity to purchase a rare, garden fronted terrace hidden away in the centre of Didsbury Village. Lidgate Grove is a small row of terrace houses with the most phenomenal gardens to the front, with entrances to the front and rear via private courtyards. This property is in the original layout with the small addition of a uPVC conservatory/rear lobby. In brief comprising: Covered porch, lounge with sliding doors to the dining room, kitchen, utility room/study and a rear lobby. Upstairs in its original configuration there are two bedrooms where one leads to the other and a large bathroom. The property features uPVC double glazing throughout and is warmed by gas central heating. NO ONWARD CHAIN.

### Directions

M20 6TS



- Delightful terrace cottage
- Secluded village location
- Garden extending to 100ft
- Open plan living space
- Two double bedrooms
- Enclosed rear courtyard
- uPVC double glazing
- No onward chain

**Postcode** - M20 6TS

**EPC Rating** - C

**Floor Area** - 930.00 sq ft

**Local Authority** - Manchester City Council

**Council Tax** - D



GROUND FLOOR  
552 sq.ft. (51.3 sq.m.) approx.

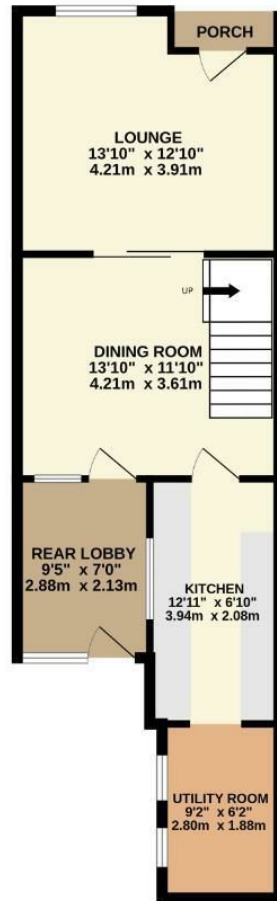

1ST FLOOR  
379 sq.ft. (35.2 sq.m.) approx.

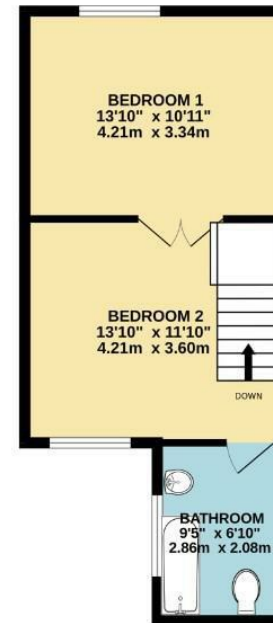

TOTAL FLOOR AREA: 930 sq.ft. (86.4 sq.m.) approx.  
Measurements are approximate. Not to scale. Illustrative purposes only.  
Made with Metropix ©2025



These particulars are believed to be accurate but they are not guaranteed and do not form a contract. Neither Jordan Fishwick nor the vendor or lessor accept any responsibility in respect of these particulars, which are not intended to be statements or representations of fact and any intending purchaser or lessee must satisfy himself by inspection or otherwise as to the correctness of each of the statements contained in these particulars. Any floorplans on this brochure are for illustrative purposes only and are not necessarily to scale.

Offices also at: Wilmslow, Macclesfield, Hale, Sale, Chorlton, Glossop, Manchester & Salford

757-759 Wilmslow Road, Didsbury Village, Manchester

0161 445 4480

didsbury@jordanfishwick.co.uk  
www.jordanfishwick.co.uk