

# HUNTERS<sup>®</sup>

HERE TO GET *you* THERE



## Elmfield North

Millbrook Road East, Southampton, SO15 1HZ

£1,050 Per Calendar Month



Located just a short distance from Southampton city centre, the building is a private hidden oasis in almost three acres behind secure electric gates, only minutes from the central railway station giving excellent access to London Waterloo.

This spacious first floor one bedroom apartment with an open plan lounge and kitchen/dining area with views overlooking the scenic and well maintained communal gardens. The property also benefits from a modern bathroom, a walk in storage and complemented with communal parking and communal grounds.



## Area Map



## Floor Plans

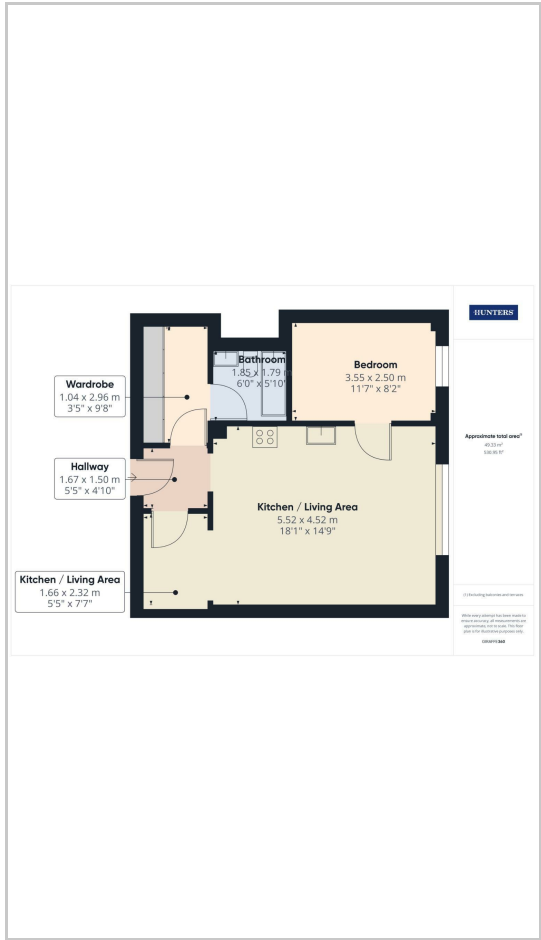

## Energy Efficiency Graph

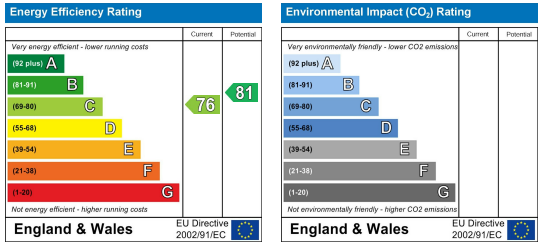

These particulars are intended to give a fair and reliable description of the property but no responsibility for any inaccuracy or error can be accepted and do not constitute an offer or contract. We have not tested any services or appliances (including central heating if fitted) referred to in these particulars and the purchasers are advised to satisfy themselves as to the working order and condition. If a property is unoccupied at any time there may be reconnection charges for any switched off/disconnected or drained services or appliances - All measurements are approximate. **THINKING OF SELLING?** If you are thinking of selling your home or just curious to discover the value of your property, Hunters would be pleased to provide free, no obligation sales and marketing advice. Even if your home is outside the area covered by our local offices we can arrange a Market Appraisal through our national network of Hunters estate agents.