



Latton Green, Harlow, CM18 7EP  
£450,000





# Latton Green, Harlow, CM18 7EP

Located in the popular family area of Latton Green, is this well presented three bedroom semi detached family home with a driveway, garage and huge rear garden. on the ground floor there is a large hallway leading to an open plan lounge and dining room and a modern kitchen with a range of fitted wall and base units, whilst upstairs there are three bedrooms and a family bathroom with a white three piece suite. Outside the large rear garden is mainly lair to lawn with a patio area, shed and side access leading out to the garage and driveway. Latton Green is located just off Commonsides Road, within walking distance of excellent local schools, shops, Latton Common and the M11 junction close by.

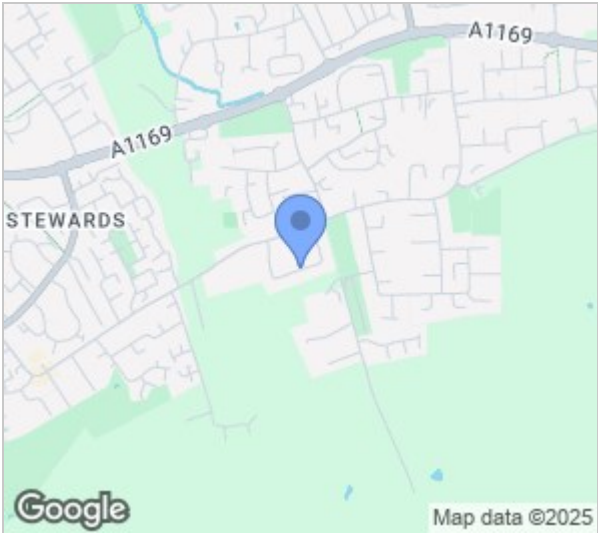
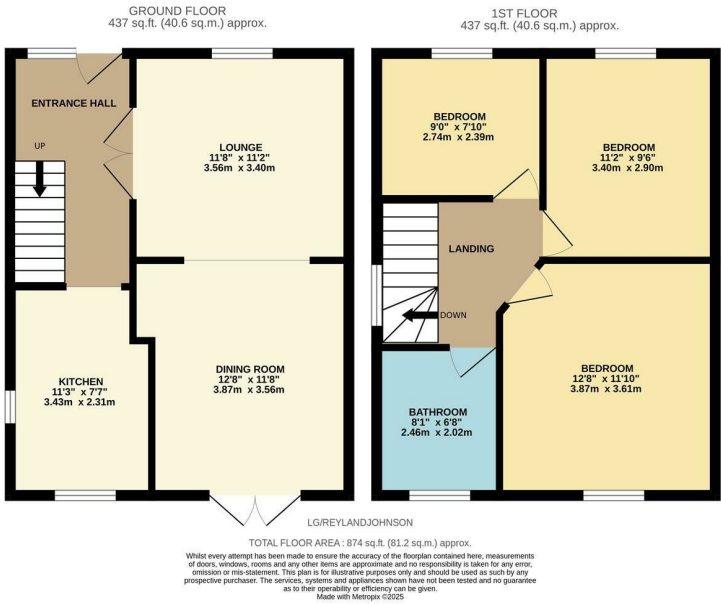

Energy Efficiency Rating			Environmental Impact (CO <sub>2</sub> ) Rating		
	Current	Potential		Current	Potential
Very energy efficient - lower running costs			Very environmentally friendly - lower CO <sub>2</sub> emissions		
(92 plus) A			(92 plus) A		
(81-91) B			(81-91) B		
(69-80) C			(69-80) C		
(55-68) D			(55-68) D		
(39-54) E			(39-54) E		
(21-38) F			(21-38) F		
(1-20) G			(1-20) G		
Not energy efficient - higher running costs			Not environmentally friendly - higher CO <sub>2</sub> emissions		
England & Wales			England & Wales		
EU Directive 2002/91/EC			EU Directive 2002/91/EC		

These particulars, whilst believed to be accurate are set out as a general outline only for guidance and do not constitute any part of an offer or contract. Intending purchasers should not rely on them as statements of representation of fact, but must satisfy themselves by inspection or otherwise as to their accuracy. No person in this firms employment has the authority to make or give any representation or warranty in respect of the property.