



HEMMINGS HOMES

FIXED ASKING PRICE

£373,995

Watanabe Road

, EH30 9SP

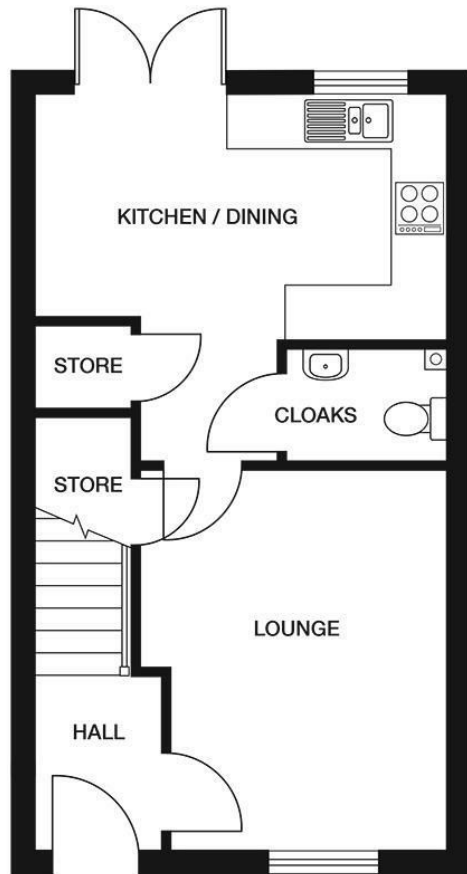

Energy Efficiency Rating		Current	Potential
Very energy efficient - lower running costs			
(92 plus)	A	91	
(81-91)	B		
(69-80)	C		
(55-68)	D		
(39-54)	E		
(21-38)	F		
(1-20)	G		
Not energy efficient - higher running costs			
Scotland		EU Directive 2002/91/EC	

Agents Note: Whilst every care has been taken to prepare these particulars, they are for guidance purposes only. All measurements are approximate and are for general guidance purposes only and whilst every care has been taken to ensure their accuracy, they should not be relied upon and potential buyers/tenants are advised to recheck the measurements



OFFICE ADDRESS
 8 Deer Park Avenue
 Livingston
 EH48 8AF

OFFICE DETAILS
 01506 532422
 enquiries@hemmingshomes.co.uk
 hemmingshomes.co.uk